

**FIRST FLOOR PUBLIC ASSEMBLY PLAN**  
SCALE: 1/4"=1'-0"

NOTE:  
ALL EMERGENCY LIGHTING SHALL BE CONNECTED TO SEPARATE EMERGENCY LIGHTING POWER SOURCE, AND BE ARRANGED TO OPERATE AUTOMATICALLY IN THE EVENT OF FAILURE TO NORMAL LIGHTING SYSTEM.

AS PER NYCBC 27-531(a)(5) TABLE AND CHAIR SEATING: TABLES AND CHAIRS SHALL BE SO ARRANGED THAT THE DISTANCE FROM ANY CHAIR AT ANY TABLE BY WAY OF A PATH BETWEEN TABLES AND CHAIRS IS NOT GREATER THAN EIGHTEEN FEET TO AN AISLE LEADING TO EXIT. THE WIDTH OF THE PATH SHALL BE AT LEAST EIGHTEEN INCHES, EXCEPT THAT IT MAY BE REDUCED BY ONE INCH FOR EACH ONE FOOT THAT THE DISTANCE TO THE AISLE IS LESS THAN EIGHTEEN FEET BUT MAY NOT BE REDUCED TO LESS THAN TWELVE INCHES. CHAIRS, WHEN PLACED WITH THE FRONT EDGE OF THE SEAT ON A LINE WITH THE EDGE OF THE TABLE, SHALL NOT PROTRUDE INTO THE PATH. BOOTHS CONTAINING UP TO EIGHT SEATS MAY BE USED, PROVIDED THEY OPEN DIRECTLY ON AN AISLE.

AS PER NYCBC 27-533(a)(3): NOT MORE THAN THREE CHANGES IN DIRECTION OF TRAVEL SHALL BE PERMITTED IN THE PATH OF TRAVEL TO AN EXIT OPENING. CHANGE IN DIRECTION SHALL BE DEEMED TO OCCUR WHEN IT IS NECESSARY TO CHANGE DIRECTION BY A FORTY-FIVE DEGREES OR GREATER ANGLE MEASURED FROM THE PRECEDING LINE OF TRAVEL, EXCEPT THAT IT SHALL NOT BE CONSIDERED AS A CHANGE IN DIRECTION WHEN IT IS NECESSARY IN AN AISLE TO TRAVEL IN ANOTHER DIRECTION NOT MORE THAN SEVEN FEET.

AS PER NYCBC 27-533 COMMON PATH OF TRAVEL: THE FIRST 35'-0" OF A PRIMARY AND SECONDARY PATH OF TRAVEL MAY BE COMMON TO ONE ANOTHER.

NOTE:  
ALL EMERGENCY LIGHTS ARE PROVIDED WITH BATTERY BACK-UP POWER AND ARE LOCATED 25'-0" DISTANT OR LESS FROM ONE ANOTHER.

AS PER EMERGENCY LIGHTING MEMO - 2/19/1981: ALL EMERGENCY LIGHTING SHALL BE INSTALLED AT MINIMUM 8'-0" TO UNDERSIDE OF EMERGENCY LIGHT. ALL EMERGENCY LIGHTS, WHETHER CEILING MOUNTED OR MOUNTED OVER AN EXIT SHALL DIRECT LIGHT TOWARDS EXIT DOOR.

NOTE:  
AS NYCBC TABLE 5-2, PROPOSED PUBLIC SPACES HAVE 2 HOUR RATED SEPARATION FROM OTHER SPACES.

NOTE:  
1. ALL EMERGENCY LIGHTS ARE PROVIDED WITH BATTERY BACK-UP POWER.  
2. ALL EMERGENCY LIGHTS ARE LOCATED LESS THAN 25'-0" FROM EACH OTHER.

NOTE:  
AS PER 27-532(a)(2), THE MINIMUM WIDTH OF AN AISLE SHALL BE 36" WIDE.

NOTE:  
AS PER 27-534(b) THE MINIMUM WIDTH OF AN EXIT OPENING SHALL BE 36" WIDE FOR SINGLE DOORS AND 66" FOR DOORS SWINGING IN PAIRS.

**§(C26-801.8) 27-532 AISLES AND CROSS AISLES**  
(1) CAPACITY. - THE CAPACITY OF AISLES AND CROSS AISLES SHALL BE AS LISTED IN TABLE 8-1. THE UNIT OF EXIT WIDTH SHALL BE TWENTY-TWO INCHES. SEATS OR OTHER FACILITIES SHALL NOT PROJECT INTO AN AISLE OR CROSS AISLE SO AS TO REDUCE THE WIDTH OF THE AISLE OR CROSS AISLE MORE THAN ONE INCH PER UNIT OF EXIT WIDTH.

(2) MINIMUM WIDTH. - AISLES AND CROSS AISLES SHALL HAVE A MINIMUM WIDTH OF FORTY-FOUR INCHES EXCEPT THAT THE WIDTH MAY BE AT LEAST THIRTY-SIX INCHES UNDER ANY ONE OR MORE OF THE FOLLOWING CONDITIONS:  
a. IN ANY ASSEMBLY SPACE HAVING A TOTAL OF NOT MORE THAN THREE HUNDRED OCCUPANTS.

NOTE:  
AS PER BC 27-526 & BC 1028.1: NO PLACE OF ASSEMBLY SHALL BE LOCATED WITHIN 250'-0" OF ANY OCCUPANCY CONTAINING EXPLOSIVE CONTENTS.

NOTE:  
AS PER AC 27-401 & FC 315: COMBUSTIBLE STORAGE, WHETHER LOCATED INSIDE OR OUTDOORS, OR ANY OTHER EQUIPMENT HAVING AN EXPLOSION HAZARD, IS PROHIBITED WITHIN 50'-0" OF ANY PLACE OF ASSEMBLY.

**FIRST FLOOR PUBLIC ASSEMBLY PLAN LEGEND**

- EXISTING CONSTRUCTION TO REMAIN UNDISTURBED
- EXISTING 2-HOUR RATED WALLS TO REMAIN UNDISTURBED
- NON RATED INTERIOR NON LOADING PARTITIONS FILED UNDER SEPARATE APPLICATION
- 3'-0" CLEAR ACCESS AISLE AS PER §(C26-801.8) 27-532
- EXISTING NON-COMBUSTIBLE DRAFT CURTAIN WITH SPRINKLER HEADS OFF DOMESTIC LINE AS PER TABLE 5-1 FIRE SEPARATIONS
- ILLUMINATED EXIT SIGN AND LIGHT (MAXIMUM 5 WATTS PER SIDE AS PER 2016 ECCNYC)
- 30"x48" MINIMUM CLEAR FLOOR SPACE AND LOCATION OF HANDICAPPED SEATING AT SEATING AREA

**EXISTING EATING AND DRINKING ESTABLISHMENT:**  
USE & OCCUPANCY PERMITTED UNDER CO# 51340.  
MAX. NUMBER OF PERSONS AS PER ALTERATION TYPE I FILED & APPROVED UNDER APPLICATION #220710498: 110  
EXISTING PA COMPLETED UNDER APPLICATION #201061206.  
ALTERATION TYPE II - RESTAURANT RENOVATION FILED UNDER SEPARATE APPLICATION.  
ALTERATION TYPE II - RANGE HOOD & ANSUL SYSTEM FILED & APPROVED UNDER SEPARATE APPLICATION #200430202.

3,019.00 SF  
USE GROUP: 6A  
OCCUPANCY GROUP: A-2  
NUMBER OF SEATS (PATRONS): 76  
NUMBER OF STANDEES (PATRONS): 19  
NUMBER OF EMPLOYEES: 5  
TOTAL NUMBER OF PERSONS AT EATING & DRINKING ESTABLISHMENT: 100

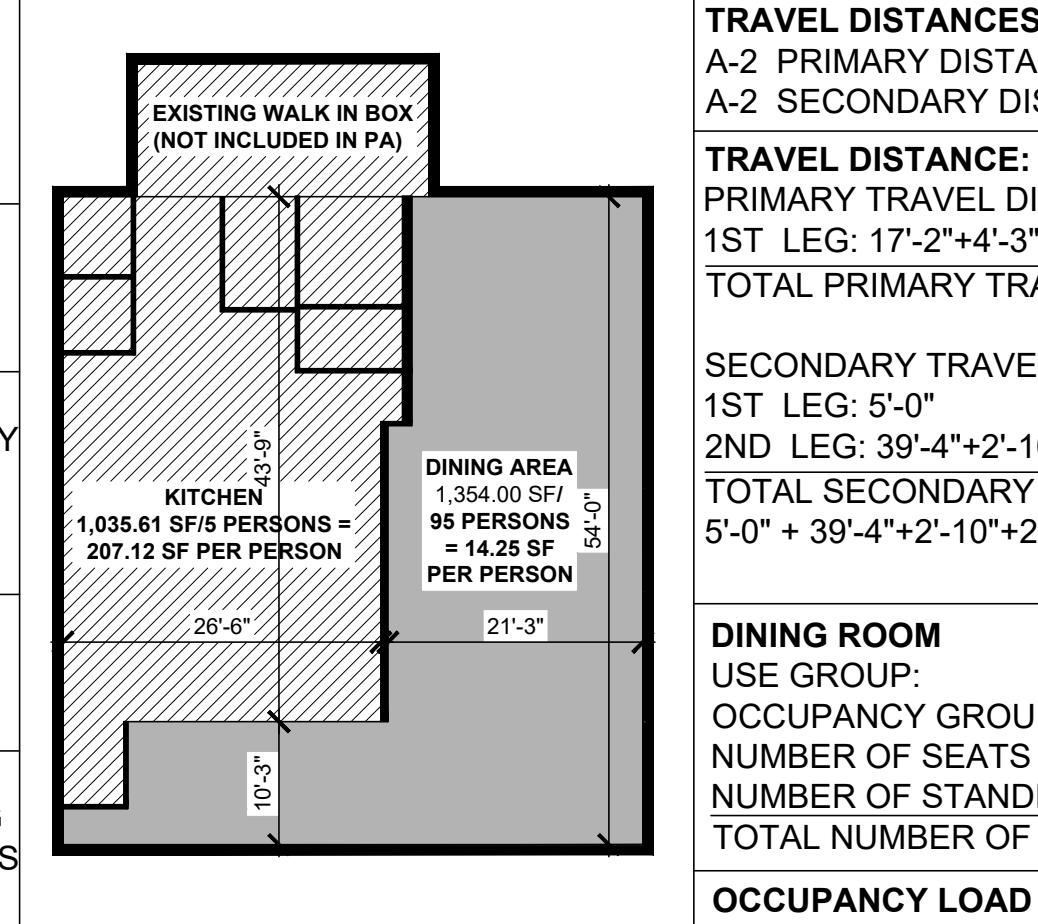
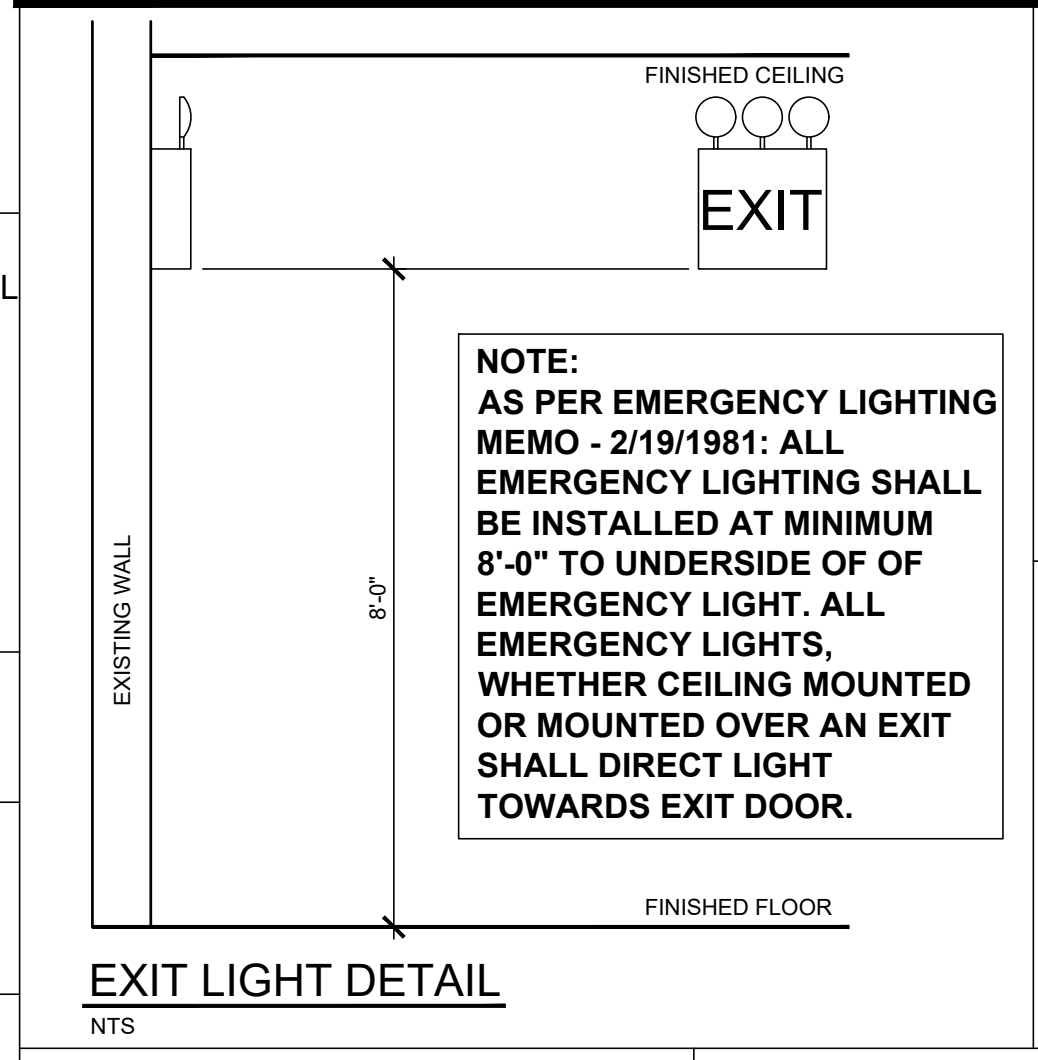

**NET AREA DIAGRAM**

NET AREA DIAGRAM  
NTS

- NET FLOOR AREA DIAGRAM LEGEND**
- DINING/STANDEE AREA - PUBLIC ASSEMBLY SPACE
  - EXISTING DEMISING/EXTERIOR WALLS
  - MISC. NOT INCLUDED IN PUBLIC ASSEMBLY SPACE

NOTE:  
AS PER § 27-366, (2) INDEPENDENT MEANS OF EGRESS SHALL BE PROVIDED FOR PUBLIC ASSEMBLIES. TOTAL PERSONS AT PUBLIC ASSEMBLY LESS THAN 500.

**PLUMBING FIXTURE REQUIREMENTS FOR EXISTING DINING ESTABLISHMENT:**  
OCCUPANCY: A-2  
REQUIRED FIXTURES AS PER TABLE 403.1:

REQUIRED: 95 / 2 = 47  
REQUIRED WATER CLOSETS: 1/75 FOR EACH SEX.  
1 WATER CLOSET REQUIRED FOR EACH SEX.

REQUIRED LAVATORY: 1 PER 200 PERSONS  
1 LAVATORY REQUIRED FOR EACH SEX.

SERVICE SINK: 1 SERVICE SINK REQUIRED

**PLUMBING FIXTURES PROVIDED:**  
MALE: (1) WATER CLOSET  
(1) LAVATORY

FEMALE: (1) WATER CLOSET  
(1) LAVATORY

OTHER: (1) SERVICE SINK

Special & Progress Inspections:  
M. JUST ARCHITECTURE, P.C. SHALL ONLY IDENTIFY ALL REQUIRED SPECIAL & PROGRESS INSPECTIONS AS THE DESIGN APPLICANT.  
THE OWNER MUST RETAIN A CERTIFIED SPECIAL INSPECTION AGENCY PRIOR TO THE ISSUANCE OF A WORK PERMIT FOR ALL OF THE REQUIRED SPECIAL & PROGRESS INSPECTION ITEMS.  
Note:  
THIS PLAN IS APPROVED ONLY FOR WORK INDICATED ON THE APPLICATION SPECIFICATION SHEET. ALL OTHER MATTERS SHOWN ARE NOT TO BE RELIED UPON OR TO BE CONSIDERED EITHER BEING APPROVED OR IN ACCORDANCE WITH APPLICABLE CODES.

**TRAVEL DISTANCES FOR SPRINKLED SPACES (AS PER TABLE 8-1):**  
A-2 PRIMARY DISTANCE = 127'-6"  
A-2 SECONDARY DISTANCE = 187'-6"

**TRAVEL DISTANCE:**  
PRIMARY TRAVEL DISTANCE:  
1ST LEG: 17'-2"+4'-3"+12'-2"+5'-0" = 38'-7"  
TOTAL PRIMARY TRAVEL DISTANCE: 38'-7" < 127'-6" OKAY

SECONDARY TRAVEL DISTANCE:  
1ST LEG: 5'-0"  
2ND LEG: 39'-4"+2'-10"+2'-6"=49'-8"  
TOTAL SECONDARY TRAVEL DISTANCE = 5'-0" + 39'-4"+2'-10"+2'-6"=49'-8" = 57'-1" < 187'-6" OKAY

**DINING ROOM**  
USE GROUP: 6A  
OCCUPANCY GROUP: A-2  
NUMBER OF SEATS (PATRONS): 76  
NUMBER OF STANDEES: 19  
TOTAL NUMBER OF PERSONS: 95

**OCCUPANCY LOAD CALCULATION AS PER TABLE 8-2:**  
TOTAL PERSONS: 95 PERSONS  
AREA OF PA SPACE = 1,354.00 SF

AS PER TABLE 8-1 - DINING SPACES (NON RESIDENTIAL):  
FLOOR AREA PER PERSON =  $\frac{1,354.00}{95} = 14.25$  SF/PERSON

**HC SEATING CALCULATION:**  
76 x 0.05 = 3.8 = 4 HANDICAP SEATS REQUIRED  
4 PROPOSED HANDICAP SEATS, OKAY

**\*\* SEE PUBLIC ASSEMBLY LEGEND FOR COORDINATION. ALL HANDICAP SEATING SHALL BE 30"x48" MINIMUM CLEAR FLOOR SPACE AND LOCATION OF HANDICAPPED SEATING AT LOOSE SEAT AREA\*\***

Michael D. Just, R.A., A.I.A.  
718.855.1237  
mjust@mjarch.com  
www.justarchitecture.com

**JUST ARCHITECTURE**  
572 Henry Street - Brooklyn, New York 11231

Rev. #	Date	Description	By
03-09-21		AS PER DOB OBJECTIONS	MY

Special & Progress Inspections:  
M. JUST ARCHITECTURE, P.C. SHALL ONLY IDENTIFY ALL REQUIRED SPECIAL & PROGRESS INSPECTIONS AS THE DESIGN APPLICANT.  
THE OWNER MUST RETAIN A CERTIFIED SPECIAL INSPECTION AGENCY PRIOR TO THE ISSUANCE OF A WORK PERMIT FOR ALL OF THE REQUIRED SPECIAL & PROGRESS INSPECTION ITEMS.  
Note:  
THIS PLAN IS APPROVED ONLY FOR WORK INDICATED ON THE APPLICATION SPECIFICATION SHEET. ALL OTHER MATTERS SHOWN ARE NOT TO BE RELIED UPON OR TO BE CONSIDERED EITHER BEING APPROVED OR IN ACCORDANCE WITH APPLICABLE CODES.

New York Alteration Warning Statement:  
IT IS A VIOLATION OF NEW YORK REGULATION 26.05(b) FOR ANY PERSON, UNLESS ACTING UNDER THE DIRECTION OF A LICENSED ARCHITECT, TO ALTER AN ITEM IN ANY WAY WITHOUT AFFIXING TO THE ITEM HIS SEAL AND THE NOTIFICATION "ALTERED BY" FOLLOWED BY A SIGNATURE, DATE OF SUCH ALTERATION AND A SPECIFIC DESCRIPTION OF THE ALTERATION

Copyright:  
ALL IDEAS, DESIGNS, ARRANGEMENTS, DRAWINGS AND WRITTEN MATERIALS INDICATED OR REPRESENTED BY THIS DRAWING HEREIN CONSTITUTE ORIGINAL AND UNPUBLISHED WORK AND ARE OWNED BY AND PROPERTY OF M. JUST ARCHITECTURE, P.C. AND WERE CREATED, EVOLVED AND DEVELOPED FOR USE IN CONNECTION WITH THIS SPECIFIC PROJECT. NONE OF SUCH IDEAS, DESIGNS, ARRANGEMENTS OR PLANS SHALL BE DUPLICATED, USED BY OR DISCLOSED TO ANY PERSON, FIRM OR CORPORATION FOR ANY PURPOSE WHATSOEVER WITHOUT THE WRITTEN PERMISSION OF M. JUST ARCHITECTURE, P.C.

Client:  
Jay DellaMonica  
Creative Food Corp  
200 Garden City Plaza  
Garden City, NY 11530

DOB Approval Stamps:

Project Address:  
3500 Boston Post Road  
Bronx, NY 10803

Seal:

Drawing Title:  
**FIRST FLOOR PUBLIC ASSEMBLY PLAN**

NYCDOB APPLICATION:  
**X00433340-11**

BLOCK: 4723	Job No.: 18049	Date: 03-09-21
LOT: 66	Drawn By: C2-2 in R5	Sheet: 2 of 2
ZONE: MAP:	2b	MY

Drawing No.: **PA-001.00**