

THE DEDICATED POS POWER CIRCUIT REQUIRES AN ISOLATED GROUND IN ADDITION TO THE NORMAL COMMON BUILDING GROUND. THE ISOLATED GROUND WIRE SERVES TWO PURPOSES:
 * AS A SAFETY PATH TO GROUND.
 * AS A ZERO REFERENCE POINT FOR ALL POS DIGITAL LOGIC.

THE GROUND MUST EXHIBIT THE LOWEST POSSIBLE IMPEDANCE TO MINIMIZE VOLTAGE TRANSIENTS AND NOISE.

BE SURE TO:

- * USE AN INSULATED CONDUCTOR FOR THE ISOLATED GROUND WIRE.
- * RUN THE ISOLATED GROUND WIRE THROUGH THE SAME CONDUIT AS THE HOT AND NEUTRAL WIRES.
- * INSTALL ONLY ISOLATED GROUND (IG) TYPE RECEPTACLES.
- * CONNECT THE ISOLATED GROUND WIRE TO BUILDING GROUND ONLY AT THE MAIN SERVICE PANEL.
- * VERIFY THAT IG RECEPTACLES PRE-WIRED IN OWNER SUPPLIED EQUIPMENT HAVE A TRUE ISOLATED GROUND THAT CAN BE TRACED BACK TO THE BUILDING GROUND AT THE MAIN SERVICE PANEL.

DO NOT CONNECT THE ISOLATED GROUND WIRE TO THE CONDUIT, JUNCTION BOXES, THE FRAME ON A SUBPANEL, OR ANY OTHER METAL SURFACE.

DEDICATED CIRCUITS: DEDICATED CIRCUITS REQUIRE A DEDICATED HOT AND A DEDICATED NEUTRAL THAT ARE NOT SHARED WITH ANY OTHER CIRCUITS. IG RECEPTACLES MUST BE 'PHASE ALIGNED' WITH THE 'B' PHASE OF BUILDING SUBPANEL 'A'.

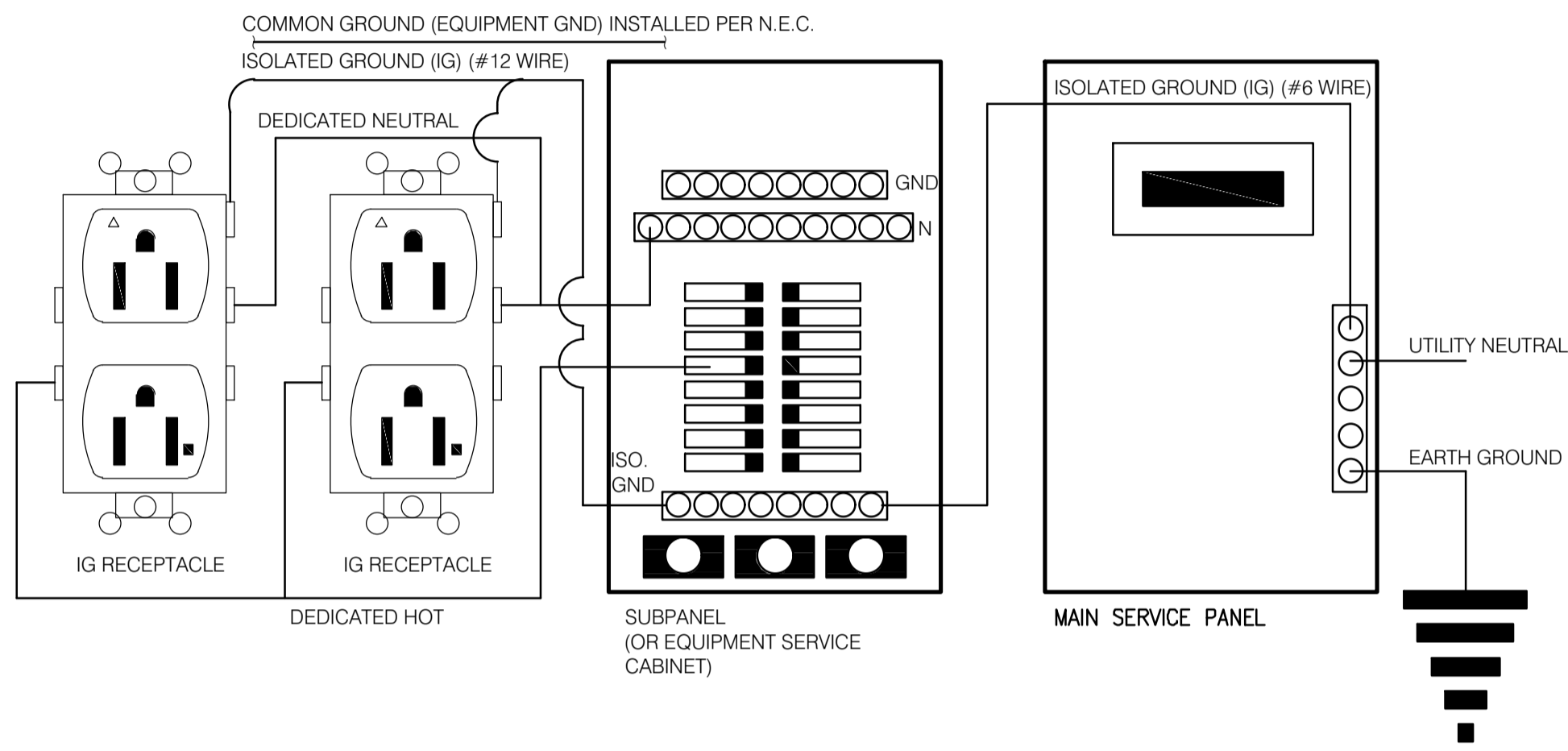

P.O.S. ISOLATED GROUND SYSTEM N.T.S. **14**

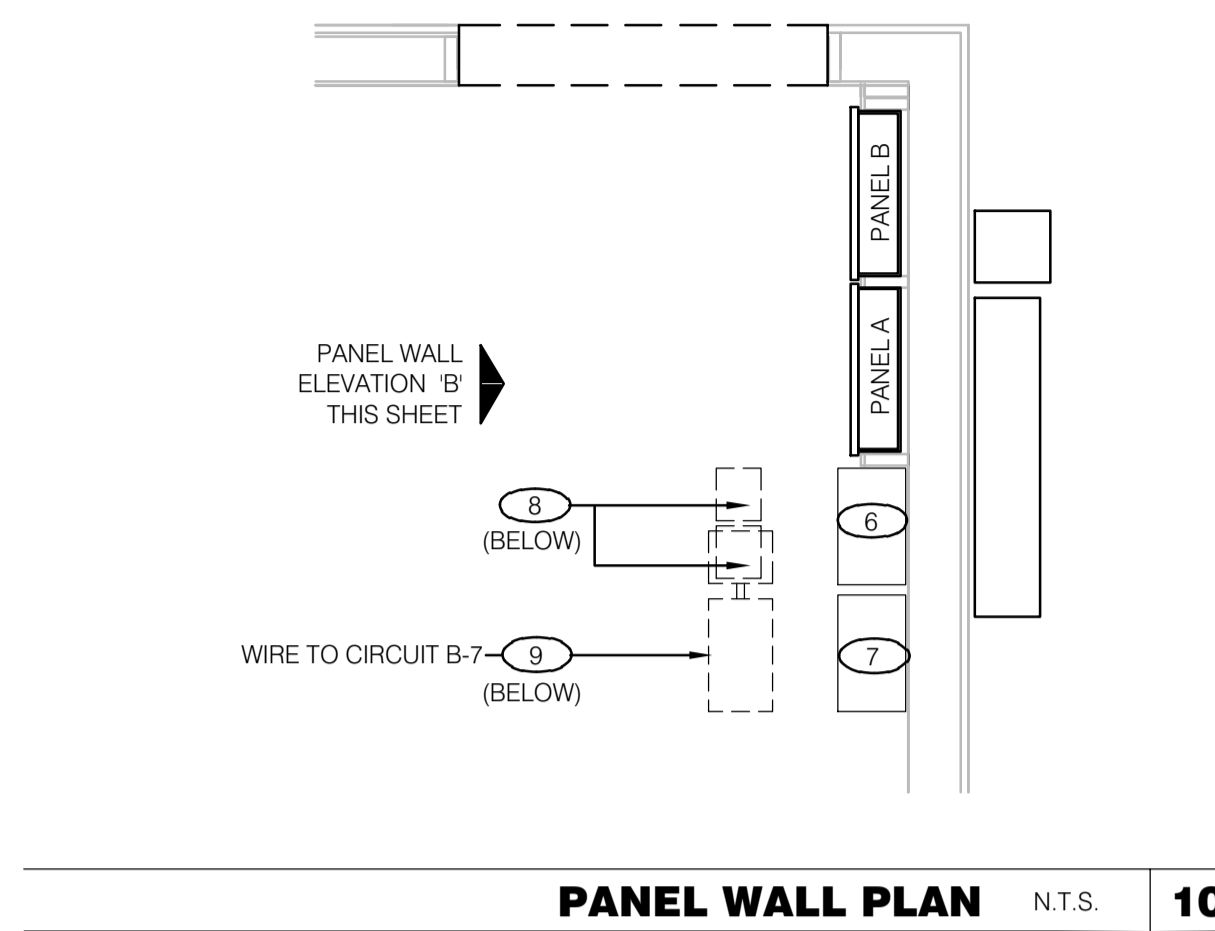

NOT USED **12**

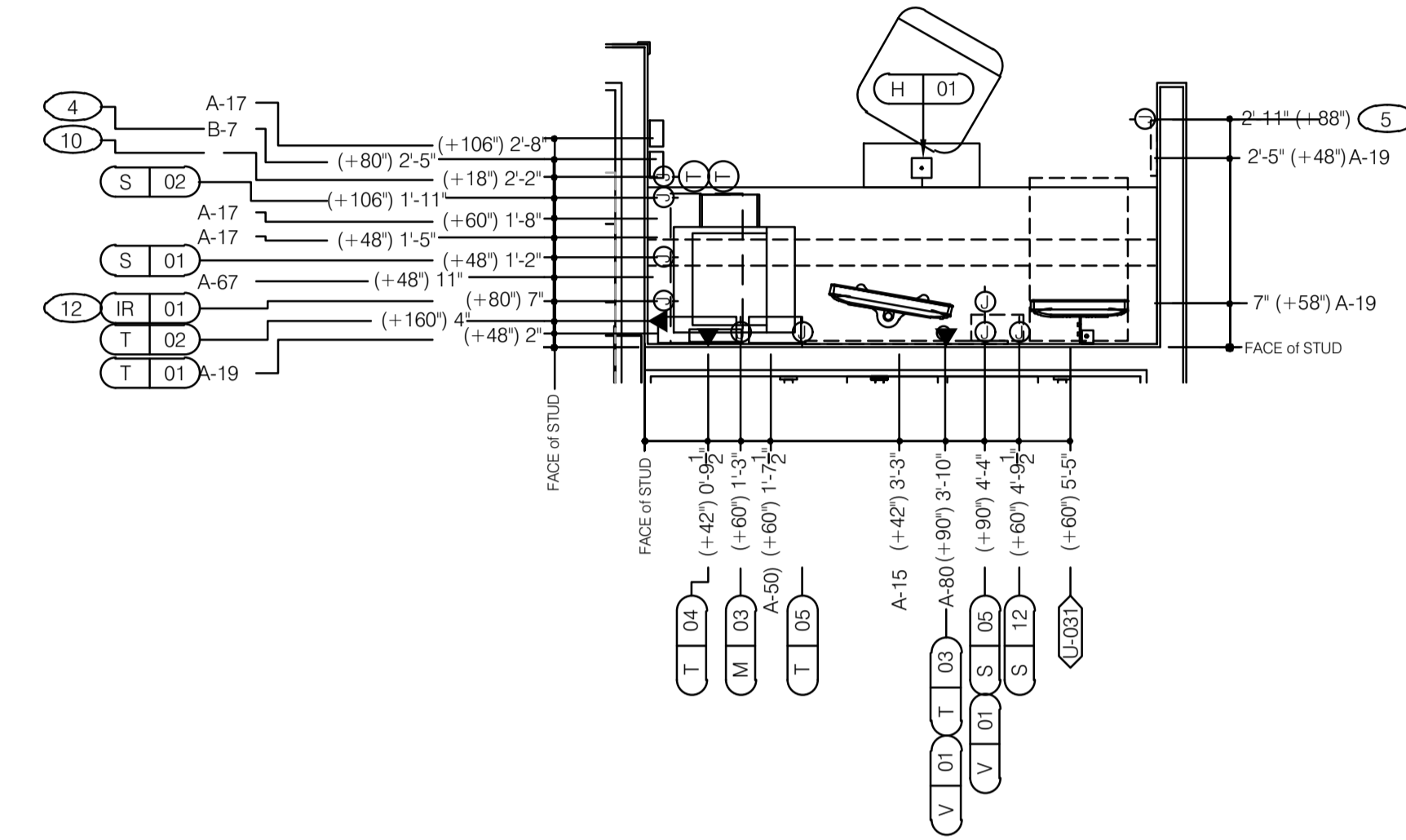

ENLARGED POWER AND COMMUNICATIONS PLAN (OFFICE) 1/2" = 1'-0" **3**

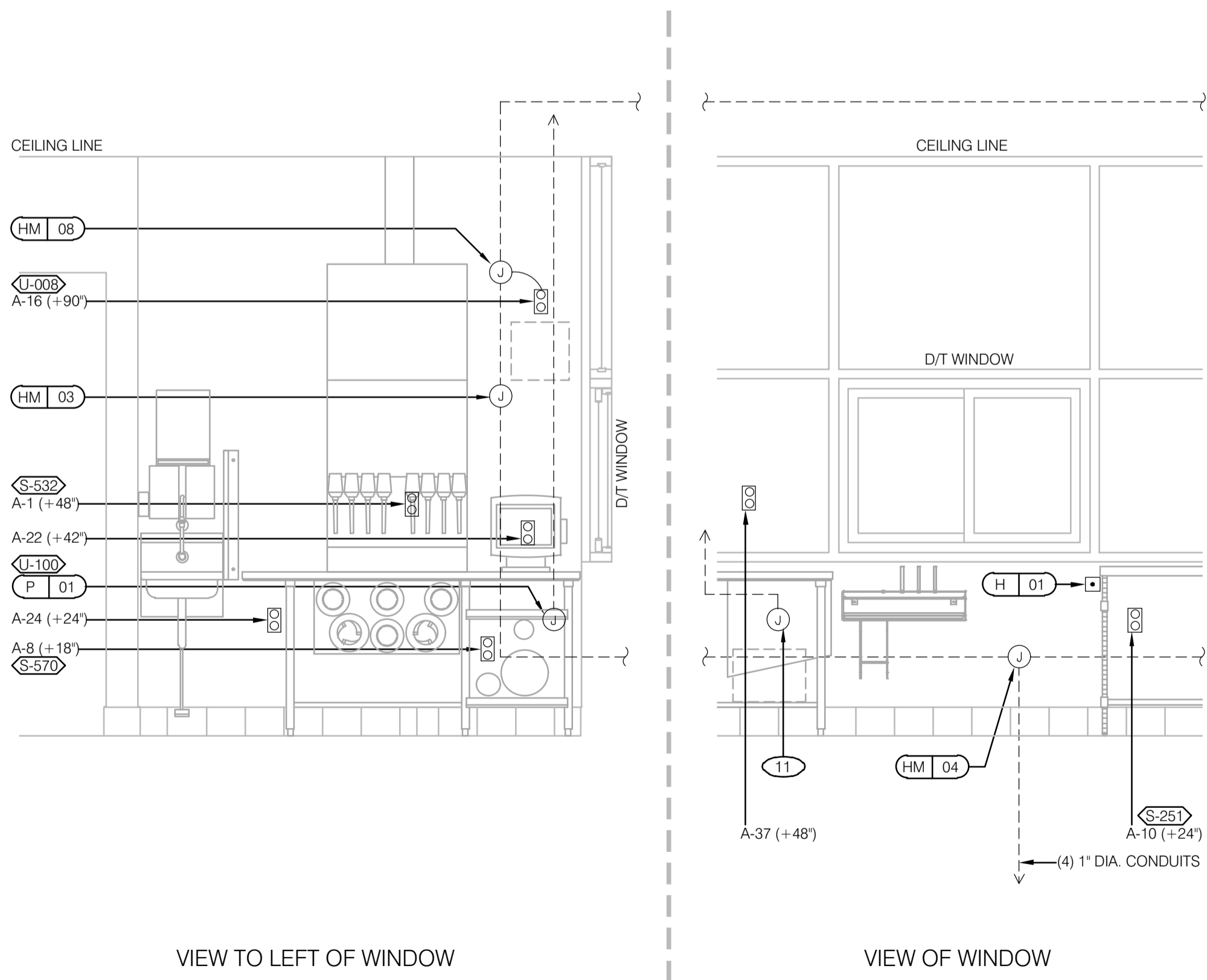

REFER TO COMMUNICATIONS SCHEDULE ON SHEET E5.0 FOR EQUIPMENT DESCRIPTIONS/MOUNTING HTS.

ENLARGED INTERIOR ELEVATION (D/T WINDOW) 1/2" = 1'-0" **16**

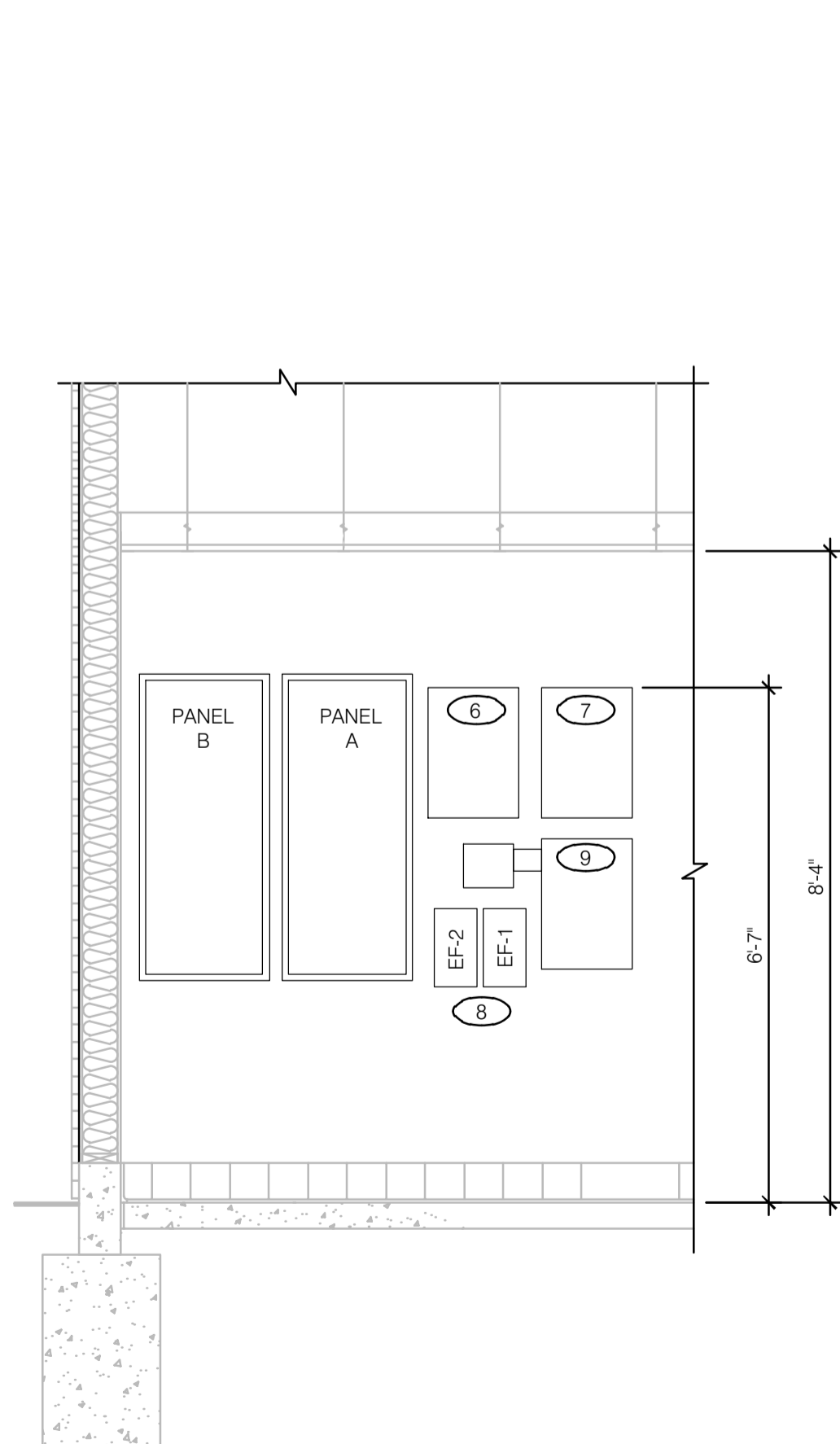

PANEL WALL ELEVATION N.T.S. **B**

- 1 NOT USED.
- 2 DISPLAY UNIT FOR HM-02.
- 3 DUAL-OUTPUT DETECTOR FOR HM-02.
- 4 VENTILATION CONTROL SWITCH.
- 5 PROVIDES ACCESS FOR REMOTE MONITORING / CONTROL OF HVAC + LIGHTING SYSTEMS. G.C. TO PROVIDE J-BOX W/ PULL-STRING.
- 6 CONTACTOR PANEL AND CONTACTORS BY SWITCH GEAR SUPPLIER. REFER TO DETAIL 2 / E6.0. SEE SHEET E2.1.
- 7 VENTILATION CONTROL PANEL. ACTIVATED VIA VENTILATION CONTROL SWITCH IN MANAGER'S OFFICE; REFER TO KEYNOTE 4, THIS SHEET.
- 8 EXHAUST FAN MOTOR STARTERS BY VENTILATION EQUIPMENT SUPPLIER. REFER TO DETAILS 2 and 4 / E6.0.
- 9 LIGHTING CONTACTOR PANEL + EXTERNAL NEMA BOX. REFER TO LIGHTING CONTACTOR DETAILS, SHEET E6.0.
- 10 THERMOSTATS. COORDINATE WITH M2.0.
- 11 J-BOX / DATA PORT FOR FUTURE 'FAST and FRESH' DRIVE THRU DISPLAY TIMER. MOUNT at 24" A.F.F.
- 12 PROVIDE 1" CONDUIT TO IRRIGATION VALVES; SEE P3.0 FOR LOCATION. SEE COMMUNICATIONS SCHEDULE, SHEET E5.0.

KEY NOTES **A**

REVIEWED
 For Code Compliance
 City of Ocala Growth Management
 BLD22-1101 09/07/22

ARCHITECTURE
 ENGINEERING

LIS

ENGINEERING OFFICE
 21430 Palm Beach Blvd.
 Alt. Ave. Fla. 33920
 Phone: (239) 693-9244
 facsimile: (239) 693-9828

LAND INVESTMENT SERVICES, LLC
 AA 26002040 CA NO: 6853 LB1057
 ARCHITECTURE / ENGINEERING OFFICE
 21430 Palm Beach Blvd.
 Suite 2064, Ocala, FL 32765
 Phone: (321) 244-0402
 facsimile: (321) 244-9419

Digitally signed by
ROBERT W CASE
 Date: 2022.03.31 10:23:50 -04'00'

ROBERT WAYNE CASE
 FLORIDA PE. #44643

PLAN SET REVISIONS:

1	
2	
3	
4	
5	
6	
7	
8	
9	
10	
11	
12	

CONTRACT DATE: ..,2019
 BUILDING TYPE: Kb 30-19
 PLAN VERSION: 2018.A
 SITE NUMBER:
 ENTITY NUMBER:
 STORE NUMBER:
 LIS PROJECT: 2019-304

KFC
 3615 W SILVER SPRINGS BLVD.
 Ocala, FL



ENLARGED POWER PLAN AND DETAILS

E3.1

PLOT DATE: 03/29/2022