

PLOTTED: 4/25/2022 11:04 AM

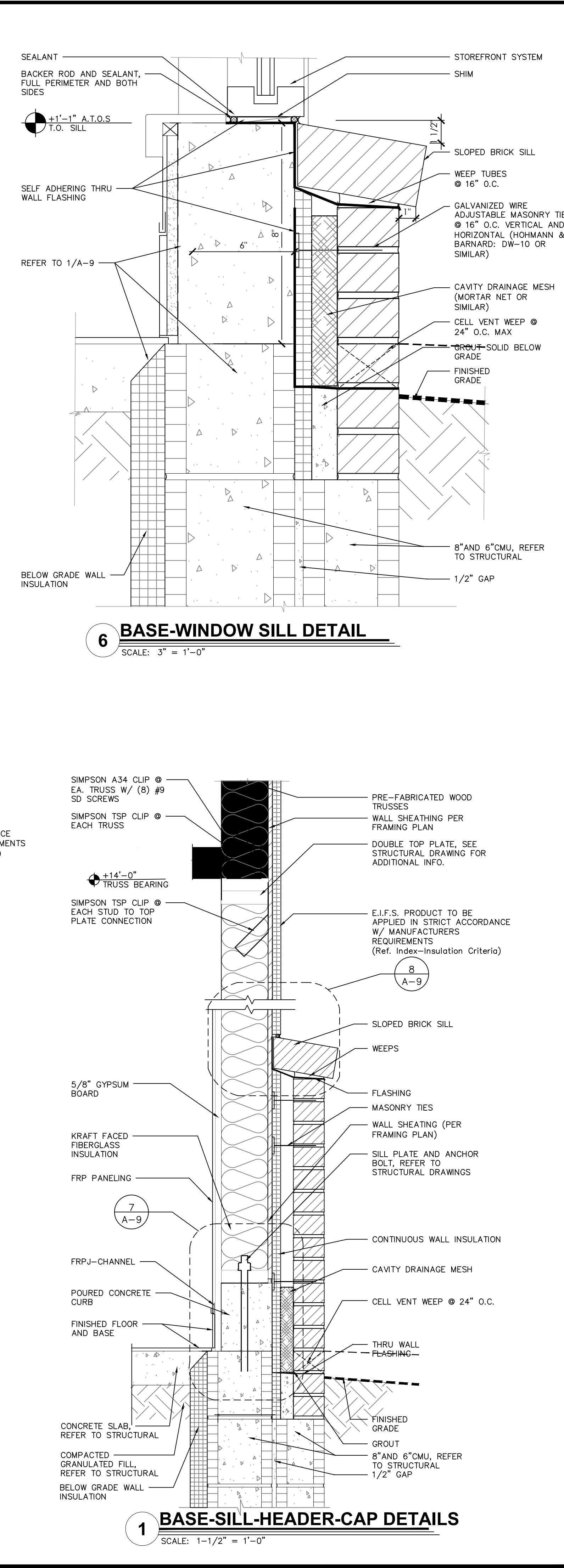
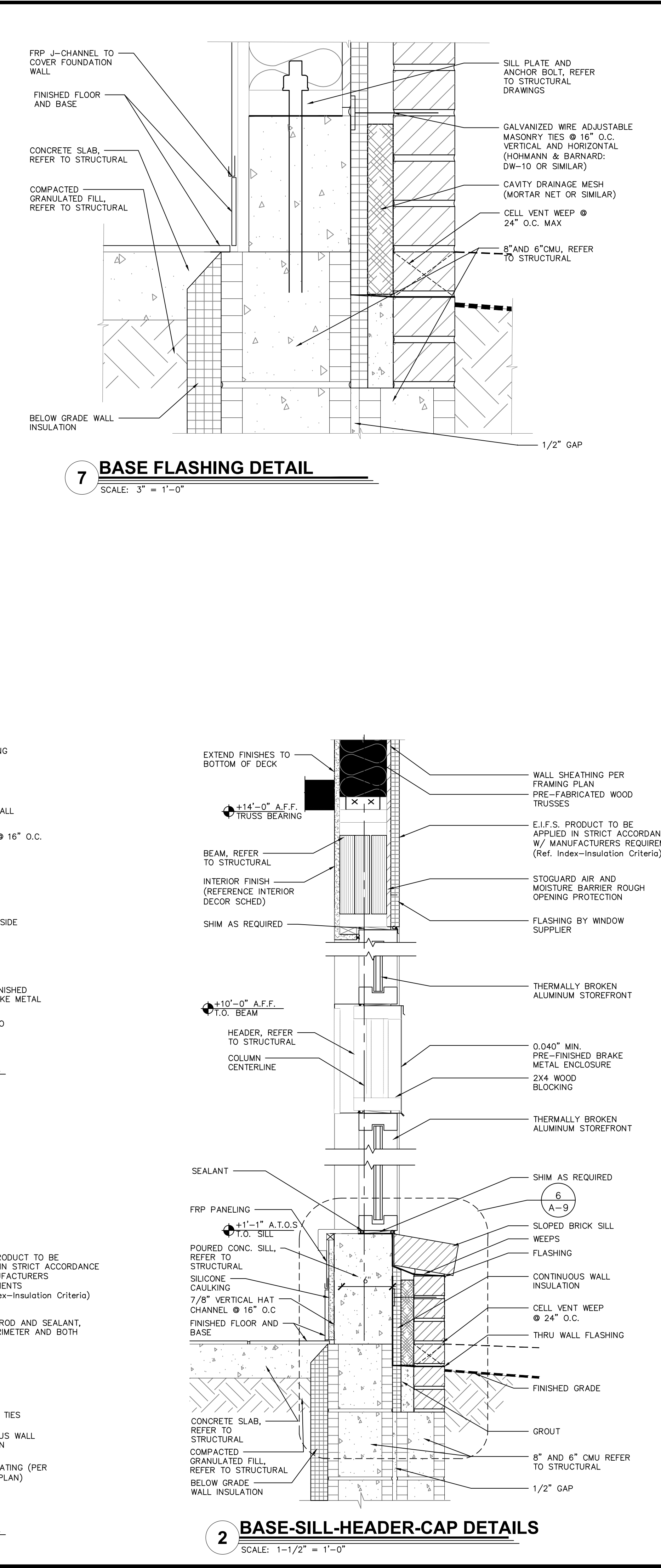
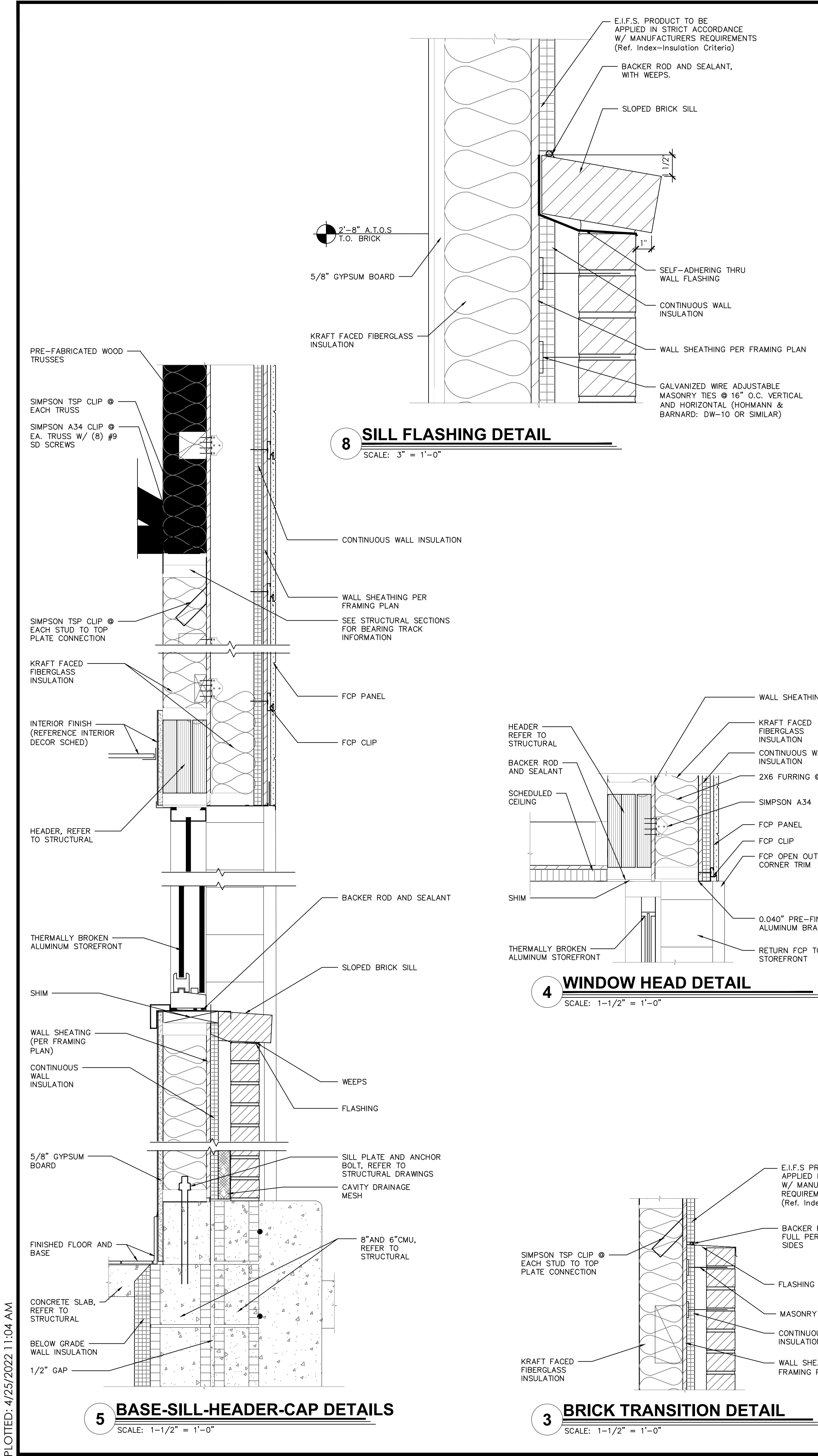

Issued:	Date:
A BKC Approval	10/29/2021
B Permit Set	1/28/2022
C Bid Set	4/25/2022
D	
E	
Revisions:	Date:
1	
2	
3	
4	
5	
6	
7	
8	
9	
Seal	Seal
PROJECT ARCHITECT/ENGINEER	DATE
PROJECT LEAD	DATE
PROJECT DESIGNER	DATE
Copyright © 2022 APD Engineering & Architecture, LLC	
Drawing Alteration It is a violation of law for any person, unless acting under the direction of a licensed Architect, Professional Engineer, Landscape Architect, or Land Surveyor to alter any item on this document in any way. Any licensee who alters this document is required by law to affix his or her seal and to add the notation "Altered By" followed by his or her signature and the specific description of the alteration or revision.	
[DO NOT SCALE PLANS]	
Copying, Printing, Software and other processes required to produce these prints can stretch or shrink the actual paper or layout. Therefore, scaling of this drawing may be inaccurate. Contact APD E&A with any need for additional dimensions or clarifications.	
APD ENGINEERING ARCHITECTURE 615 Fishers Run Victor, NY 14564 585.742.2222 - www.apd.com	
Ampler Restaurant Group c/o Quimby Business Support Services 1850 Parkway Place Suite 1150 Marietta, GA 30067	
Burger King Inc. Store # 30011 108 Egg Harbor Road Sewell, NJ 08080 Gloucester County Project Name & Location:	
Details Drawing Name:	
Date: 11/8/2021	Project No. 21-0458
Type: BK ROC-60	
Drawn By: MGV	A-9
Scale: As Noted	Drawing No.