

T:\2021\T1747\FBMR - ROUTE 41 AND EGG HARBOR ROAD, DEPTFORD, NJ\CD\LOT\LLWP\07H\HDS\WAL\LLWP.DWG

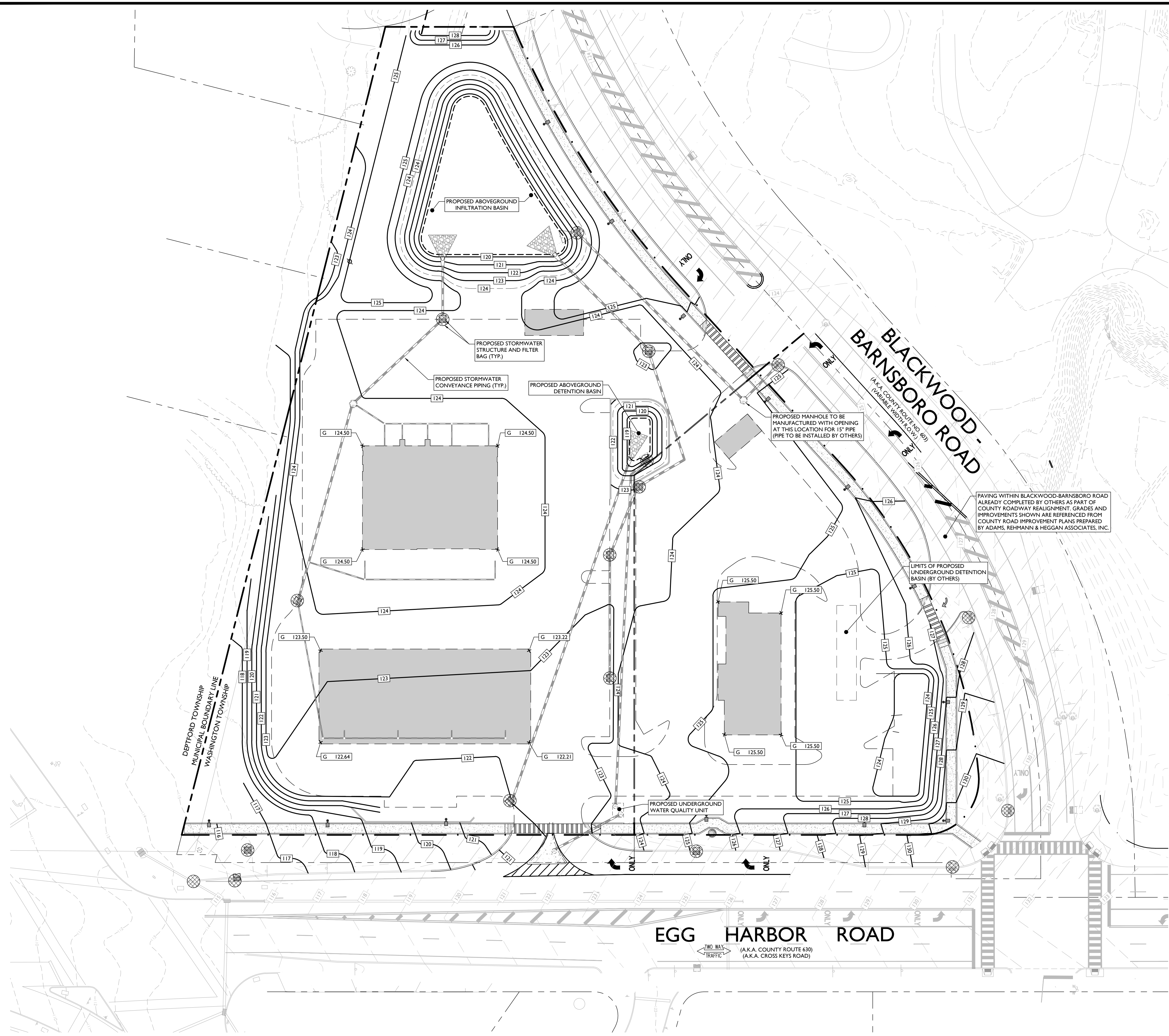

SYMBOL	DESCRIPTION
	PROPERTY LINE
	ADJOINING LOT LINE
	PROPOSED CURB
	PROPOSED DEPRESSED CURB
	PROPOSED FLUSH CURB
	PROPOSED CONCRETE

CONTRACTOR TO REFER TO NOTES AND DETAILS IN THE PRELIMINARY AND FINAL MAJOR SITE PLAN PREPARED BY STONEFIELD ENGINEERING & DESIGN, ORIGINALLY DATED MAY 25, 2019, LATEST REVISION

FOR COUNTY ROADWAY WORK COMPLETED BY OTHERS, REFER TO COUNTY ROAD IMPROVEMENT PLANS PREPARED BY ADAMS, REHMANN & HEGGAN ASSOCIATES, INC, DATED SEPTEMBER 30, 2019, LATEST REVISION

FOR DEMOLITION WORK ON EXISTING PAD SITE, REFER TO PRELIMINARY AND FINAL MAJOR SITE PLAN PREPARED BY STONEFIELD ENGINEERING & DESIGN, ORIGINALLY DATED MAY 25, 2019, LATEST REVISION

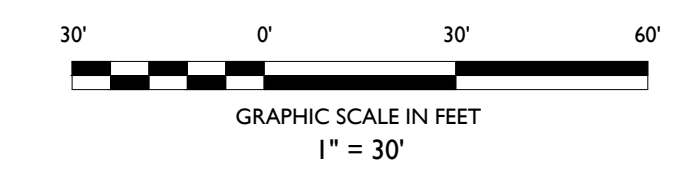

ISSUE	DATE	BY	DESCRIPTION
1	04/08/2022	JCL	FOR TENANT REVIEW
0	01/24/2022	JCL	FOR CONSTRUCTION

NOT APPROVED FOR CONSTRUCTION

STONEFIELD
engineering & design

Rutherford, NJ · Princeton, NJ · Long Island City, NY · Royal Oak, MI
www.stonefielddesign.com

15 Spring Street, Princeton, NJ 08542
Phone 609.362.6900

LANDLORD WORK PLAN
PROPOSED CONVENIENCE STORE
WITH FUEL SALES & FAST FOOD
RESTAURANT WITH DRIVE-THRU
FACILITIES

DELSEA DRIVE REDEVELOPMENT NODE 4
TAX MAP SHEET #29
BLOCK 7.04, LOT 6.02 & BLOCK 7.04, LOT 6
BLOCK 7.04, LOTS 6.06 & 6.07
108 EGG HARBOR ROAD
TOWNSHIP OF WASHINGTON
GLOUCESTER COUNTY, NJ

JEFFREY A. MARTELL, P.E.
NEW JERSEY LICENSE No. 47290
LICENSED PROFESSIONAL ENGINEER

STONEFIELD
engineering & design

SCALE: 1" = 30' PROJECT ID: T-1747

TITLE:
LANDLORD WORK PLAN
(GRADING & DRAINAGE)

DRAWING:

LLWP-2