

ANGLED PARKING STALL MARKINGS

NOT TO SCALE

1

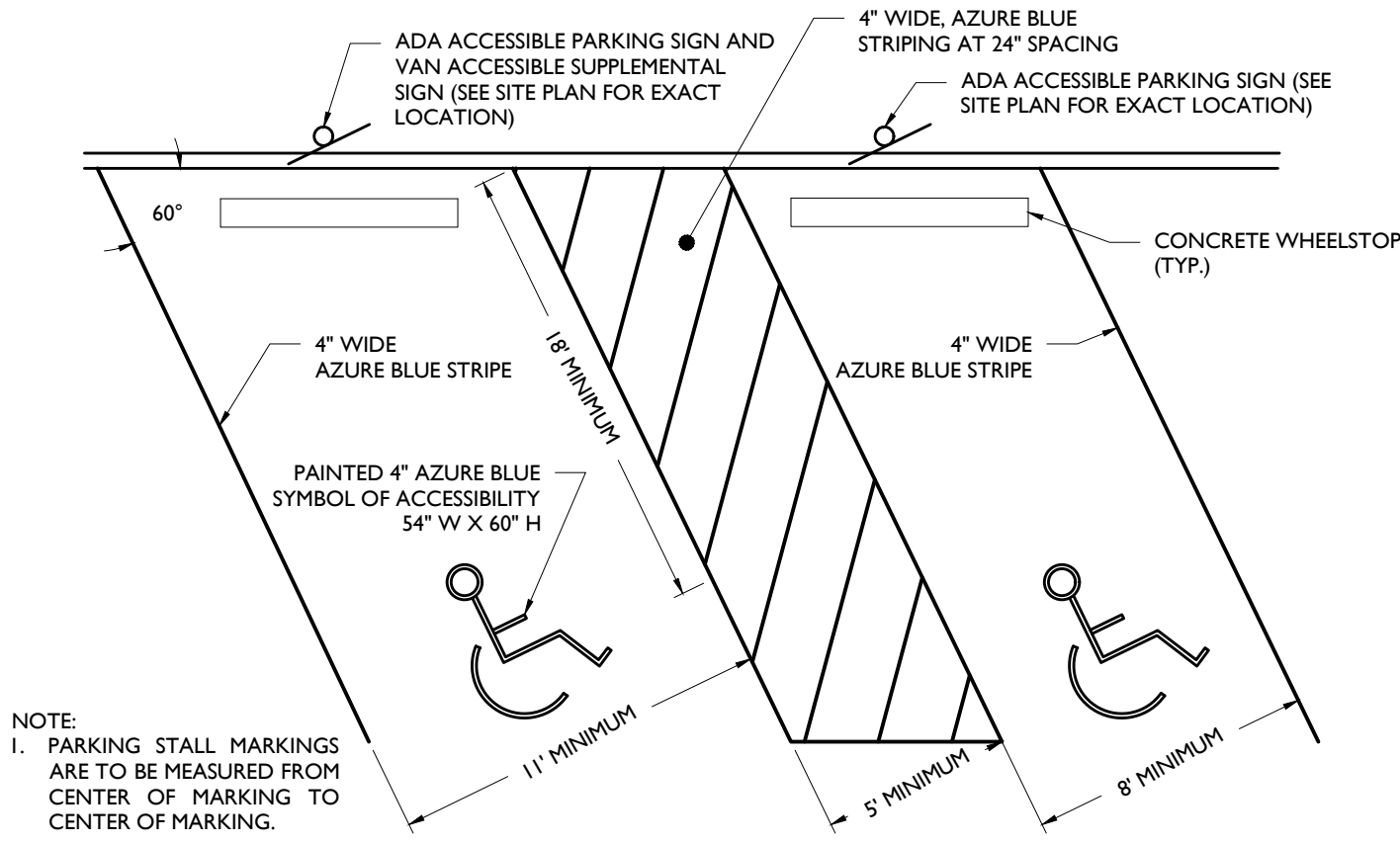

ACCESSIBLE PARKING STALL MARKINGS

NOT TO SCALE

2

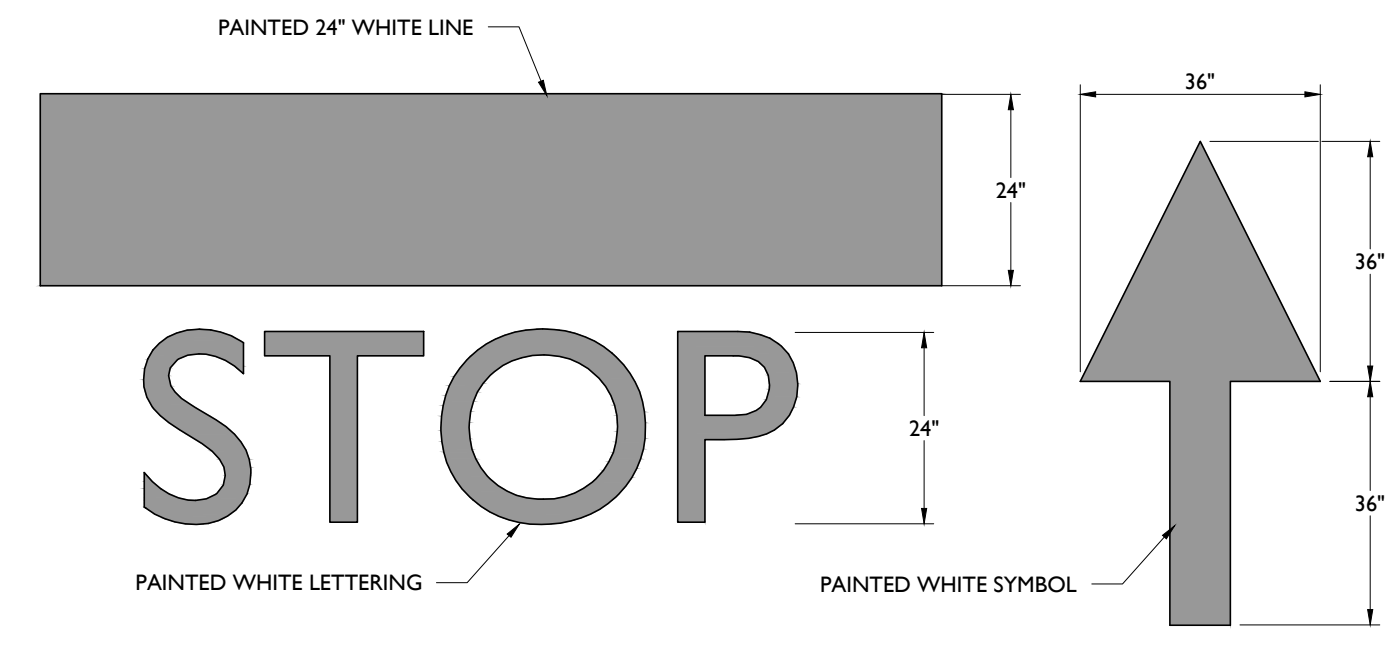

STOP BAR & ARROW DETAILS

NOT TO SCALE

3

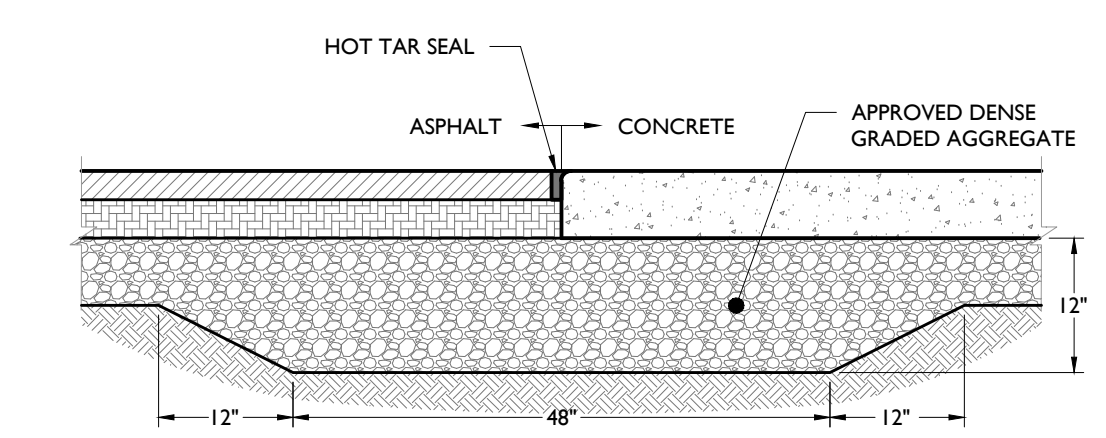

CONCRETE TO ASPHALT TRANSITION DETAIL

NOT TO SCALE

4

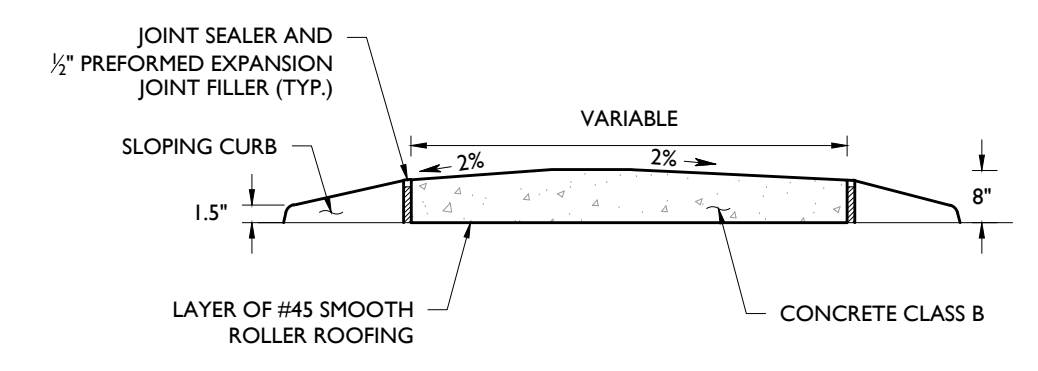

MOUNTABLE CONCRETE/WHITE CONCRETE ISLAND

NOT TO SCALE

5

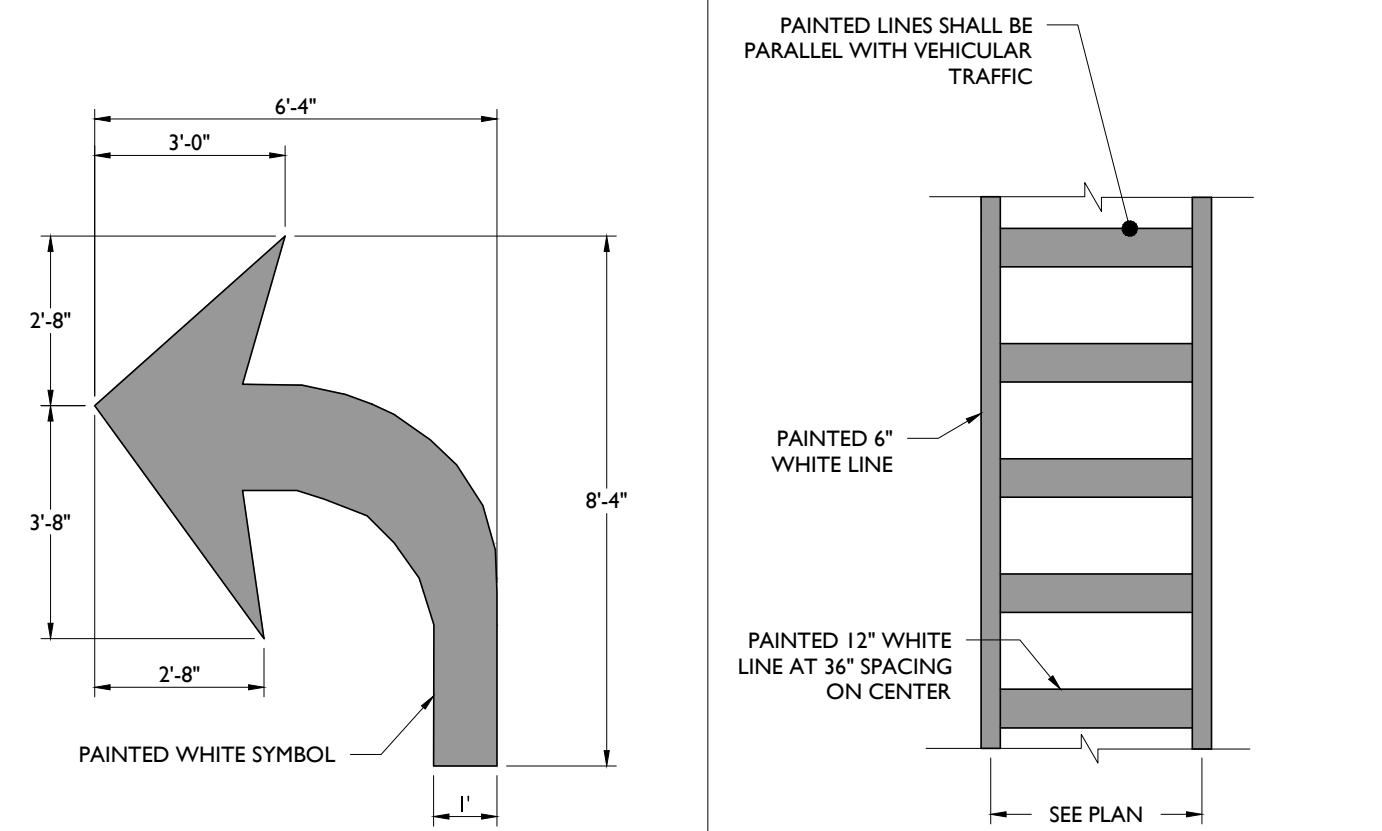

TURN ARROW DETAIL

NOT TO SCALE

6

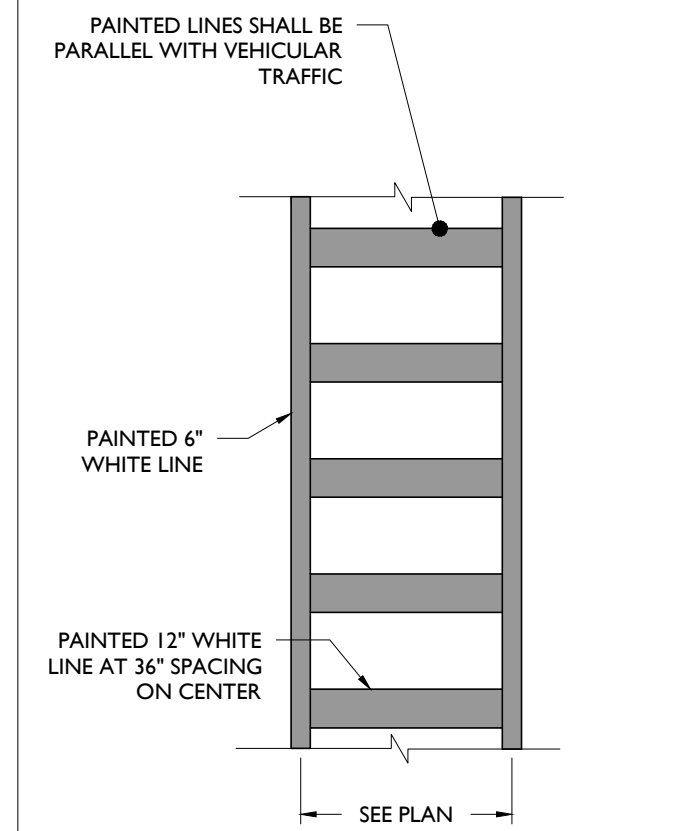

CROSSWALK DETAIL

NOT TO SCALE

7

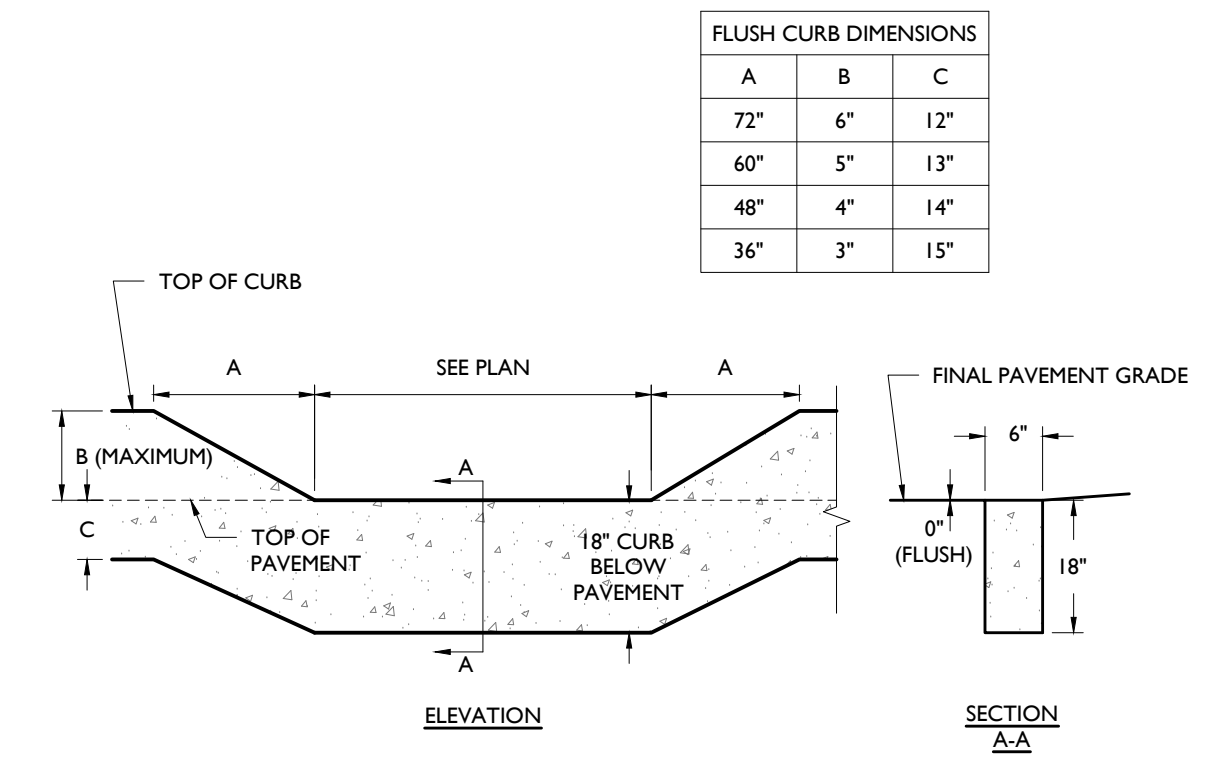

FLUSH CURB DETAIL

NOT TO SCALE

8

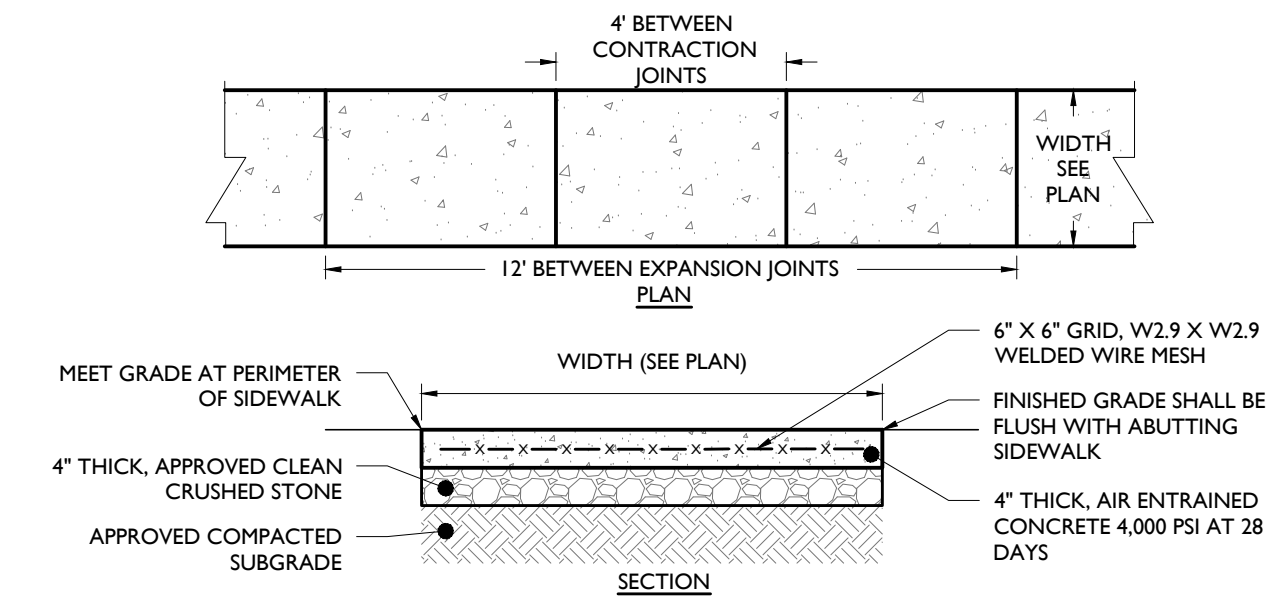

REINFORCED CONCRETE WALKWAY DETAIL

NOT TO SCALE

9

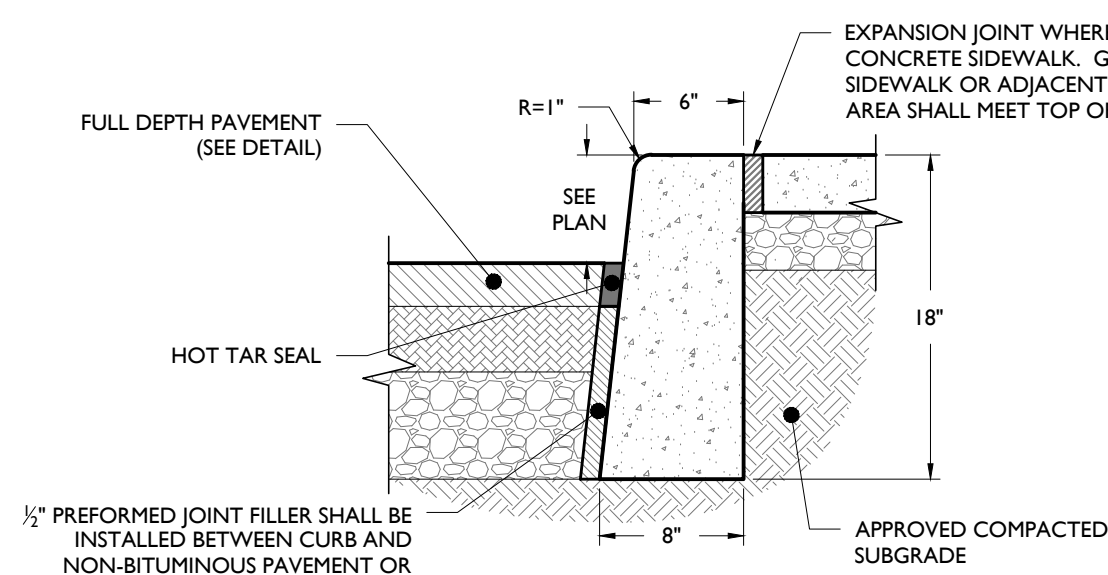

CONCRETE CURB DETAIL

NOT TO SCALE

10

M.U.T.C.D. NUMBER	TEXT	COLOR		SIZE OF SIGN (WIDTH X HEIGHT)	TYPE OF MOUNT
		LEGEND	BACKGROUND		
STOP SIGN (R1-1)		WHITE	RED	36" X 36"	GROUND
DO NOT ENTER (R5-1)		RED	WHITE	30" X 30"	GROUND

SIGN DATA TABLE

NOT TO SCALE

11

- NOTES:
- CONCRETE SHALL BE 3500 PSI AT 28 DAYS, AIR-ENTRAINED.
 - TRANSVERSE EXPANSION JOINTS SHALL BE PROVIDED AT 20 FOOT INTERVALS WITH PRE-MOLDED, BITUMINOUS JOINT FILLER, RECESSED 1/2" FROM SURFACE.
 - HALF DEPTH CONTRACTION JOINTS SHALL BE PROVIDED AT 10 FOOT INTERVALS.
 - 18" CURB DEPTH SHALL BE MAINTAINED AT DEPRESSED OR FLUSH CURBED AREAS.

- NOTE:
- ALL SIGNS SHALL BE IN ACCORDANCE WITH THE FEDERAL HIGHWAY ADMINISTRATION (FHWA) MANUAL ON UNIFORM TRAFFIC CONTROL DEVICES (MUTCD), EXCEPT AS NOTED.
 - ALL SIGNS SHALL BE MOUNTED AS TO NOT OBSTRUCT THE SHAPE OF "STOP" (R1-1) AND "YIELD" (R1-2) SIGNS.

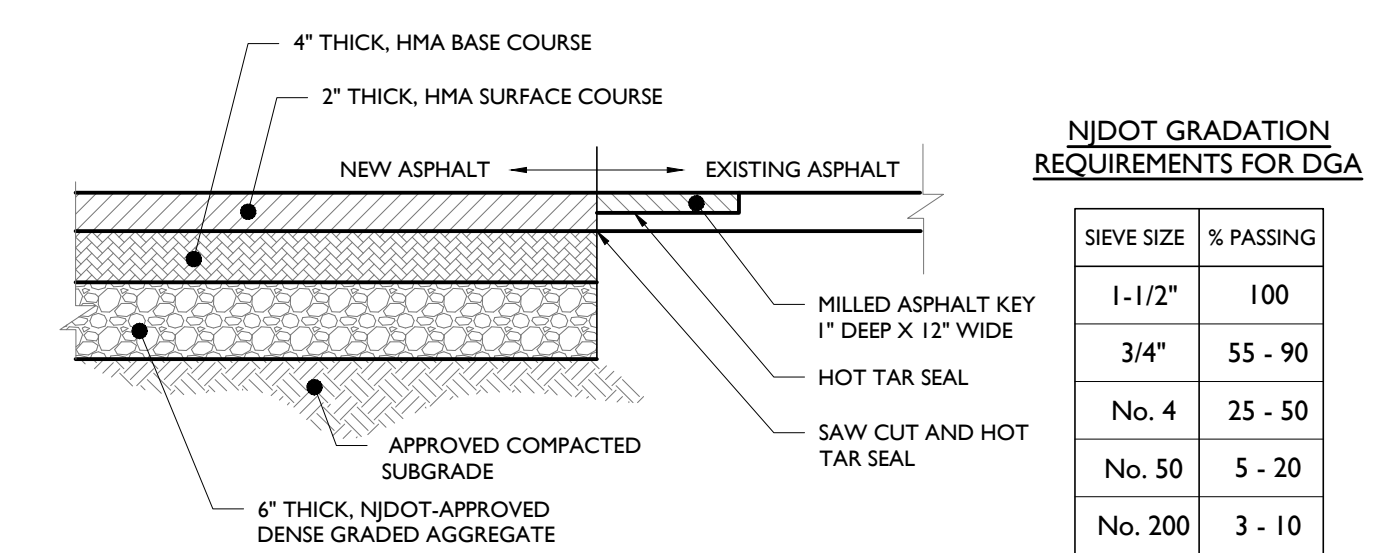

FULL DEPTH ASPHALT PAVEMENT DETAIL

NOT TO SCALE

12

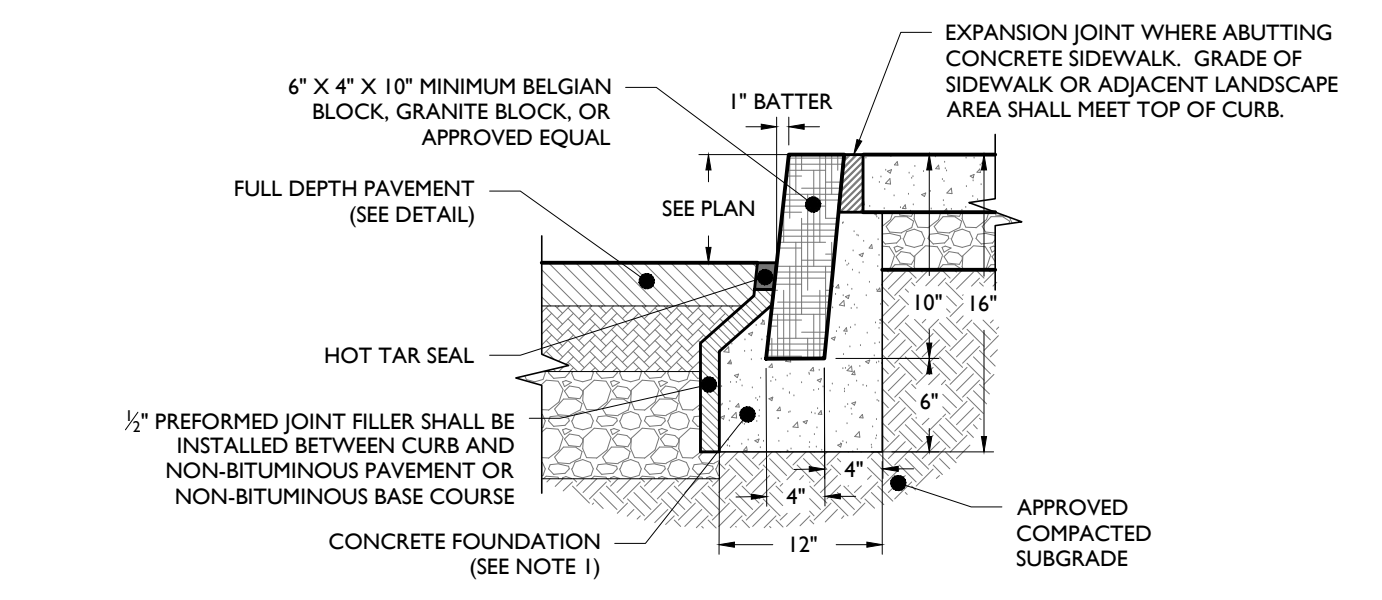

BELGIAN BLOCK CURB DETAIL

NOT TO SCALE

13

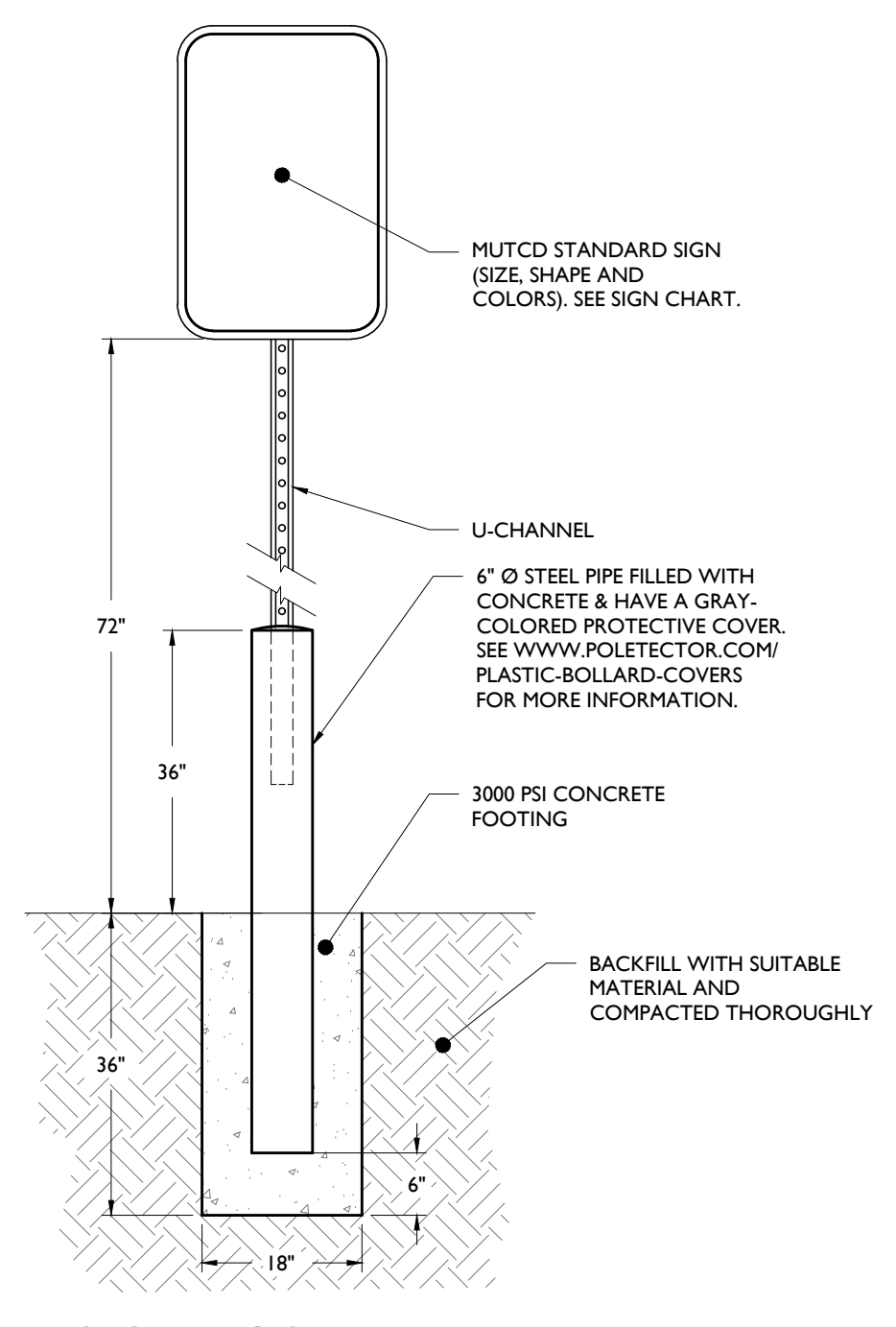

SIGN POST WITH BOLLARD DETAIL

NOT TO SCALE

14

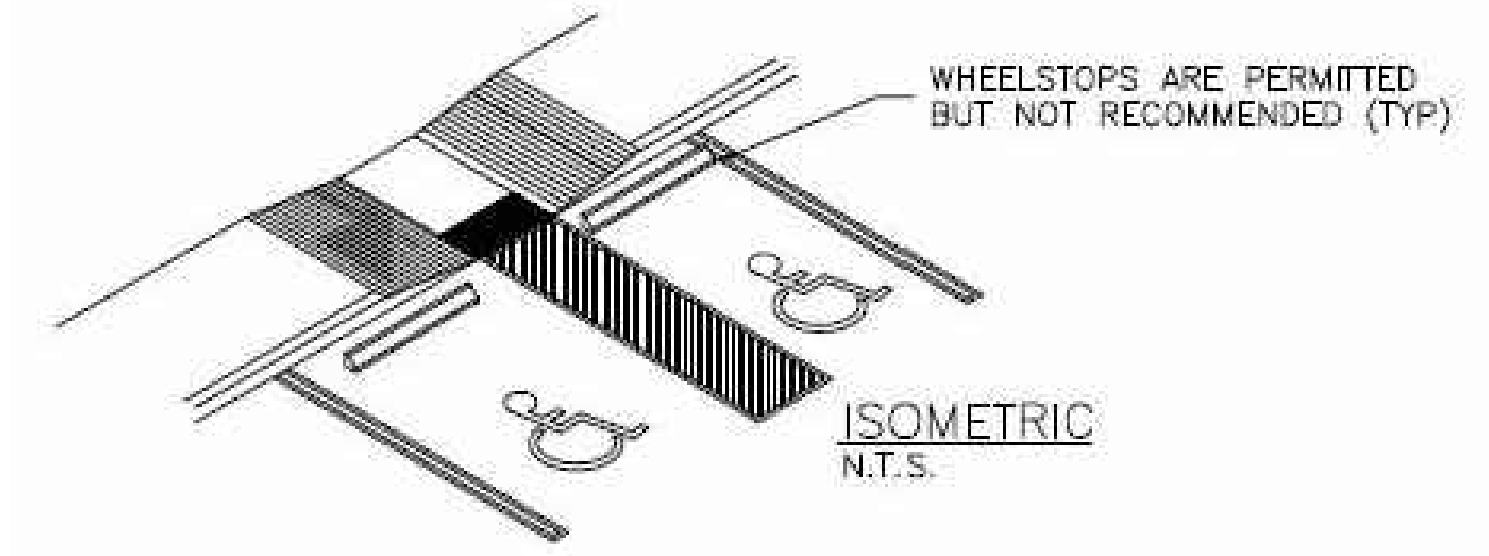

ISOMETRIC N.T.S.

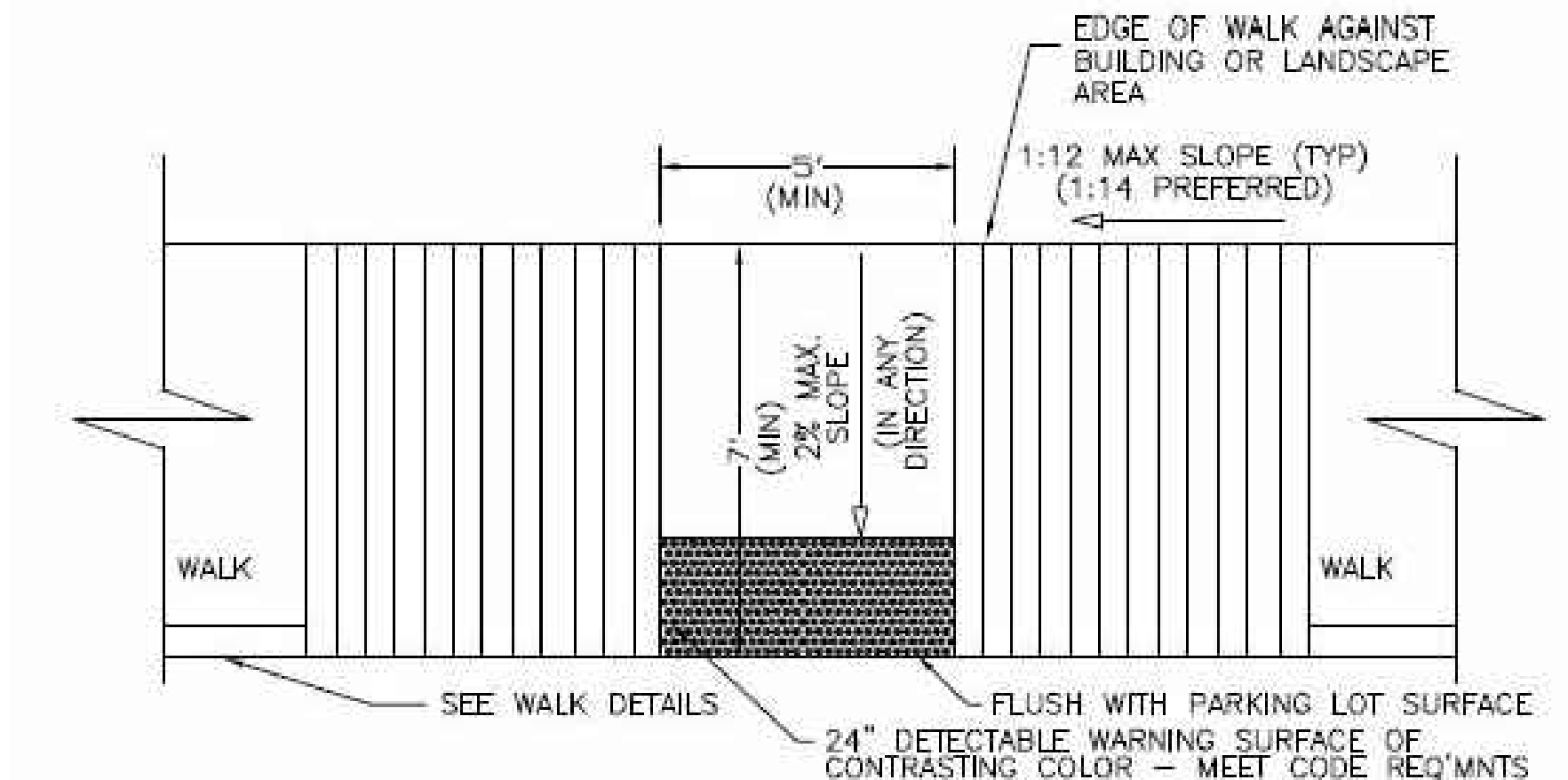

ACCESSIBLE PARKING RAMP DETAIL

NOT TO SCALE

15

NOT APPROVED FOR CONSTRUCTION

STONEFIELD
engineering & design

Rutherford, NJ - Princeton, NJ - Long Island City, NY - Royal Oak, MI
www.stonefielddesign.com
15 Spring Street, Princeton, NJ 08542
Phone 609.362.6900

FINAL MAJOR SITE PLAN
FAST FOOD RESTAURANT WITH DRIVE-THRU FACILITIES

DELSEA DRIVE REDEVELOPMENT NODE 4
BLOCK SHEET #2.04, LOT 6.07
PROJECT NO. 2024-001
101 BLACKWOOD-BARBORO ROAD
TOWNSHIP OF WASHINGTON
GLOUCESTER COUNTY, NJ

JEFFREY A. MARTELL, P.E.
NEW JERSEY LICENSE No. 47290
LICENSED PROFESSIONAL ENGINEER

STONEFIELD
engineering & design

SCALE: N.T.S. PROJECT ID: T-1747

TITLE:
CONSTRUCTION DETAILS

DRAWING:

C-13

P:\2024\T-1747\FOLDER - ROUTE 4 AND GGG HANDBOOK ROAD DEPTFORD, NJ\CD\2024\T-1747\FOLDER 14