

ALL PROPOSED UTILITIES ARE TO BE INSTALLED UNDERGROUND.

SYMBOL	DESCRIPTION
---	PROPERTY LINE
---	PROPOSED SANITARY LATERAL
---	PROPOSED DOMESTIC WATER SERVICE
---	PROPOSED ELECTRICAL/DATA CONDUITS
---	PROPOSED DATA CONDUITS
---	PROPOSED ELECTRIC CONDUITS
---	PROPOSED OVERHEAD WIRES
---	PROPOSED GAS LINE
⊗	PROPOSED VALVE
⊕	PROPOSED WATER TEE / BEND
⊙	PROPOSED FIRE HYDRANT
⊕	PROPOSED FIRE DIRECT CONNECTION (FDC)
⊙	PROPOSED SANITARY MANHOLE / CLEANOUT
⊙	PROPOSED UTILITY POLE
⊕	PROPOSED TRANSFORMER ON CONCRETE PAD WITH BOLLARDS

- DRAINAGE AND UTILITY NOTES**
- THE CONTRACTOR IS REQUIRED TO CALL THE APPROPRIATE AUTHORITY FOR NOTICE OF CONSTRUCTION EXCAVATION AND UTILITY MARK OUT PRIOR TO THE START OF CONSTRUCTION IN ACCORDANCE WITH STATE LAW. CONTRACTOR IS REQUIRED TO CONFIRM THE HORIZONTAL AND VERTICAL LOCATION OF UTILITIES IN THE FIELD. SHOULD A DISCREPANCY EXIST BETWEEN THE FIELD LOCATION OF A UTILITY AND THE LOCATION SHOWN ON THE PLAN SET OR SURVEY, THE CONTRACTOR SHALL NOTIFY STONEFIELD ENGINEERING & DESIGN, LLC IMMEDIATELY IN WRITING.
  - THE CONTRACTOR IS RESPONSIBLE TO PROTECT AND MAINTAIN IN OPERATION ALL UTILITIES NOT DESIGNATED TO BE REMOVED.
  - THE CONTRACTOR IS RESPONSIBLE FOR REPAIRING ANY DAMAGE TO ANY EXISTING UTILITY IDENTIFIED TO REMAIN WITHIN THE LIMITS OF THE PROPOSED WORK DURING CONSTRUCTION.
  - A MINIMUM HORIZONTAL SEPARATION OF 10 FEET IS REQUIRED BETWEEN ANY SANITARY SEWER SERVICE AND ANY WATER LINES. IF THIS SEPARATION CANNOT BE PROVIDED, A CONCRETE ENCASUREMENT SHALL BE UTILIZED FOR THE SANITARY SEWER SERVICE AS APPROVED BY STONEFIELD ENGINEERING & DESIGN, LLC.
  - ALL WATER LINES SHALL BE VERTICALLY SEPARATED ABOVE SANITARY SEWER LINES BY A MINIMUM DISTANCE OF 18 INCHES. IF THIS SEPARATION CANNOT BE PROVIDED, A CONCRETE ENCASUREMENT SHALL BE UTILIZED FOR THE SANITARY SEWER SERVICE AS APPROVED BY STONEFIELD ENGINEERING & DESIGN, LLC.
  - THE CONTRACTOR TO PERFORM A TEST PIT PRIOR TO CONSTRUCTION (RECOMMEND 30 DAYS PRIOR) AT LOCATIONS OF EXISTING UTILITY CROSSINGS FOR WATER AND SANITARY SEWER CONNECTION IMPROVEMENTS. SHOULD A CONFLICT EXIST, THE CONTRACTOR SHALL IMMEDIATELY NOTIFY STONEFIELD ENGINEERING & DESIGN, LLC IN WRITING.
  - THE CONTRACTOR IS RESPONSIBLE FOR COORDINATING GAS, ELECTRIC AND TELECOMMUNICATION CONNECTIONS WITH THE APPROPRIATE GOVERNING AUTHORITY.
  - CONTRACTOR SHALL START CONSTRUCTION OF ANY SANITARY SEWER AT THE LOWEST INVERT AND WORK UP GRADIENT.
  - THE CONTRACTOR IS RESPONSIBLE TO MAINTAIN A RECORD SET OF PLANS REFLECTING THE LOCATION OF EXISTING UTILITIES THAT HAVE BEEN CAPPED, ABANDONED, OR RELOCATED BASED ON THE DEMOLITION/REMOVAL ACTIVITIES REQUIRED IN THIS PLAN SET. THIS DOCUMENT SHALL BE PROVIDED TO THE OWNER FOLLOWING COMPLETION OF WORK.
  - THE CONTRACTOR IS RESPONSIBLE TO MAINTAIN A RECORD OF THE AS-BUILT LOCATIONS OF ALL PROPOSED UNDERGROUND INFRASTRUCTURE. THE CONTRACTOR SHALL NOTE ANY DISCREPANCIES BETWEEN THE AS-BUILT LOCATIONS AND THE LOCATIONS DEPICTED WITHIN THE PLAN SET. THIS RECORD SHALL BE PROVIDED TO THE OWNER FOLLOWING COMPLETION OF WORK.

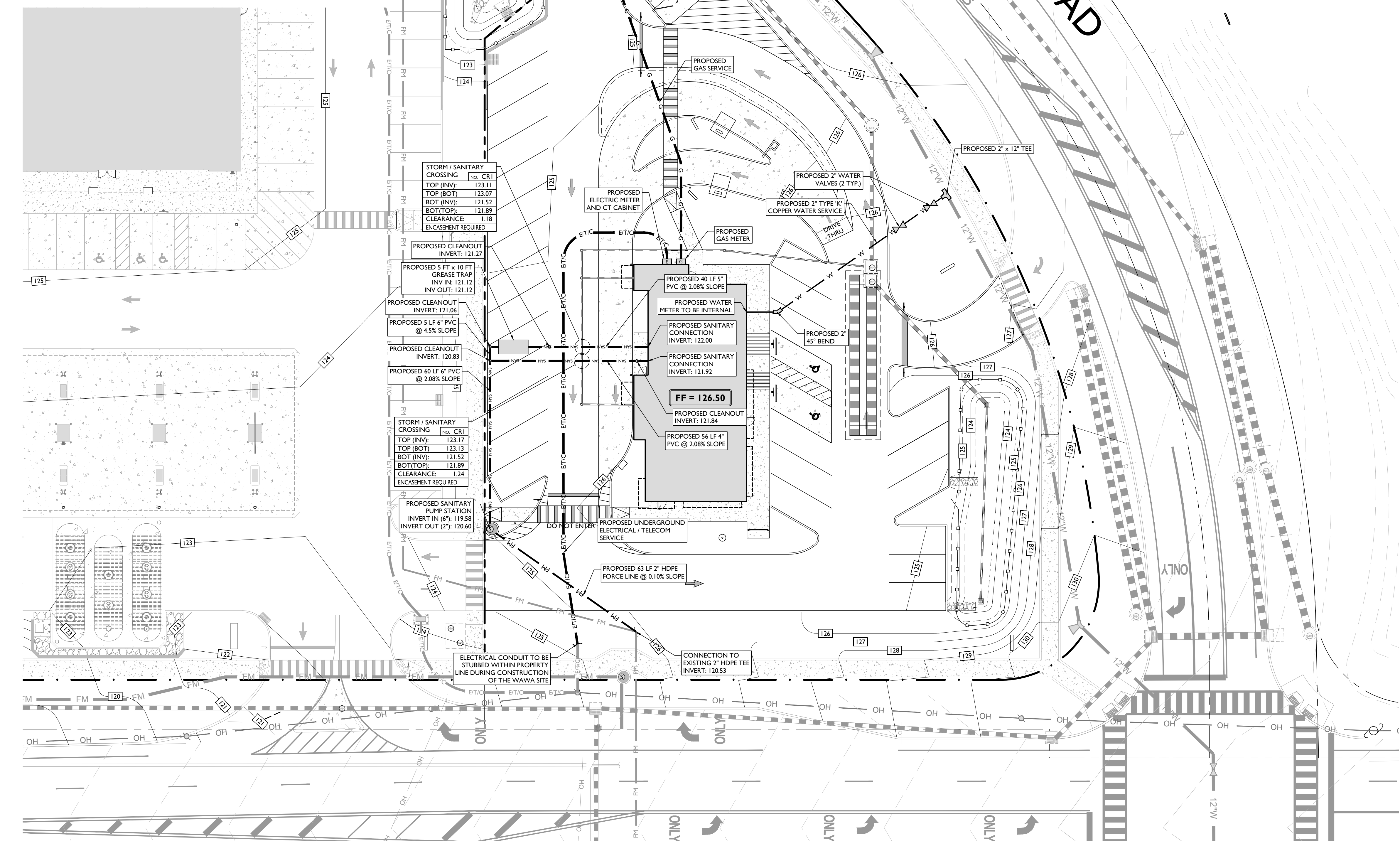
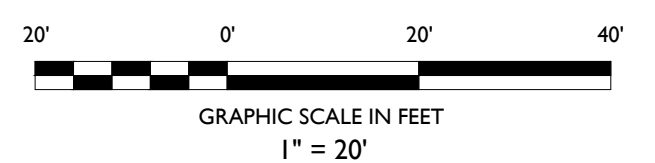

FOR TENANT REVIEW	JCL	04/08/2022	03	02	01	06/11/2021	JMK	BY	DATE	ISSUE	DESCRIPTION
FOR RESOLUTION COMPLIANCE	JCL	03/17/2022	02	01	06/11/2021	JMK	BY	DATE	ISSUE	DESCRIPTION	

**NOT APPROVED FOR CONSTRUCTION**

**STONEFIELD**  
engineering & design

Rutherford, NJ - Princeton, NJ - Long Island City, NY - Royal Oak, MI  
www.stonefielddesign.com

15 Spring Street, Princeton, NJ 08542  
Phone 609.362.6900

**FINAL MAJOR SITE PLAN**  
**FAST FOOD RESTAURANT WITH DRIVE-THRU FACILITIES**

DELSEA DRIVE REDEVELOPMENT NODE 4  
PROJECT SHEET #2 OF 4, LOT 6.07  
101 BLACKWOOD-BARNSBORO ROAD  
TOWNSHIP OF WASHINGTON  
GLOUCESTER COUNTY, NJ

JEFFREY A. MARTELL, P.E.  
NEW JERSEY LICENSE No. 47290  
LICENSED PROFESSIONAL ENGINEER

**STONEFIELD**  
engineering & design

SCALE: 1" = 20' PROJECT ID: T-1747

TITLE:  
**UTILITY PLAN**

DRAWING:  
**C-7**