

Issued:	Date:
A BKC Approval	10/29/2021
B Permit Set	1/28/2022
C Bid Set	4/25/2022
D	
E	

Revisions:	Date:
1	
2	
3	
4	
5	
6	
7	
8	
9	

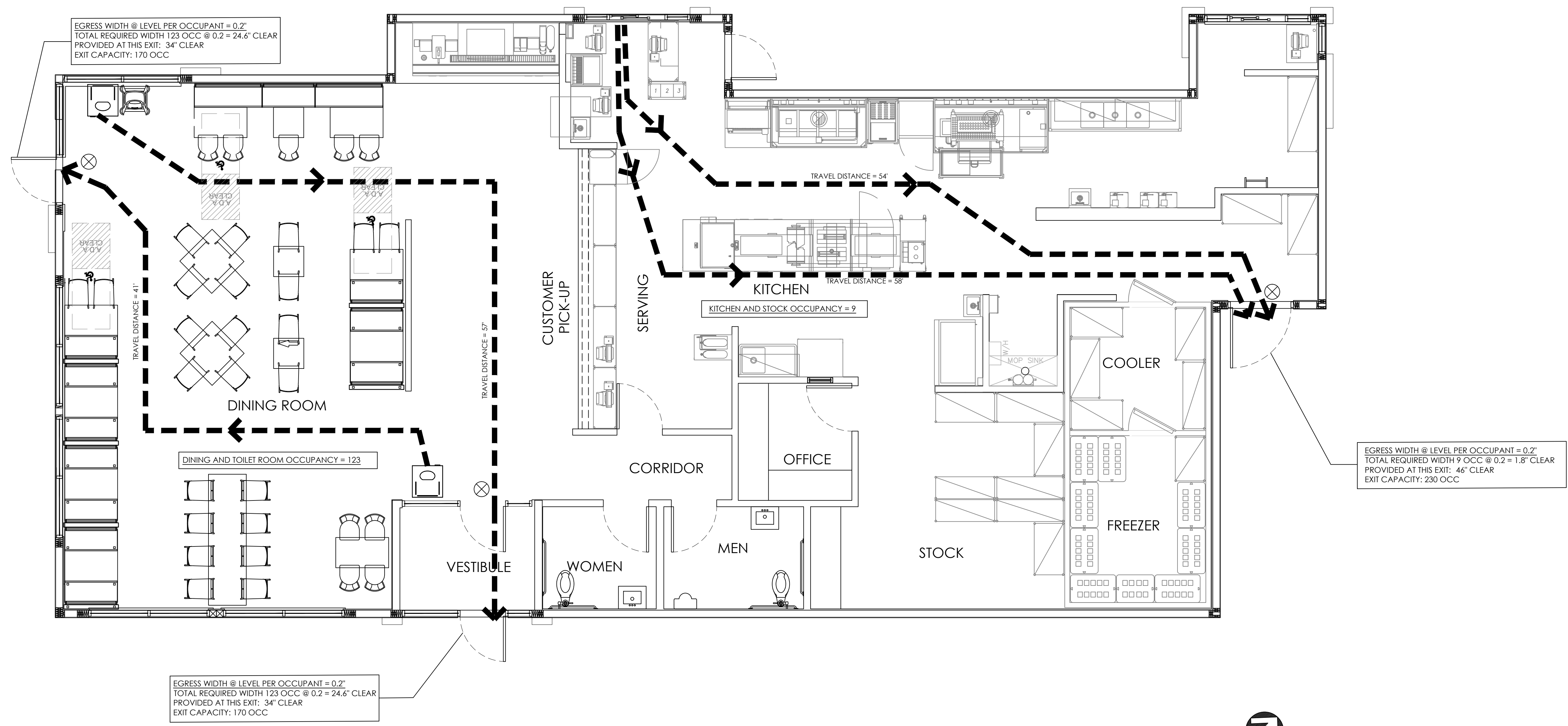
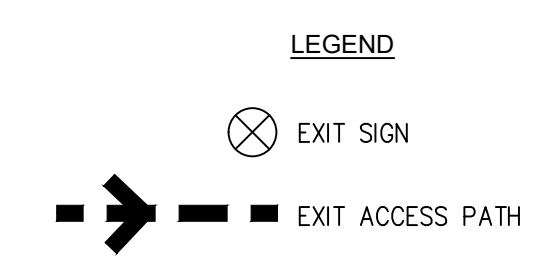

Seal Seal
PROJECT ARCHITECT/ENGINEER DATE

PROJECT LEAD DATE
M. Verrastro DATE
PROJECT DESIGNER DATE

Copyright © 2022
APD Engineering & Architecture, LLC

Drawing Alteration
It is a violation of law for any person, unless acting under the direction of a licensed Architect, Professional Engineer, Landscape Architect, or Land Surveyor to alter any item on this document in any way. Any licensee who alters this document is required by law to affix his or her seal and to add the notation "Altered By" followed by his or her signature and the specific description of the alteration or revision.

DO NOT SCALE PLANS
Copying, Printing, Software and other processes required to produce these prints can stretch or shrink the actual paper or layout. Therefore, scaling of this drawing may be inaccurate. Contact APD E&A with any need for additional dimensions or clarifications.

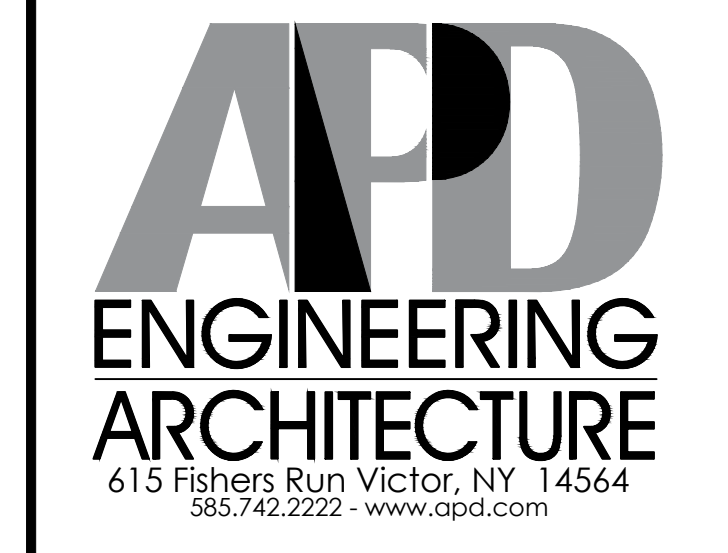

Burger King Inc.
Store # 30011
108 Egg Harbor Road
Sewell, NJ 08080
Gloucester County
Project Name & Location:

Life Safety Plan

Drawing Name: Project No.
Date: 11/8/2021 21-0458
Type: BK ROC-60
Drawn By: MGV LSP
Scale: As Noted Drawing No.