

THE IDEAS AND DESIGN CONCEPTS EXPRESSED HEREIN AND THE GRAPHICALLY DISPLAYED ARRANGEMENT OF THEIR COMPONENTS REPRESENTED BY THIS DRAWING HAVE BEEN DEVELOPED FOR THE EXCLUSIVE USE OF THE SPECIFIED PROJECT AND ARE THE SOLE PROPERTY OF JMP Design + Build, Inc. INCORPORATED. A CONVEYANCE OR DISCLOSURE OF THE IDEAS DESIGN CONCEPTS OR USE OF ANY GRAPHICALLY DISPLAYED ARRANGEMENTS OF THE COMPONENTS SHALL BE AT THE DISCRETION AND ONLY THROUGH THE EXPRESSED WRITTEN CONSENT OF JMP Design + Build, Inc. ALL MATERIALS HEREIN ARE PROPRIETARY AND COPYRIGHTED ARCHITECTURAL SEAL

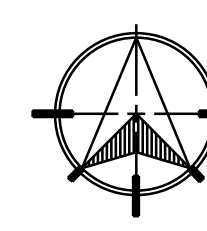
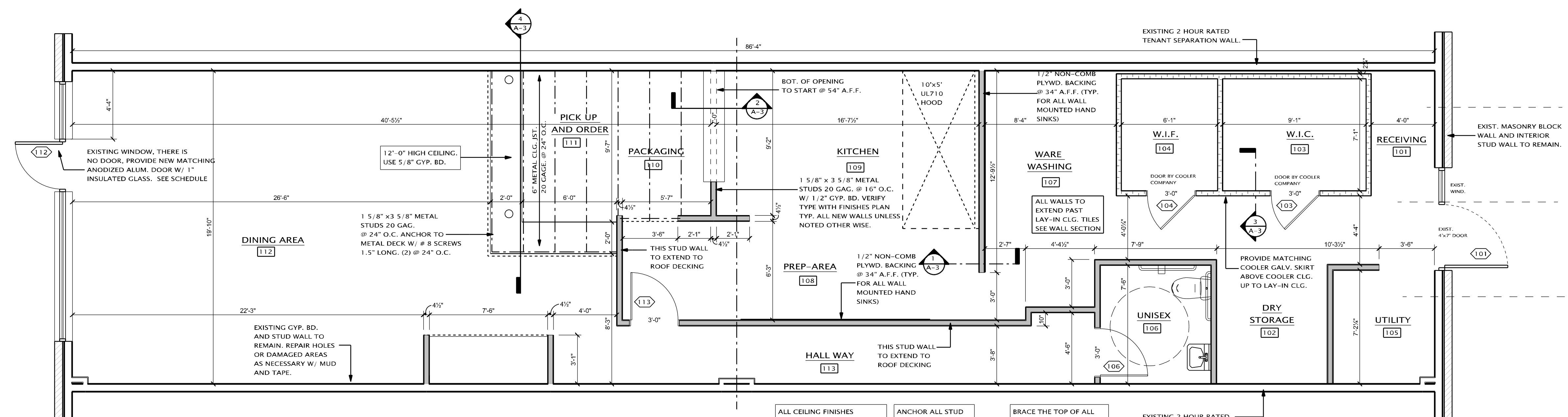

**FRAMING PLAN**

SCALE: 1/4" = 1'-0"

- ALL CEILING FINISHES SHALL BE 2x4 WHITE VINYL CEILING TILE W/ WHITE GRID IN ALL AREAS EXCEPT DINING AND HALLWAY.
- ANCHOR ALL STUD WALLS TO CONC. W/ RAMSET MASONRY ANCHORS @ 32" O.C.
- BRACE THE TOP OF ALL WALLS. USE 3 5/8" METAL STUD, @ 6'-0" O.C. AND ALL CORNERS.

INTERIOR WALL & CEILING FINISH REQUIREMENTS BY OCCUPANCY			
NON -SPRINKLE			
GROUP	EXIT ENCLOSURES & EXIT PASSAGEWAYS	CORRIDORS	ROOMS & ENCLOSED SPACES
A-2	B	B	C
	FLAME-SPREAD 26-75 SMOKE DEVELOPED 0-450	FLAME-SPREAD 26-75 SMOKE DEVELOPED 0-450	FLAME-SPREAD 76-200 SMOKE DEVELOPED 0-450

WALL LEGEND	
	EXISTING 8" MASONRY WALL
	EXISTING 2-HOUR RATED FIRE WALL
	EXISTING 1 5/8" x 3 5/8" METAL STUDS 20 GAG. @ 16" O.C. W/ 1/2" GYP. BRD.
	EXISTING WALK-IN COOLER WALL
	NEW 1 5/8" x 3 5/8" METAL STUDS 20 GAG. @ 16" O.C. W/ 1/2" GYP. BRD.
	EXISTING 1 5/8" x 3 5/8" METAL STUDS 20 GAG. @ 16" O.C. W/ 1/2" GYP. BRD. TO BE REMOVED

DOOR SCHEDULE															
		DOOR				FRAMING				FIRE RATING		HARDWARE			
MARK	QTY.	GLASS	WIDTH	HEIGHT	THICK	MATERIAL	FINISH	MATERIAL	FINISH	HEAD	JAMB	SILL	LABEL	HOUR	HARDWARE
101	1	N/A	3'-0"	7'-0"	1 3/4"	EXIST. METAL-INSULATED CORE	EXISTING PAINTED	EXIST. METAL	EXIST. PAINTED	2"	4"	N/A	--	--	(ALL EXIST) 3 HINGES, THUMB TURN/ KEYS LOCK LATCH HANDLE, SELF CLOSER, DOOR SWEEP
103	1	N/A	3'-0"	7'-0"	3"	INSULATED STAINLESS STEEL COOLER DOOR	STAINLESS STEEL	STAINLESS STEEL	STAINLESS STEEL	2"	2"	N/A	--	--	PIANO HINGE, LATCH SET, SELF CLOSER, DOOR SWEEP
104	1	N/A	3'-0"	7'-0"	3"	INSULATED STAINLESS STEEL COOLER DOOR	STAINLESS STEEL	STAINLESS STEEL	STAINLESS STEEL	2"	2"	S.S. RAMP	--	--	PIANO HINGE, LATCH SET, SELF CLOSER, DOOR SWEEP, S.S. RAMP THRESHOLD
105	1	N/A	3'-0"	7'-0"	1 3/4"	PRE-FAB SOLID CORE BIRCH VENEER FINISH	STAINED (VERIFY COLOR W/ FRANCHISE)	READY FRAME LIGHT GAG.METAL	PRE-FIN. PAINT DARK BRONZE	2"	2"	N/A	--	--	3 HINGE, LATCH SET SELF CLOSER, KICK PLATE, INTERIOR DOOR
106	1	N/A	3'-0"	7'-0"	1 3/4"	PRE-FAB SOLID CORE BIRCH VENEER FINISH	STAINED (VERIFY COLOR W/ FRANCHISE)	READY FRAME LIGHT GAG.METAL	PRE-FIN. PAINT DARK BRONZE	2"	2"	N/A	--	--	3 HINGE, LATCH SET W/ PUSH LOCK SELF CLOSER, KICK PLATE, INTERIOR DOOR
112	1	INSUL	3'-0"	7'-0"	1 3/4"	EXIST. ANODIZED ALUM.	EXIST. BLACK ANODIZED	EXIST. ALUMINUM	EXISTING BLACK ANODIZED	2"	2"	N/A	--	--	(ALL EXIST) 3 HINGES, THUMB TURN/ KEYS LOCK LATCH HANDLE, SELF CLOSER, DOOR SWEEP
113	1	1"	3'-2"	7'-0"	1 3/4"	PRE-FAB STAINLESS STEEL	PRE-FAB STAINLESS STEEL	METAL	PRE-FIN. PAINT	2"	2"	N/A	--	--	(ZESCO) PIVOT HARDWARE S.S. PUSH PLATE, S.S. KICK PLATE, DOOR SWEEP 9"x14" CLEAR ACRYLIC WINDOW, WRAPPED IN NOTTY PINE

**HARDWARE HEIGHTS**  
 DOOR HANDLES, PULLS, LATCHES, LOCKS SHALL BE AT 34" MIN. TO 48" MAXIMUM A.F.F.

**EGRESS DOORS:**  
 EGRESS DOORS SHALL HAVE PANIC HARDWARE ON INTERIOR SIDE

- ACTUATING PORTION OF THE RELEASING DEVICE SHALL EXTEND AT LEAST ONE-HALF OF THE DOOR LEAF.
- THE MAXIMUM UNLATCHING FORCE SHALL NOT EXCEED 15 LBS.
- THE DOORS SHALL ONLY BE LOCKABLE FROM EXTERIOR SIDE, THE DOOR SHALL ALWAYS BE ABLE TO OPEN FROM INTERIOR SIDE OF BUILDING.
- ALL EXTERIOR DOOR HANDLES W/ LOCK SETS SHALL BE INTERCONNECTED TO THE PANIC HARDWARE.

**GENERAL NOTES:**

- ALL HARDWARE SHALL COMPLY WITH APPLICABLE REQUIREMENTS OF THE AMERICANS WITH DISABILITIES ACT (ADA)
- ALL DOOR HARDWARE SHALL BE FINISH USD26D OR EQUIVALENT.
- ALL LATCHSETS AND LOCKSETS SHALL BE EQUIPPED WITH LEVER TYPE OPERATING TRIM.
- ALL CLOSERS SHALL BE LOCATED ON ROOM SIDES OF DOORS.
- CONTRACTOR'S HARDWARE CONSULTANT SHALL BE RESPONSIBLE FOR DETERMINING APPROPRIATE HARDWARE FUNCTION AND OPTIONS.
- CONTRACTOR SHALL COORDINATE FINAL KEYING WITH OWNER. ALL LOCKS SHALL BE MASTERKEYED TO SOBH PROPERTIES.

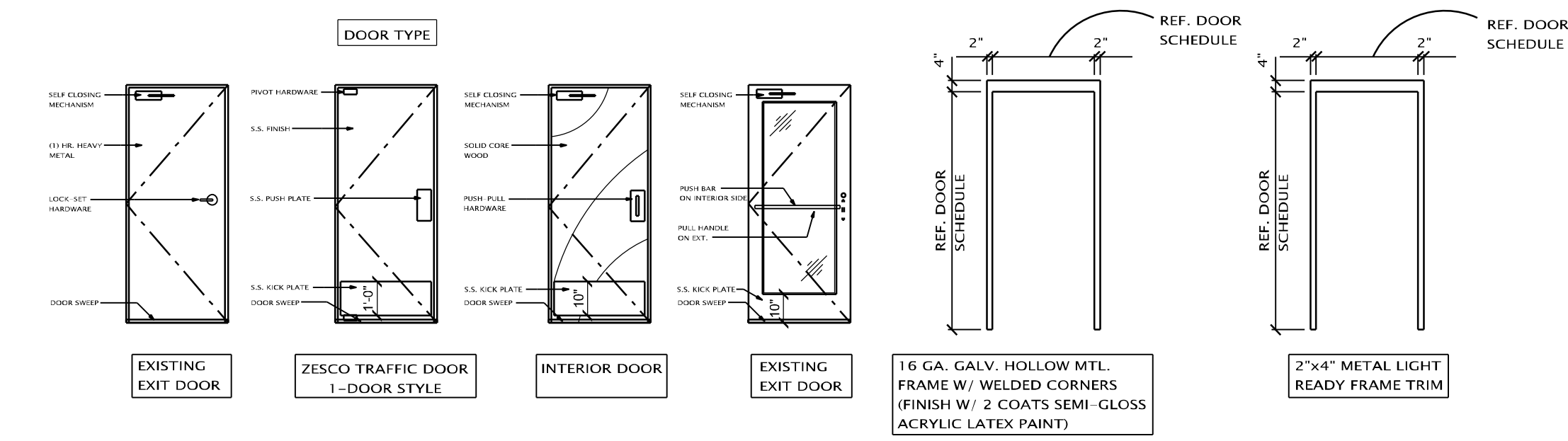

**LOCKS & LATCHES**  
 ALL MEANS OF EGRESS DOORS SHALL BE READILY OPENABLE FROM THE SIDE FROM WHICH EGRESS IS TO BE MADE WITHOUT THE USE OF A KEY OR SPECIAL KNOWLEDGE OR EFFORT.

**DOOR ACCESSIBILITY**  
 ALL DOOR MUST BE A MIN. CLEAR OPENING OF 32" ALSO THERE MUST BE 18" MIN. CLEARANCE DISTANCE ON PULL SIDE OF DOOR AND 12" CLEARANCE DISTANCE ON PUSH SIDE OF DOOR.

LEGEND	
GL	GLASS
HM	HOLLOW METAL
WD	WOOD
STL	STEEL
AL	ALUMINUM
MFR	PER MANUFACTURER
EL	EXTERIOR LOCKSET
LK	INTERIOR LOCKSET
SCW	SOLID CORE WOOD
CWB	GYP-SUM WALL BOARD

TYP. DOOR LOCATION PLAN FOR ALL DOORS LOCATED ON PLAN	

PROJECT

WING SNOB  
 3415 S. AGINAW SUITE D  
 LANSING, MI 48912

BUILDER/CLIENT  
 WING SNOB

PRELIMINARY ○  
 CONSTRUCTION ●  
 PERMIT ●

SHEET TITLE:  
**FRAMING PLAN**  
 EXISTING/DEMO PLAN

DATE: 01-17-2022  
 02-28-2022  
 03-03-2022

DRAWN BY:  
**J.M.P.**

CHECKED BY:  
**J.M.P.**

JOB NUMBER:  
**22 - 110**

SHEET NUMBER:  
**A-1**