

PAINT SCHEDULE

Table with columns: COLOR, SHERWIN WILLIAMS, PPG, BENJAMIN MOORE. Rows include EX-1 (WENDY'S DARK BRONZE), EX-2 (RED), EX-3 (PRE-FINISHED- DARK BRONZE), etc.

Table with columns: BASE, SHEEN, SHERWIN WILLIAMS, PPG, BENJAMIN MOORE. Rows include STUCCO / EPS SATIN, METAL RAILING SEMI-GLOSS, WOOD SATIN, etc.

Table with columns: COLOR, SHERWIN WILLIAMS, PPG, BENJAMIN MOORE. Rows include P-1 (BEIGE - EGG SHELL), P-2 (RED - EGG SHELL), P-3 (CEILING WHITE - FLAT), etc.

Table with columns: BASE, SHEEN, SHERWIN WILLIAMS, PPG, BENJAMIN MOORE. Rows include GYPSUM BOARD EGG SHELL, METAL DECK FLAT, WOOD DECK FLAT, etc.

JOINT TREATMENT SCHEDULE

(SEE SPECIFICATIONS - DIVISION 7 FOR CLARIFICATION OF TYPES)

Table with columns: EXT. INT., CONDITION, TYPE. Rows include PERIMETER JOINTS OF DOOR FRAMES, MASONRY / CONCRETE CONTROL JOINTS IN WALLS, etc.

JOINT TREATMENT NOTES
A. THE JOINT TREATMENT SCHEDULE IS INTENDED TO ILLUSTRATE ALL JOINT CONDITIONS WHICH ARE MEANT TO BE SEALED WHETHER REFERENCED FROM OTHER DETAILS OR NOT.

GENERAL FLASHING REQUIREMENTS

- A. PROPERLY WEEP FLASHING POINTS AND NORMAL DRAINAGE POINTS WITH WEEPS @ 1/4" O.C. MAX. SPACING. WEEP POINTS ARE TO BE LOCATED DIRECTLY ON TOP OF FLASHING.
B. WHERE FLASHING IS LOCATED TERMINATE AND/OR SEPARATES MATERIALS, DO NOT SEAL (U.N.O.) - REFER TO DIAGRAM 'C' WHERE IT IS DETERMINED BY THE MATERIAL MANUFACTURER OR OTHERWISE THAT SEALING IS REQUIRED...

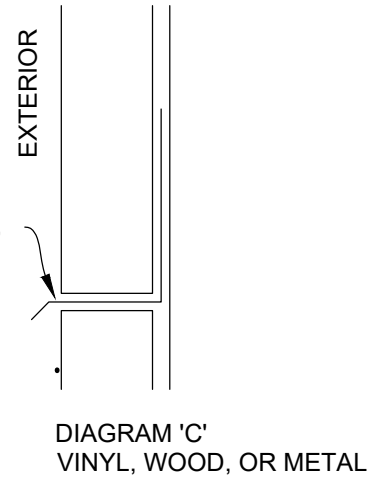

BLDG. INSULATION SCHED.

Table with columns: DESCRIPTION, THICKNESS (TOTAL R-VALUE), LOCATION. Rows include RIGID PERIMETER FOUNDATION INSULATION (EXTRUDED POLYSTYRENE), BATT INSULATION, FIBERGLASS BATT INSULATION (FOIL FACE FSK-25), RIGID ROOF INSULATION (POLYISOCYANURATE), SOUND ATTENUATION BATT INSULATION.

BUILDING INSULATION GENERAL NOTES

A. INSULATION LOCATIONS SHOWN IN SCHEDULE ARE INTENDED ONLY FOR CLARIFICATION PURPOSES AND ARE NOT INTENDED TO BE ALL-ENCOMPASSING. PROVIDE EACH INSULATION TYPE AS REQUIRED TO FULLY MAINTAIN THE THERMAL INTEGRITY OF THE CONSTRUCTION ASSEMBLIES RELATED TO THE ENTIRE BUILDING ENVELOPE.

EXTERIOR FURNITURE SCHEDULE

Table with columns: SYMBOL, DESCRIPTION, PRODUCT INFO, 8/21/2020. Rows include PATIO TABLE AND CHAIRS, PATIO TABLE AND CHAIRS, PATIO TABLE AND CHAIRS, PATIO UMBRELLA, PATIO UMBRELLA, PATIO UMBRELLA, PATIO TRASH RECEPTACLE, PATIO TRASH RECEPTACLE, PATIO TRASH RECEPTACLE, PATIO RAILING, PATIO ACCESSORIES.

Table with columns: SITE NUMBER, BUILDING TYPE, ASSET TYPE, CLASSIFICATION, OWNER, BASE VERSION, UPGRADE CLASSIFICATION, PROJECT YEAR, DESIGN TYPE, DRAWING RELEASE.

Linear Architecture LLC
MARC BRUNDIGE
Architect
4436 Harvest Hill Rd.
Dallas, TX 75244
PHONE: 972.929.9226



STARBOARD GROUP
12540 W. ATLANTIC BLVD.
CORAL SPRINGS, FL 33071
OFFICE: (954)255-2266

Wendy's
#05341 (STARBOARD #702)
2 CIETAN PLAZA
BARRY, IL 62312

Table with columns: REV., DATE, DESCRIPTION. Rows include 1, 2, 3, 4, 5, 6, 7, 8, 9, 10.

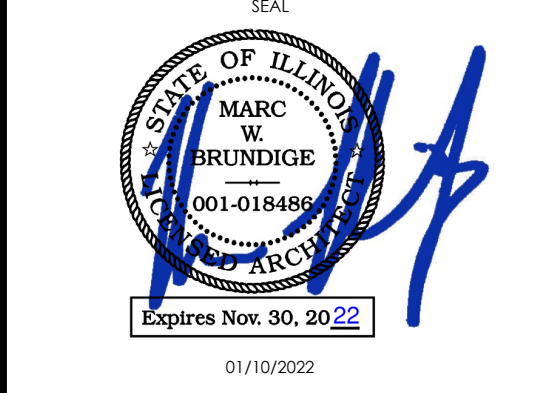

SHEET NAME
PAINT, TILE, BLDG INSULATION, & JOINT TREATMENT SCHEDULE

SHEET NUMBER
A6.1

11/02/2022 8:08 PM C:\Users\linc\OneDrive - Linear Architecture - Local\Public\Wendy's - Starboard\Construction Documents\05\_Schedules.dwg linpo