

11/3/2022, 8:57 PM, C:\Users\chris\OneDrive - Linear Architecture, Inc\Desktop\WENDYS\21-128 Starboard 702-05341 Barry, IL (R)Arch, Remodel\Construction Documents\203_A1.2_REFLECTED CEILING PLAN.dwg, linop

| GENERAL NOTES | |
|---------------|---|
| 1. | HOLD DOWN CLIPS SHALL BE PROVIDED FOR ALL CEILING TILES IN THE VESTIBULES. |
| 2. | SEE INTERIOR FINISH SCHEDULE FOR CEILING TILE. |
| 3. | DO NOT SCREW THE CEILING GRID TO THE STAINLESS STEEL HOODS. USE DOUBLE-FACED TAPE. |
| 4. | REFER TO ELECTRICAL AND/OR HVAC DRAWINGS FOR ADDITIONAL INFORMATION REGARDING ALL FIXTURES, DEVICES AND EQUIPMENT SHOWN ON THIS PLAN. |
| 5. | VERIFY EXISTING MUSIC SYSTEM IN DINING ROOM. COORDINATE REQUIREMENTS WITH WENDY'S REP. |
| 6. | VERIFY EXISTING WIFI SYSTEM. COORDINATE REQUIREMENTS WITH WENDY'S REP. |

| | |
|-------------------------|-----------------|
| SITE NUMBER: | 05341 |
| BUILDING TYPE: | CG3480 |
| ASSET TYPE: | FREESTANDING |
| CLASSIFICATION: | REFRESH LT |
| OWNER: | STARBOARD |
| BASE VERSION: | 2021 SPRING |
| UPGRADE CLASSIFICATION: | N/A |
| PROJECT YEAR: | 2022 |
| DESIGN TYPE: | (2.0) UM BRIGHT |
| DRAWING RELEASE: | 2021 SPRING |

| LEGEND | | | |
|--------|---|--|---|
| | FLUORESCENT LIGHTING FIXTURE | | HANGING LIGHT FIXTURE |
| | NEW CEILING GRID AND NEW ACT (CT-2) | | RECESSED OR WALL WASH CAN LIGHT FIXTURE |
| | (E) CEILING GRID AND NEW ACT (CT-2) (DESIGNATED BY HALF-TONE) | | WALL MOUNTED LIGHT FIXTURE |
| | NEW WASHABLE SUSPENDED ACOUSTICAL CEILING TILE, CT-4 | | SUSPENDED COMMUNITY FIXTURE |
| | EXIT LIGHT FIXTURE | | PENDANT LIGHT FIXTURE |
| | CEILING MOUNTED LIGHT TRACK | | SUPPLY AIR DIFFUSER |
| | CEILING RECESSED EMERGENCY FLOOD LIGHT | | RETURN AIR DIFFUSER |
| | EXTERIOR REMOTE EMERGENCY FLOOD LIGHT | | CEILING SPEAKER |

Linear Architecture LLC
MARC BRUNDIGE
 Architect
 4436 Harvest Hill Rd.
 Dallas, TX 75244
 PHONE: 972.929.9226



STARBOARD GROUP
 12540 W. ATLANTIC BLVD.
 CORAL SPRINGS, FL 33071
 OFFICE: (954)255-2266

NOTE:
 ALL FIXTURES TO BE PROVIDED BY ELECTRICAL CONTRACTOR UNLESS OTHERWISE NOTED. ELECTRICAL CONTRACTOR TO VERIFY COLOR SCHEME BEFORE PLACING ORDER.

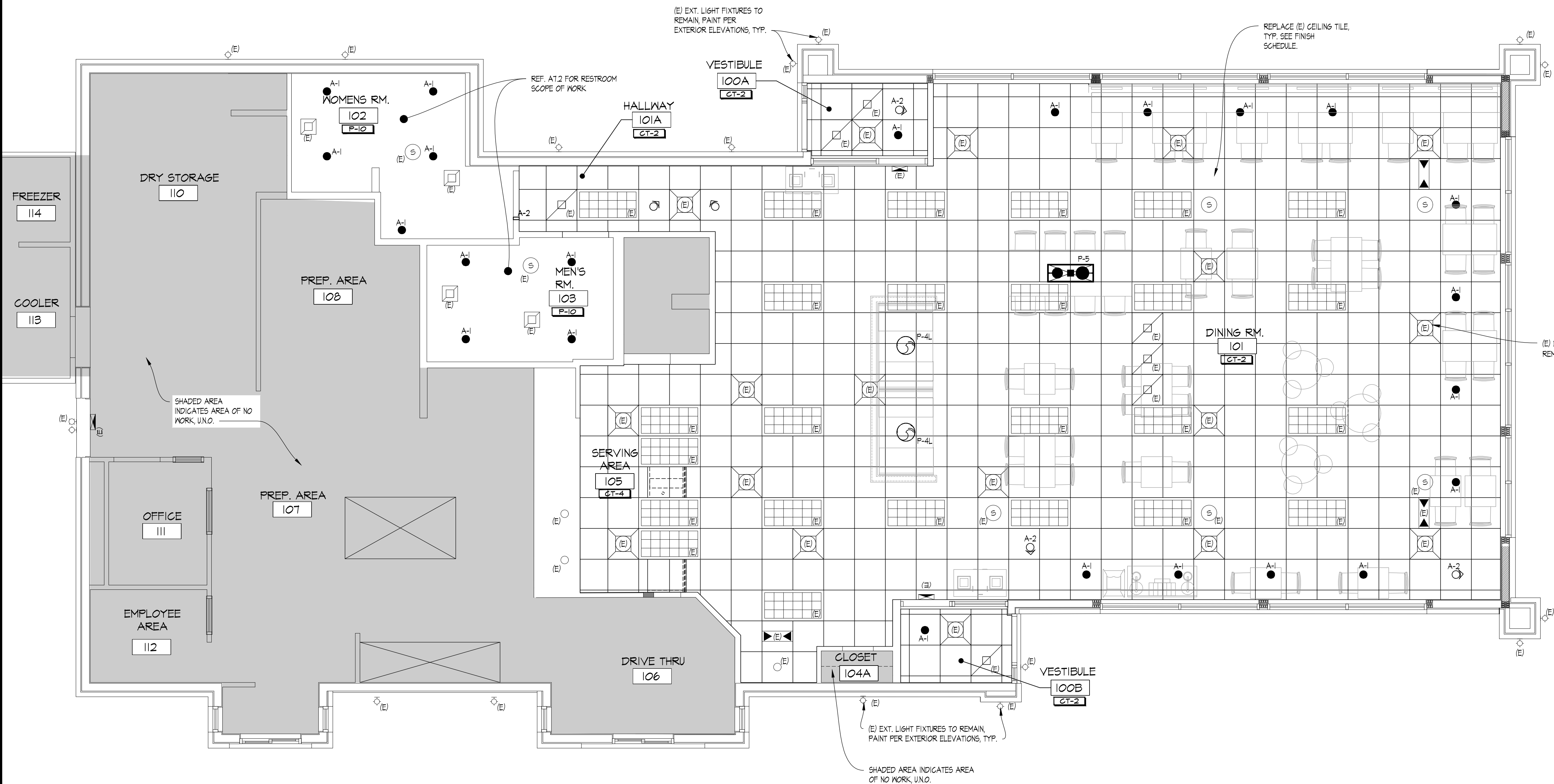

Wendy's

#05341 (STARBOARD #702)
 2 CIETEN PLAZA
 BARRY, IL 62312

| REV. | DATE | DESCRIPTION |
|------|------|-------------|
| | | |
| | | |
| | | |
| | | |



SHEET NAME
REFLECTED CEILING PLAN

SHEET NUMBER
A1.2

01 REFLECTED CEILING PLAN
 SCALE: 1/4" = 1'-0"