

**KEY NOTES**

- 1 REMOVE EXISTING BOLLARD.
- 2 EXISTING PYLON SIGN. PAINT POLE BLACK, READERBOARD CABINET BLACK, AND SIGN CABINET SILVER. COORDINATE WITH OWNER FOR ADDITIONAL SCOPE OF WORK TO REPAIR OR REPLACE SIGN FACES.
- 3 PROVIDE NEW CLEARANCE BAR, REFER TO SIGN VENDOR FOR DETAILS.
- 4 NEW DIGITAL MENUBOARD, REFER TO VENDOR DRAWINGS. PROVIDE 6" CONCRETE FILLED PIPE BOLLARD ON APPROACH OF NEW MENUBOARD, COORDINATE WITH OWNER.
- 5 PROVIDE NEW OCU WITH CANOPY AND FOUNDATION AS SHOWN ON DETAILS ON ASI.2.
- 6 EXISTING PREVIEW BOARD TO REMAIN. PAINT FRAME AND CABINET BLACK. LANDSCAPE CONTRACTOR TO INSTALL NEW DECORATIVE MASONRY RETAINING BLOCK BASE AND FILL WITH MULCH AT EXISTING MENU BOARD SIGN BASE.



**CURRAN**  
ARCHITECTURE

5719 LAWTON LOOP E. DR. #212  
INDIANAPOLIS, IN 46216  
O :: 317.288.0681  
F :: 317.288.0753



**GPS**  
HOSPITALITY

2100 RIVEREDGE PARKWAY  
SUITE 850  
ATLANTA, GA 30328  
O :: 770.933.5023  
F :: 770.933.5024

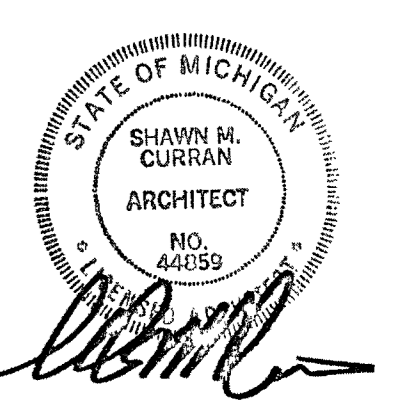

THIS DRAWING AND THE IDEAS, DESIGNS AND CONCEPTS CONTAINED HEREIN ARE THE EXCLUSIVE INTELLECTUAL PROPERTY OF CURRAN ARCHITECTURE AND ARE NOT TO BE USED OR REPRODUCED, WHOLE OR IN PART, WITHOUT THE WRITTEN CONSENT OF CURRAN ARCHITECTURE.  
© COPYRIGHT 2021, CURRAN ARCHITECTURE

REMODEL TO:  
BURGER KING #13694  
2029 S. SAGINAW RD.  
MIDLAND, MI 48640

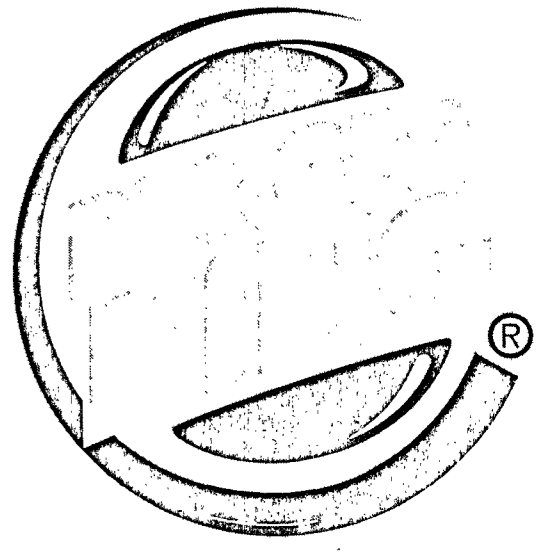

FOR CONSTRUCTION	06-25-2021

PROJECT NUMBER: 190379  
ARCHITECTURAL  
SITE PLAN  
**ASI.1**

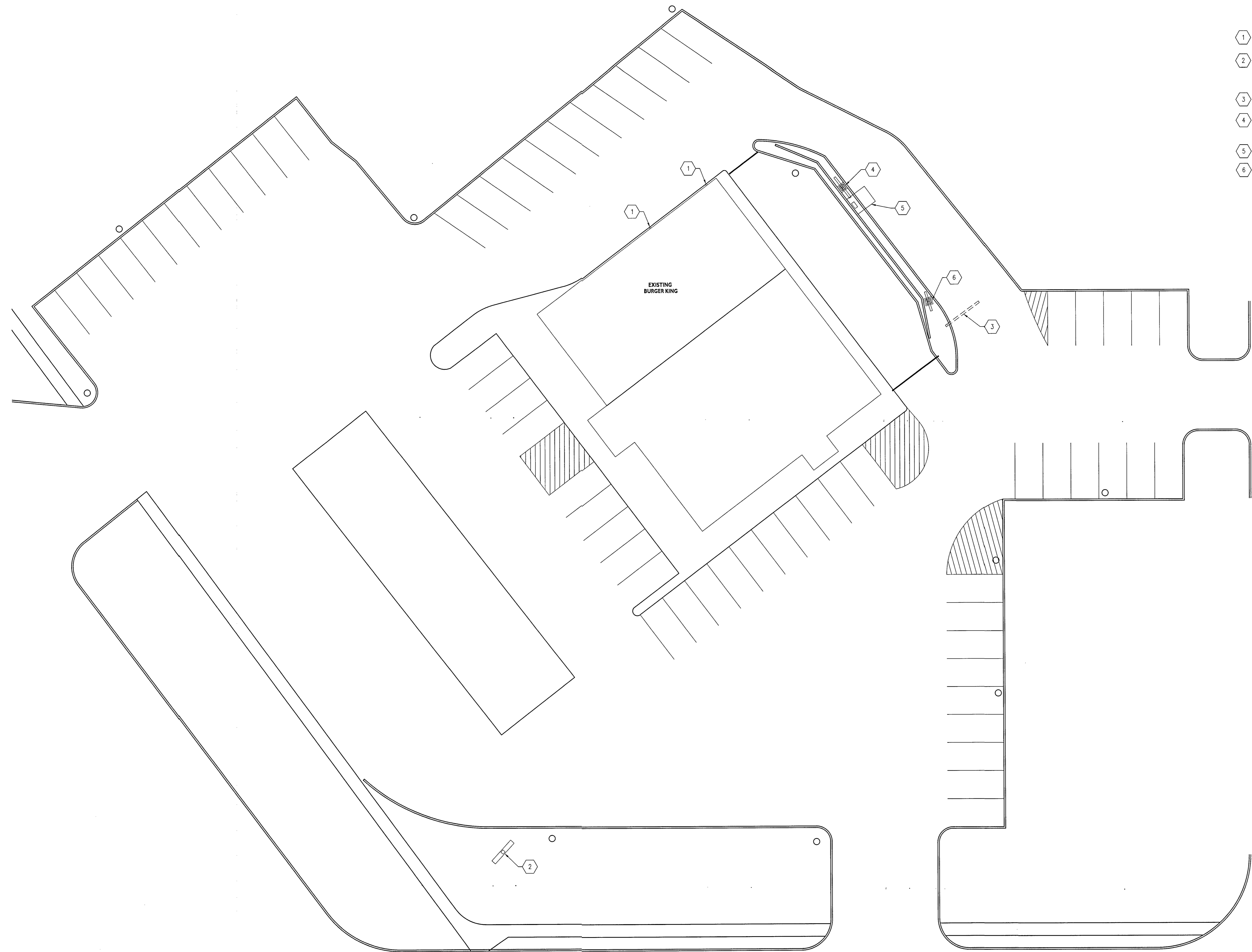

**ARCHITECTURAL SITE PLAN**  
1" = 15'-0"

