

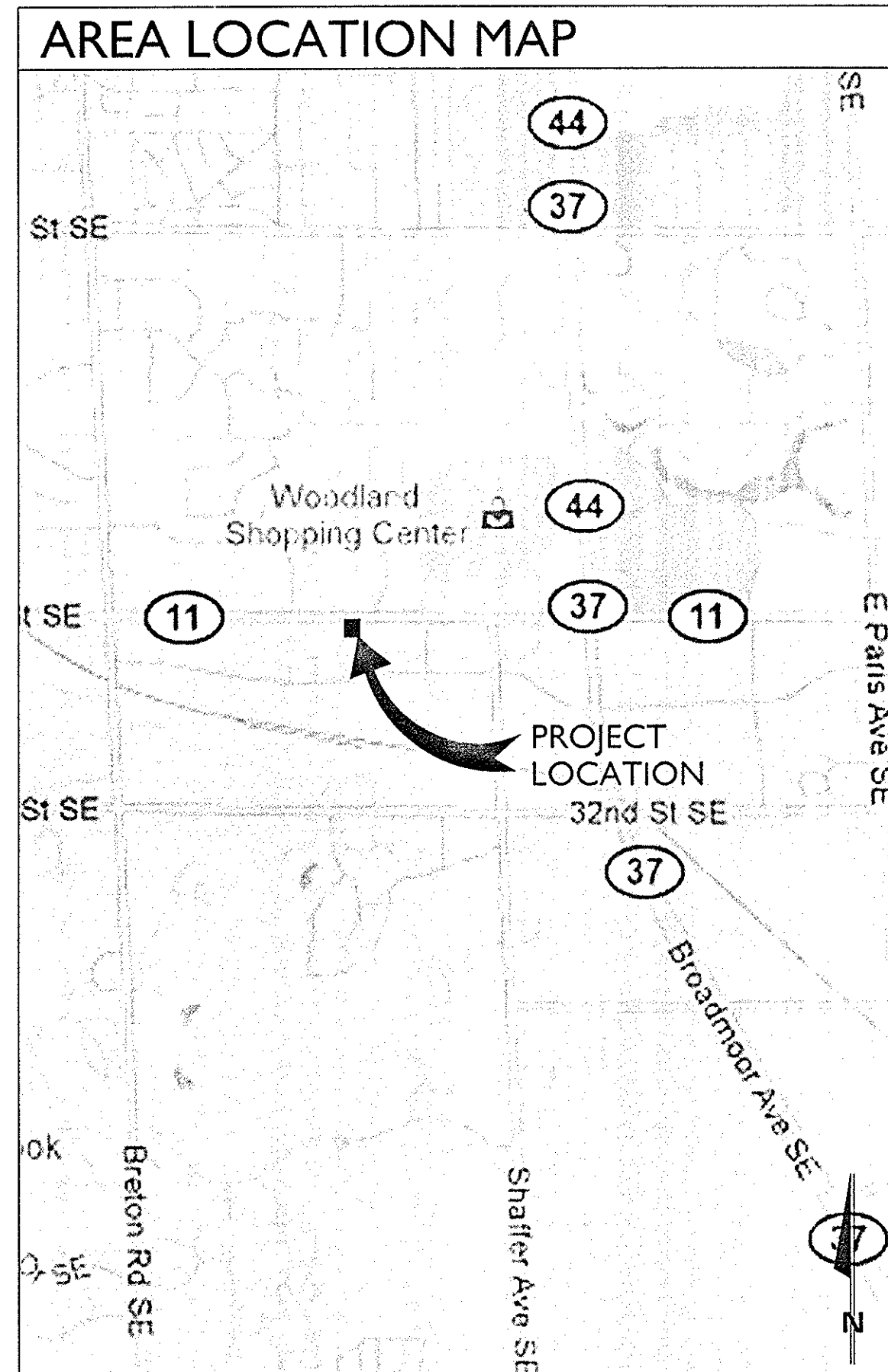

**BURGER KING RESTAURANT  
2880 - 28TH STREET  
KENTWOOD, MICHIGAN 49512-1623**

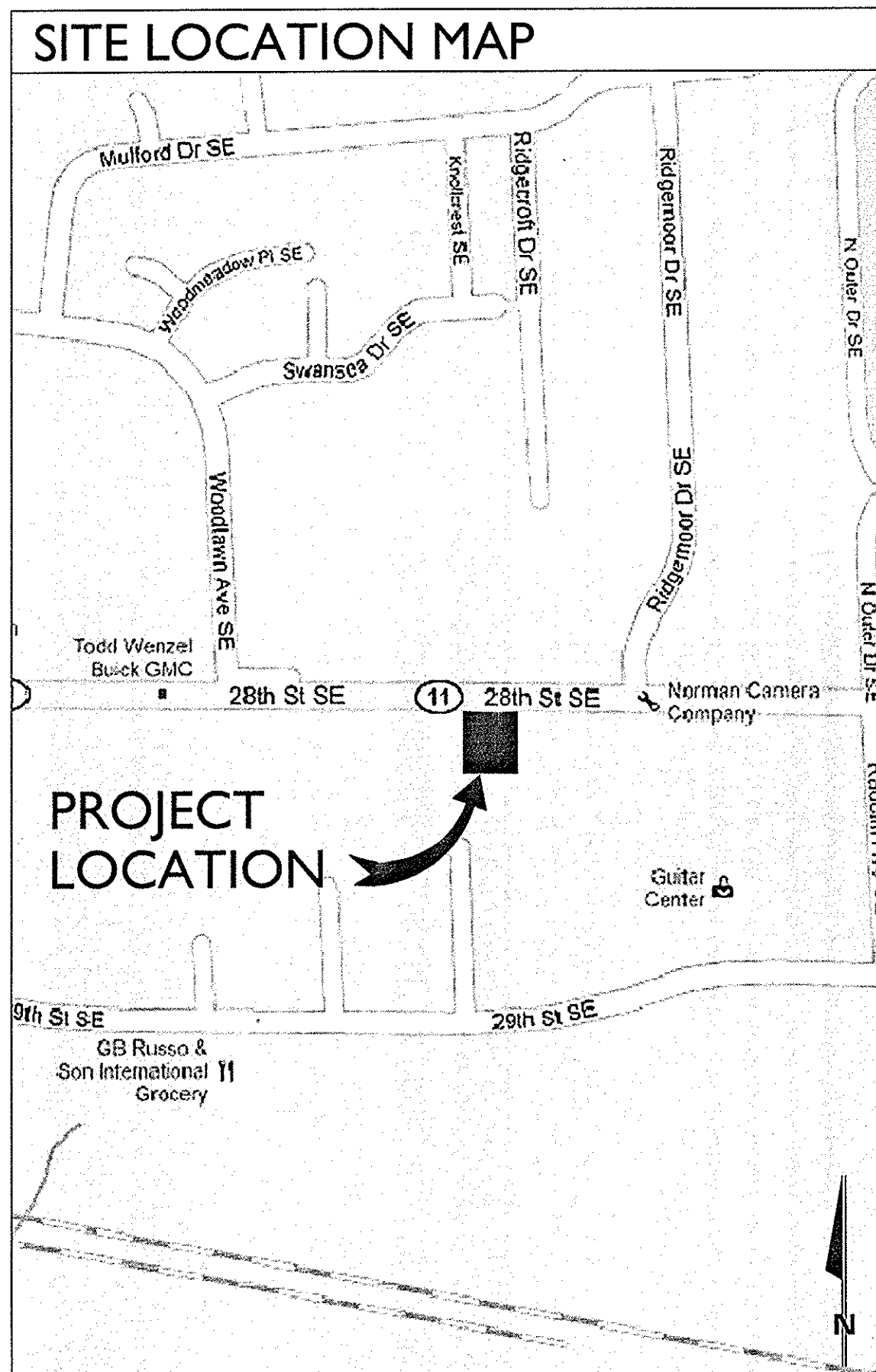

LOCAL CODE INFORMATION	
ZONING CLASSIFICATION:	C2 (COMMUNITY COMMERCIAL)
BUILDING CODE:	2009 MBC
MECHANICAL CODE:	2009 MMC
PLUMBING CODE:	2009 MPC
ELECTRICAL CODE:	2009 MEC
FIRE CODE:	2009 IFC
BARRIER FREE CODE:	2009 MBFC 2003 ICC/ANSI A117.1-2003
CLASSIFICATION:	MBC
TYPE OF CONSTRUCTION:	A2
BUILDING AREA:	VB
COOLER/FREEZER AREA:	3,840 sf
BUILDING HEIGHT:	216 sf (EXISTING)
SEATING CAPACITY:	16'-0" WALLS; 19'-0" ENTRY
TOTAL OCCUPANT LOAD:	59
	79
NOTES:	
1. FIRE PROTECTION SYSTEM IS NOT REQUIRED (OTHER THAN HOODS).	
DEFERRED SUBMITTALS	
1. FIRE SAFETY REVIEW	
2. .	
3. .	
4. .	
5. .	
6. .	

**LIST OF CONTACTS**

<b>OWNER</b> BRAVOKILO, INC. 4220 EDISON LAKES PARKWAY MISHAWAKA, INDIANA 46545 PH: (574) 271-4600 FAX: (574) 271-4612 EMAIL: TMLongley@qdi.com  <b>CONTACTS:</b> MIKE LONGLEY																					
<b>CIVIL ENGINEER</b> WIGHTMAN PETRIE, INC 412 S. LAFAYETTE BLVD. SOUTH BEND, INDIANA 46601 PH: 574-232-4388 FAX: 574-232-4333 EMAIL: nlacroix@wightmanpetrie.com  <b>CONTACTS:</b> Nick LaCroix																					
<b>LANDSCAPE DESIGNER</b> WIGHTMAN PETRIE, INC 412 S. LAFAYETTE BLVD. SOUTH BEND, INDIANA 46601 PH: 574-232-4388 FAX: 574-232-4333 EMAIL: cchockley@wightmanpetrie.com  <b>CONTACTS:</b> CHRIS CHOCKLEY																					
<b>ARCHITECT</b> WIGHTMAN PETRIE, INC. 412 S. LAFAYETTE BLVD. SOUTH BEND, INDIANA 46601 PH: 574-232-4388 FAX: 574-232-4333 EMAIL: slacluyse@wightmanpetrie.com  <b>CONTACTS:</b> STEVE LaCLUYSE																					
<b>STRUCTURAL</b> WIGHTMAN PETRIE, INC. 412 S. LAFAYETTE BLVD. SOUTH BEND, INDIANA 46601 PH: 574-232-4388 FAX: 574-232-4333 EMAIL: slacluyse@wightmanpetrie.com  <b>CONTACTS:</b> Steve LaCluyse																					
<b>MECHANICAL ELECTRICAL &amp; PLUMBING ENGINEER</b> M/E DESIGN SERVICES 120 SOUTH HILL STREET MISHAWAKA, INDIANA 46544 PH: 574-256-1914 FAX: . EMAIL: .  <b>CONTACTS:</b> TOM COOK																					
<table border="1"> <thead> <tr> <th>MRK</th> <th>DATE</th> <th>ISSUED FOR</th> </tr> </thead> <tbody> <tr> <td>.</td> <td>.</td> <td>.</td> </tr> <tr> <td>.</td> <td>.</td> <td>.</td> </tr> <tr> <td>.</td> <td>.</td> <td>.</td> </tr> <tr> <td>.</td> <td>.</td> <td>.</td> </tr> <tr> <td>.</td> <td>.</td> <td>.</td> </tr> <tr> <td>.</td> <td>.</td> <td>.</td> </tr> </tbody> </table>	MRK	DATE	ISSUED FOR	.	.	.	.	.	.	.	.	.	.	.	.	.	.	.	.	.	.
MRK	DATE	ISSUED FOR																			
.	.	.																			
.	.	.																			
.	.	.																			
.	.	.																			
.	.	.																			
.	.	.																			
<table border="1"> <thead> <tr> <th>MRK</th> <th>DATE</th> <th>ISSUED FOR</th> </tr> </thead> <tbody> <tr> <td>.</td> <td>.</td> <td>.</td> </tr> <tr> <td>.</td> <td>.</td> <td>.</td> </tr> <tr> <td>.</td> <td>.</td> <td>.</td> </tr> <tr> <td>.</td> <td>.</td> <td>.</td> </tr> <tr> <td>.</td> <td>.</td> <td>.</td> </tr> <tr> <td>.</td> <td>.</td> <td>.</td> </tr> </tbody> </table>	MRK	DATE	ISSUED FOR	.	.	.	.	.	.	.	.	.	.	.	.	.	.	.	.	.	.
MRK	DATE	ISSUED FOR																			
.	.	.																			
.	.	.																			
.	.	.																			
.	.	.																			
.	.	.																			
.	.	.																			

**INDEX TO DRAWINGS:**

SHEET	DESCRIPTION
X-1710-G101	COVER SHEET, CONTACTS & INDEX
X-1710-G201	LEGENDS AND NOTES
X-1710-G301	CONSTRUCTION SPECIFICATIONS
X-1713-01	CIVIL COVER SHEET
X-1713-02	GENERAL NOTES
X-1713-03	TOPOGRAPHIC SURVEY SHEET
X-1713-04	SITE DIMENSIONAL PLAN
X-1713-05	SITE GRADING PLAN
X-1713-06	LIGHTING PLAN SHEET
X-1713-07	MISC DETAIL SHEET
X-1713-08	BURGER KING STANDARD DETAILS SHEET
X-1713-09	SIGN, DRIVE THRU DETAILS
X-1713-10	ALTERNATE - RE-SURFACE SOUTH ACCESS
X-1713-11	SITE LANDSCAPE PLAN AND DETAILS
X-1713-12	SITE EROSION PLAN AND DETAILS
X-1710-S101	STRUCTURAL FOUNDATION PLAN AND DETAILS
X-1710-S201	ROOF FRAMING PLAN AND DETAILS
X-1710-D101	DEMOLITION DEMOLITION PLAN
X-1710-D201	EXTERIOR DEMOLITION ELEVATIONS
X-1710-A101	ARCHITECTURAL FLOOR PLAN
X-1710-A201	REFLECTED CEILING PLAN
X-1710-A301	ROOF PLAN AND DETAILS
X-1710-A401	EXTERIOR ELEVATIONS
X-1710-A402	INTERIOR ELEVATIONS
X-1710-A501	DOOR SCHEDULES AND DETAILS
X-1710-A601	WALL SECTIONS
X-1710-A602	WALL SECTIONS AND DETAILS
X-1710-A603	CONSTRUCTION DETAILS
ID-1	SEATING & DECOR PLANS
ID-2	COVER SHEET
ID-3	SEATING LAYOUT
ID-4	SPECIFICATIONS - WOODEN COPPER ELEVATIONS
ID-5	ELEVATIONS CONT.
ID-6	PENDANT LAYOUT
ID-7	ARTWORK LAYOUT
ID-8	FLOOR TILE & CARPET LAYOUT
X-1710-K101	KITCHEN PARTIAL KITCHEN EQUIPMENT PLAN
X-1710-M101	MECHANICAL & PLUMBING MECHANICAL SPECIFICATIONS AND NOTES
X-1710-M201	MECHANICAL DEMOLITION PLAN
X-1710-M301	PLUMBING PLAN
X-1710-M401	HVAC PLAN
X-1710-E101	ELECTRICAL ELECTRICAL SPECIFICATIONS, LEGEND & LIGHT FIXTURE SCHEDULE
X-1710-E201	ELECTRICAL DEMOLITION PLAN
X-1710-E301	ELECTRICAL POWER/SYSTEMS PLAN
X-1710-E401	LIGHTING PLAN
X-1710-E501	ELECTRICAL DETAILS, PANEL BOARD SCHEUDLES, ONE-LINE DIAGRAM

DESIGNED BY:	STEVE LACLUYSE
REVIEWED BY:	MATT SCHUSTER
DRAWN BY:	MATT SCHUSTER
DATE:	MAY 2, 2011
JOB NUMBER:	2010-5068
SCALE:	NONE
<b>X-1710-G101</b>	

**WIGHTMAN PETRIE**  
 SURVEYING ENGINEERING ENVIRONMENTAL LANDSCAPE ARCHITECTURE  
 412 South Lafayette Blvd South Bend, IN 46601 p: 574.232.4388 f: 574.232.4333

**Burger King Restaurant 1340**  
 Kentwood, Michigan  
**BRAVOKILO, INC.**  
 4220 Edison Lakes Parkway  
 Mishawaka, Indiana  
 COVER SHEET, CONTACTS & INDEX