

SEQUENCE OF CONSTRUCTION

UPON IMPLEMENTATION AND INSTALLATION OF THE FOLLOWING AREAS: TRAILER, PARKING, LAY DOWN, PORTA-POTTY, WHEEL WASH, CONCRETE WASHOUT, MASON'S AREA, FUEL AND MATERIAL STORAGE CONTAINERS, SOLID WASTE CONTAINERS, ETC. IMMEDIATELY DENOTE THEM ON THE SITE MAPS AND NOTE ANY CHANGES IN LOCATION AS THEY OCCUR THROUGHOUT THE CONSTRUCTION PROCESS.

PHASE I

1. INSTALL STABILIZED CONSTRUCTION EXIT(S) AND SWPPP ENTRANCE SIGN.
2. INSTALL SILT FENCE(S) AND SILT DIKE(S) ON THE SITE, AND INLET PROTECTION(S) (CLEAR ONLY THOSE AREAS NECESSARY TO INSTALL SILT FENCE).
3. PREPARE TEMPORARY PARKING AND STORAGE AREA.
4. HALT ALL ACTIVITIES AND CONTACT THE ENGINEER OF RECORD TO PERFORM INSPECTION OF BMP'S.
5. BEGIN DEMOLITION ACTIVITIES AND CLEARING AND GRUBBING THE SITE.
6. BEGIN GRADING THE SITE.
7. START CONSTRUCTION OF BUILDING PAD AND STRUCTURES.

PHASE II

1. TEMPORARILY SEED, THROUGHOUT CONSTRUCTION, DENIED AREAS THAT WILL BE INACTIVE FOR 7 DAYS OR MORE.
2. INSTALL UTILITIES, UNDERDRAINS, STORM SEWERS, CURBS AND GUTTERS.
3. INSTALL RIP RAP AROUND OUTLET STRUCTURES AS EACH OUTLET STRUCTURE IS INSTALLED.
4. INSTALL INLET PROTECTION AT ALL STORM SEWER STRUCTURES AS EACH INLET STRUCTURE IS INSTALLED.
5. PERMANENTLY STABILIZE AREAS TO BE VEGETATED AS THEY ARE BROUGHT TO FINAL GRADE.
6. PREPARE SITE FOR PAVING.
7. PAVE SITE.
8. INSTALL APPROPRIATE INLET PROTECTION DEVICES FOR PAVED AREAS AS WORK PROGRESSES.
9. COMPLETE GRADING AND INSTALLATION OF PERMANENT STABILIZATION OVER ALL AREAS INCLUDING OUT LOTS.
10. CALL ENGINEER OF RECORD AFTER THE SITE APPEARS TO BE FULLY STABILIZED FOR AN INSPECTION.
11. REMOVE ALL TEMPORARY EROSION AND SEDIMENT CONTROL DEVICES AFTER APPROVAL OF THE ENGINEER OF RECORD AND STABILIZE ANY AREAS DISTURBED BY THE REMOVAL OF THE BMP.
12. CONTINUE DAILY INSPECTION REPORTS UNTIL THE FINAL DAILY INSPECTION IS SIGNED OFF BY THE OWNER THAT THE SITE IS FULLY STABILIZED AND THE PERMIT MAY BE TERMINATED.
13. CONTRACTOR TO FILE NOTICE OF TERMINATION APPLICATION TO THE FDEP AND SHALL PROVIDE A COPY OF FDEP APPROVAL TO THE OWNER AND ENGINEER OF RECORD.

NOTE: THE GENERAL CONTRACTOR MAY COMPLETE CONSTRUCTION-RELATED ACTIVITIES CONCURRENTLY ONLY IF ALL PRECEDING BMP'S HAVE BEEN COMPLETELY INSTALLED.

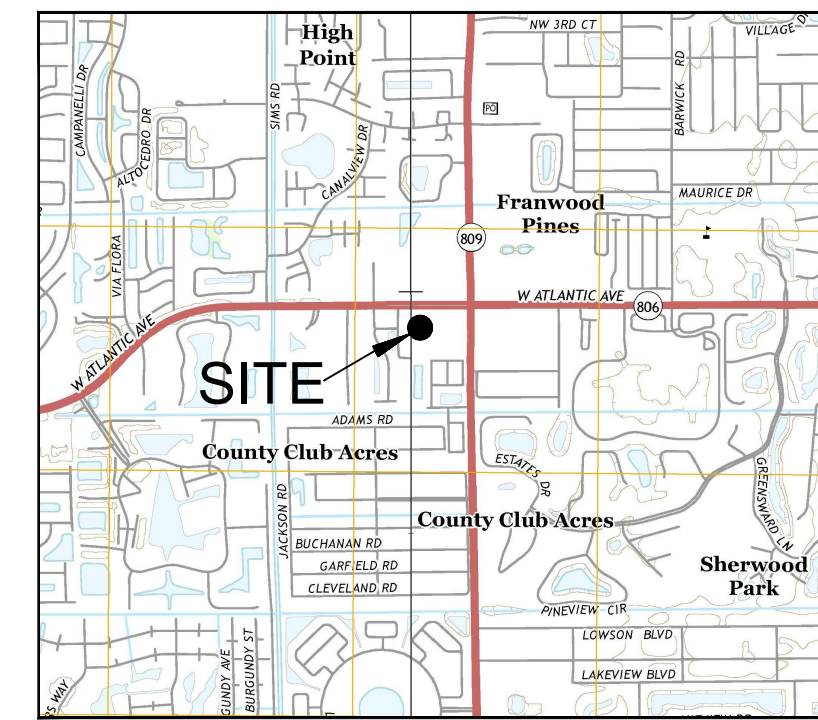

USGS QUADRANGLE MAP
NOT TO SCALE

BMP LEGEND

SYMBOL	DESCRIPTION
LOD	LIMITS OF DISTURBANCE
PS	PERMANENT SEEDING (CONTRACTOR TO COORDINATE WITH LANDSCAPE DESIGN)
SF	TEMPORARY SILT FENCE (REFER TO SHEET CD-5)
SS	SWPPP INFORMATION SIGN (REFER TO SHEET CD-5)
IP	DIRECTION OF OVERLAND FLOW
IP	FILTER FABRIC - INLET PROTECTION (REFER TO SHEET CD-5)
SDP	SILT DIKE ON PAVEMENT

GENERAL EROSION NOTES:

- A. THE STORMWATER POLLUTION PREVENTION PLAN IS COMPRISED OF THIS DRAWING ("SITE MAP"), THE STANDARD DETAILS, PLUS THE PERMIT AND ALL SUBSEQUENT REPORTS AND RELATED DOCUMENTS.
- B. ALL CONTRACTORS AND SUBCONTRACTORS INVOLVED WITH STORM WATER POLLUTION PREVENTION SHALL OBTAIN A COPY OF THE STORM WATER POLLUTION PREVENTION PLAN AND THE STATE OR NATIONAL POLLUTANT DISCHARGE ELIMINATION SYSTEM GENERAL PERMIT (NPDES PERMIT) AND BECOME FAMILIAR WITH THEIR CONTENTS.
- C. CONTRACTOR SHALL IMPLEMENT BEST MANAGEMENT PRACTICES AS REQUIRED BY THE SWPPP. ADDITIONAL BEST MANAGEMENT PRACTICES SHALL BE IMPLEMENTED AS DICTATED BY CONDITIONS AT NO ADDITIONAL COST OF OWNER THROUGHOUT ALL PHASES OF CONSTRUCTION.
- D. BEST MANAGEMENT PRACTICES (BMP'S) AND CONTROLS SHALL CONFORM TO FEDERAL, STATE, OR LOCAL REQUIREMENTS OR MANUAL OF PRACTICE, AS APPLICABLE. CONTRACTOR SHALL IMPLEMENT ADDITIONAL CONTROLS AS DIRECTED BY PERMITTING AGENCY OR OWNER.
- E. SITE MAP MUST CLEARLY DELINEATE ALL STATE WATERS. PERMITS FOR ANY CONSTRUCTION ACTIVITY IMPACTING STATE WATERS OR REGULATED WETLANDS MUST BE MAINTAINED ON SITE AT ALL TIMES.
- F. CONTRACTOR SHALL MINIMIZE CLEARING TO THE MAXIMUM EXTENT PRACTICAL OR AS REQUIRED BY THE GENERAL PERMIT.
- G. GENERAL CONTRACTOR SHALL DENOTE ON PLAN THE TEMPORARY PARKING AND STORAGE AREA WHICH SHALL ALSO BE USED AS THE EQUIPMENT MAINTENANCE AND CLEANING AREA, EMPLOYEE PARKING AREA, AND AREA FOR LOCATING PORTABLE FACILITIES, OFFICE TRAILERS, AND TOILET FACILITIES.
- H. ALL WASH WATER (CONCRETE TRUCKS, VEHICLE CLEANING, EQUIPMENT CLEANING, ETC.) SHALL BE DETAINED AND PROPERLY TREATED OR DISPOSED.
- I. SUFFICIENT OIL AND GREASE ABSORBING MATERIALS AND FLOTATION BOOMS SHALL BE MAINTAINED ON SITE OR READILY AVAILABLE TO CONTAIN AND CLEAN-UP FUEL OR CHEMICAL SPILLS AND LEAKS.
- J. DUST ON THE SITE SHALL BE CONTROLLED. THE USE OF MOTOR OILS AND OTHER PETROLEUM BASED OR TOXIC LIQUIDS FOR DUST SUPPRESSION OPERATIONS IS PROHIBITED.
- K. RUBBISH, TRASH, GARBAGE, LITTER, OR OTHER SUCH MATERIALS SHALL BE DEPOSITED INTO SEALED CONTAINERS. MATERIALS SHALL BE REMOVED FROM LEAVING THE PREMISES THROUGH THE ACTION OF WIND OR STORMWATER DISCHARGE INTO DRAINAGE DITCHES OR WATERS OF THE STATE.
- L. ALL STORM WATER POLLUTION PREVENTION MEASURES PRESENTED ON THIS SITE MAP, AND IN THE STORM WATER POLLUTION PREVENTION PLAN, SHALL BE INITIATED AS SOON AS PRACTICABLE.
- M. DISTURBED PORTIONS OF THE SITE, SHALL BE TEMPORARILY SEEDED. THESE AREAS SHALL BE SEEDED NO LATER THAN 7 DAYS FROM THE LAST CONSTRUCTION ACTIVITY OCCURRING IN THESE AREAS.
- N. DISTURBED PORTIONS OF THE SITE WHERE CONSTRUCTION ACTIVITY HAS PERMANENTLY STOPPED SHALL BE PERMANENTLY SEEDED. THESE AREAS SHALL BE SEEDED NO LATER THAN 7 DAYS AFTER THE LAST CONSTRUCTION ACTIVITY OCCURRING IN THESE AREAS. REFER TO THE GRADING PLAN AND/OR LANDSCAPE PLAN.
- O. IF THE ACTION OF VEHICLES TRAVELING OVER THE GRAVEL CONSTRUCTION ENTRANCES IS NOT SUFFICIENT TO REMOVE THE MAJORITY OF DIRT OR MUD, THEN THE TIRES MUST BE WASHED BEFORE THE VEHICLES ENTER A PUBLIC ROAD. IF WASHING IS USED, PROVISIONS MUST BE MADE TO INTERCEPT THE WASH WATER AND TRAP THE SEDIMENT BEFORE IT IS CARRIED OFF THE SITE. ONLY USE INGRESS/EGRESS LOCATIONS AS PROVIDED.
- P. ALL MATERIALS SPILLED, DROPPED, WASHED, OR TRACKED FROM VEHICLES ONTO ROADWAYS OR INTO STORM DRAINS MUST BE REMOVED IMMEDIATELY.
- Q. CONTRACTORS OR SUBCONTRACTORS WILL BE RESPONSIBLE FOR REMOVING SEDIMENT IN THE DETENTION POND AND ANY SEDIMENT THAT MAY HAVE COLLECTED IN THE STORM SEWER DRAINAGE SYSTEMS IN CONJUNCTION WITH THE STABILIZATION OF THE SITE.
- R. ON-SITE & OFFSITE SOIL STOCKPILE AND BORROW AREAS SHALL BE PROTECTED FROM EROSION AND SEDIMENTATION THROUGH IMPLEMENTATION OF BEST MANAGEMENT PRACTICES. STOCKPILE AND BORROW AREA LOCATIONS SHALL BE NOTED ON THE SITE MAP AND PERMITTED IN ACCORDANCE WITH GENERAL PERMIT.
- S. SLOPES SHALL BE LEFT IN A ROUGHENED CONDITION DURING THE GRADING PHASE TO REDUCE RUNOFF VELOCITIES AND EROSION.
- T. DUE TO THE GRADE CHANGES DURING THE DEVELOPMENT OF THE PROJECT, THE CONTRACTOR SHALL BE RESPONSIBLE FOR ADJUSTING THE EROSION AND SEDIMENT CONTROL MEASURES (SILT FENCES, ETC.) TO PREVENT EROSION, AND POLLUTANT DISCHARGE.
- U. THE ELEVATIONS SHOWN HEREON ARE BASED ON NAVD 88 DATUM. SITE BENCHMARK: NAIL AND DISC IN ASPHALT AS SHOWN, WITH AN ELEVATION OF 19.31
- V. THE PROPERTY SHOWN HEREON APPEARS TO BE IN ZONE X500, IN ACCORDANCE WITH THE PALM BEACH COUNTY FLOOD ZONE MAP AND WITH FEMA FIRM MAP NO. 120192 0205 B, MAP DATED OCTOBER 15, 1982.
- W. PER THE WEB SOIL SURVEY OF DELRAY BEACH FLORIDA, THE SITE IS COMPRISED OF MOSTLY MYAKKA FINE SAND AND A SMALL PERCENTAGE OF MMOKALEE FINE SAND.

MAINTENANCE

ALL MEASURES STATED ON THIS SITE MAP, AND IN THE STORM WATER POLLUTION PREVENTION PLAN, SHALL BE MAINTAINED IN FULLY FUNCTIONAL CONDITION UNTIL NO LONGER REQUIRED FOR A COMPLETED PHASE OF WORK OR FINAL STABILIZATION OF THE SITE. ALL EROSION AND SEDIMENTATION CONTROL MEASURES SHALL BE CHECKED BY A QUALIFIED PERSON IN ACCORDANCE WITH THE CONTRACT DOCUMENTS OR THE APPLICABLE PERMIT, WHICHEVER IS MORE STRINGENT, AND REPAIRED IN ACCORDANCE WITH THE FOLLOWING:

1. INLET PROTECTION DEVICES AND BARRIERS SHALL BE REPAIRED OR REPLACED IF THEY SHOW SIGNS OF UNDERMINING OR DETERIORATION.
2. ALL SEEDED AREAS SHALL BE CHECKED REGULARLY TO SEE THAT A GOOD STAND IS MAINTAINED. AREAS SHOULD BE FERTILIZED, WATERED, AND RESEEDED AS NEEDED.
3. SILT FENCES SHALL BE REPAIRED TO THEIR ORIGINAL CONDITIONS IF DAMAGED. SEDIMENT SHALL BE REMOVED FROM THE SILT FENCES WHEN IT REACHES ONE-HALF THE HEIGHT OF THE SILT FENCE.
4. THE CONSTRUCTION EXITS SHALL BE MAINTAINED IN A CONDITION WHICH WILL PREVENT TRACKING OR FLOW OF MUD ONTO PUBLIC ROADS.

KEYED NOTES:

- A. LOAM AND SEED UPON COMPLETION OF DEMOLITION.

SOIL EROSION/SEDIMENTATION CONTROL TIME SCHEDULE

NOTE: GENERAL CONTRACTOR TO COMPLETE TABLE WITH THEIR SPECIFIC PROJECT SCHEDULE

CONSTRUCTION SEQUENCE	JAN	FEB	MAR	APR	MAY	JUN	JUL	AUG	SEP	OCT	NOV	DEC	JAN	FEB	MAR	APR	MAY	JUN	JUL	AUG	SEP	OCT	NOV	DEC	
TEMPORARY CONTROL MEASURES																									
STRIP AND STOCKPILE TOPSOIL																									
STORM FACILITIES																									
TEMPORARY CONSTRUCTION ROADS																									
FOUNDATION/BUILDING CONSTRUCTION																									
SITE CONSTRUCTION																									
PERMANENT CONTROL STRUCTURES																									
FINISH GRADING																									
LANDSCAPING/SEED/FINAL STABILIZATION																									

ACREAGE SUMMARY (IN ACRES)

TOTAL PROJECT AREA (LIMITS OF DISTURBANCE)	1.028
ON-SITE DISTURBED AREA	1.028
OFF-SITE DISTURBED AREA	0.000
TOTAL DISTURBED AREA (MUST MATCH NOI)	1.028
IMPERVIOUS AREA AT COMPLETION	0.587
PERVIOUS/ SEEDED AREA AT COMPLETION	0.441

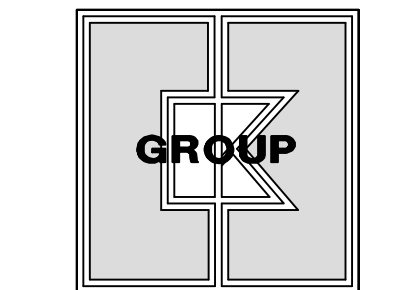
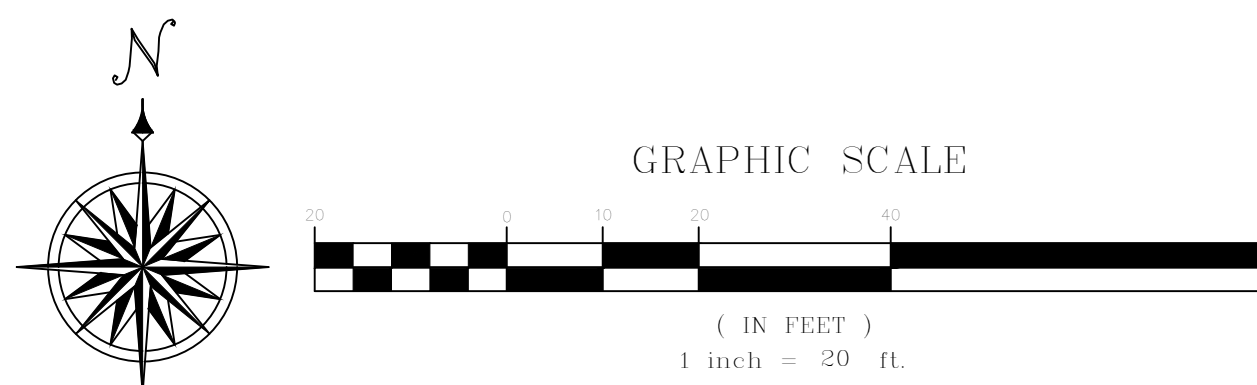

CKE GROUP INCORPORATED
engineering • architecture • planning

15500 NEW BARN ROAD
SUITE 106
MIAMI LAKES, FLORIDA 33014
PHONE: (305) 558-4124
FAX: (305) 826-0619
EB#0004432

SEAL
EDUARDO L. CARACHE
CIVIL ENGINEER-PE 31914
ANA A. GONZALEZ VALDEZ
ARCHITECT-AR 97769

NO.	DATE	DESCRIPTION
1	03-02-18	
2	07-26-18	
3		
4		
5		
6		
7		
8		
9		
10		

CONTRACT DATE:
BUILDING TYPE: CUSTOM
PLAN VERSION: 1
SITE NUMBER: 309797
STORE NUMBER: 420630

TACO BELL

5070 W. Atlantic Blvd.
Delray Bch., FL



T-40
OPEN KITCHEN
DELRAY BEACH SOL
PHASE 2
EROSION & SEDIMENTATION CONTROL PLAN

C-5

PLOT DATE: 07-26-2018