

FLORIDA DEPARTMENT OF TRANSPORTATION  
 STATE ROAD MAP BOY 124, PALM  
 (FORMERLY 100' F.E.C. RAILROAD RIGHT-  
 OF-WAY)

\*THIS ARE TO BE BY TACO BELL  
 SEE LANDSCAPE PLAN L-1

SOUTH DIXIE HIGHWAY  
 (116' PUBLIC RIGHT-OF-WAY)  
 (116' PUBLIC RIGHT-OF-WAY)  
 (116' PUBLIC RIGHT-OF-WAY)

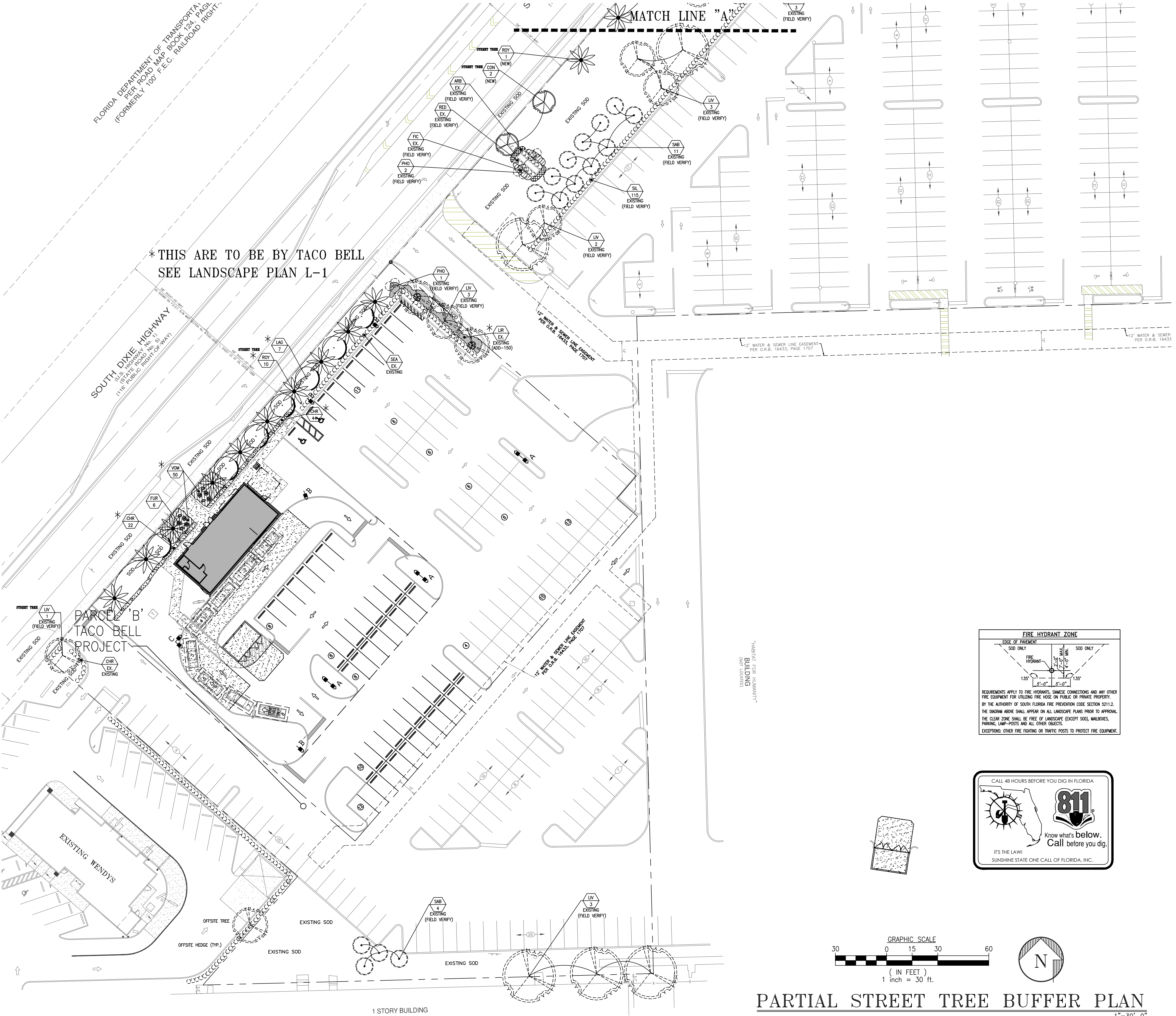

MATCH LINE "A"

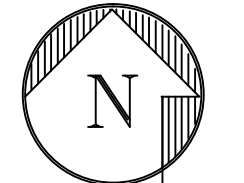
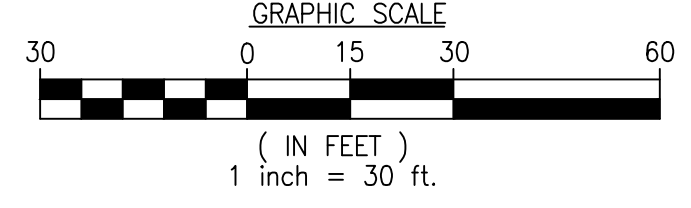
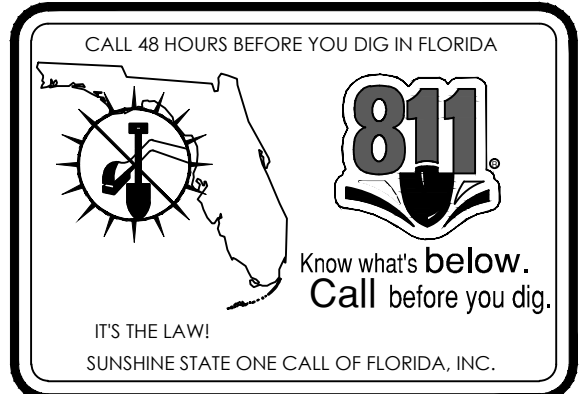
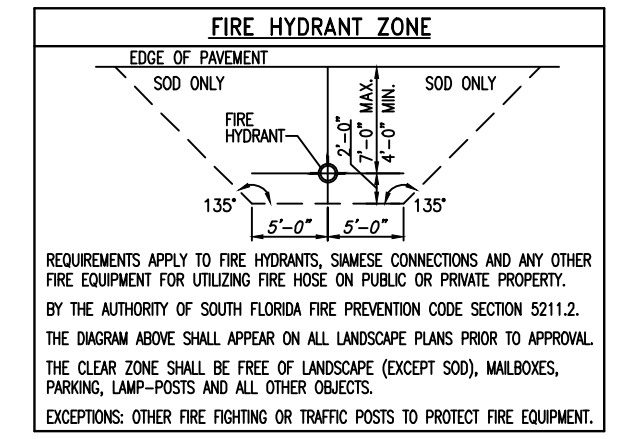

PARTIAL STREET TREE BUFFER PLAN

1"=30'-0"

**CKE GROUP**  
 INCORPORATED  
 engineering • architecture • planning  
 15500 NEW BARN ROAD  
 SUITE 106  
 MIAMI LAKES, FLORIDA 33014  
 PHONE: (305) 558-4124  
 FAX: (305) 826-0619  
 EB#0004432

SEAL  
 EDUARDO L. CARCACHÉ  
 CIVIL ENGINEER-PE 31914  
 ANA A. GONZALEZ VALDEZ  
 ARCHITECT-AR 97769

RICHARD BARTLETT LANDSCAPE, INC.  
 14417 STORUP LANE  
 WELLSINGTON, FL 33414  
 TEL: (561) 795-0445  
 LANDSCAPE ARCHITECTURE LC26000352  
 MICHAEL C. RAWLS RA140001635  
 EMAIL=planmaker@bellsouth.net

© COPYRIGHT  
 THE FOLLOWING DRAWINGS ARE INSTRUMENTS OF SERVICES TO THE CLIENT. THEY ARE NOT TO BE REPRODUCED OR TRANSMITTED IN ANY FORM OR BY ANY MEANS, ELECTRONIC OR MECHANICAL, INCLUDING PHOTOCOPYING, RECORDING, OR BY ANY INFORMATION STORAGE AND RETRIEVAL SYSTEM, WITHOUT THE WRITTEN PERMISSION OF THE ARCHITECT. ALL RIGHTS RESERVED.

SEAL  
 RBL#18-04-2101  
 DRAWN BY: RICK BARTLETT  
 06/25/2018  
 CHECKED BY: RGB/MER

NO.	DATE	DESCRIPTION
1	05-31-18	
2	06-25-18	

CONTRACT DATE: \_\_\_\_\_  
 BUILDING TYPE: EXP. LT. MED-40  
 PLAN VERSION: x  
 SITE NUMBER: 309797  
 STORE NUMBER: 420630

TACO BELL  
 20711 SO. DIXIE HWY  
 CUTLER BAY, FL

**TACO BELL**  
 Explorer Lite

**STREET TREE BUFFER**  
**L-200**

PLOT DATE: 07-06-2018