

1 SANITARY PLAN
SCALE: 1/4" = 1'-0"

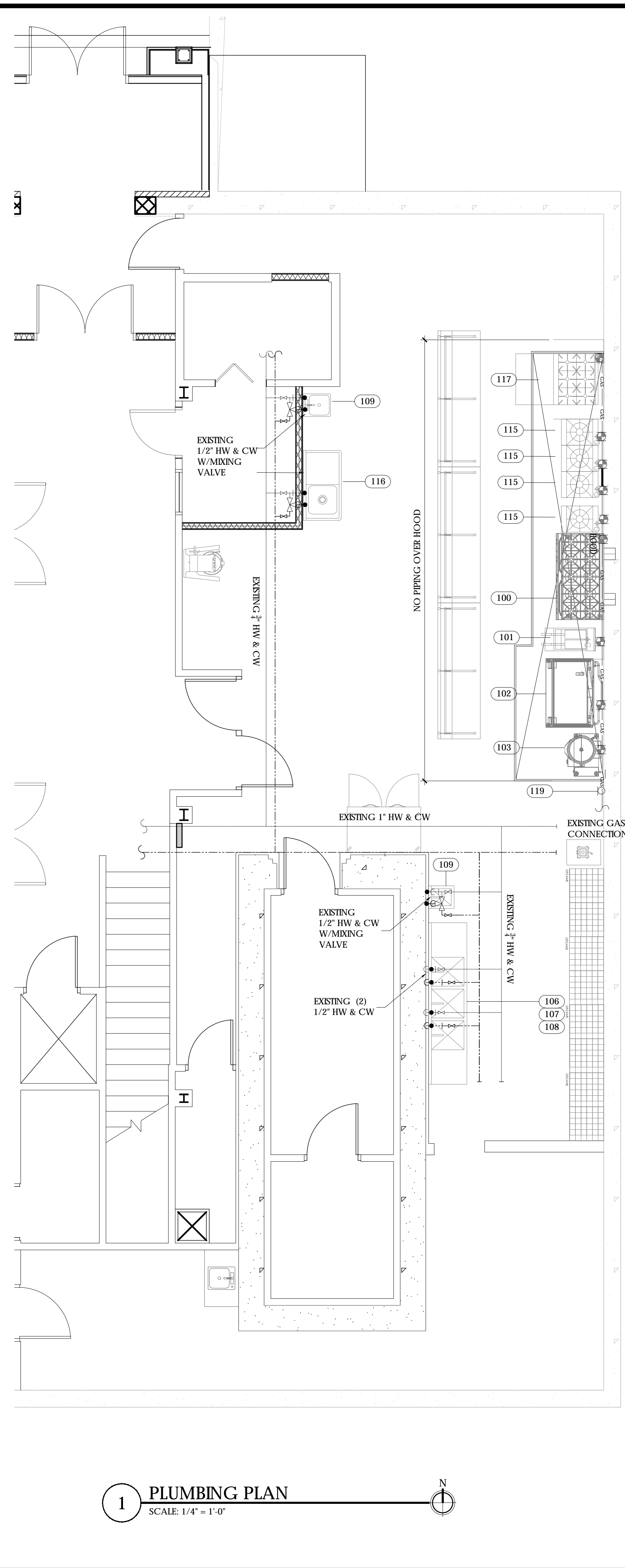

1 PLUMBING PLAN
SCALE: 1/4" = 1'-0"

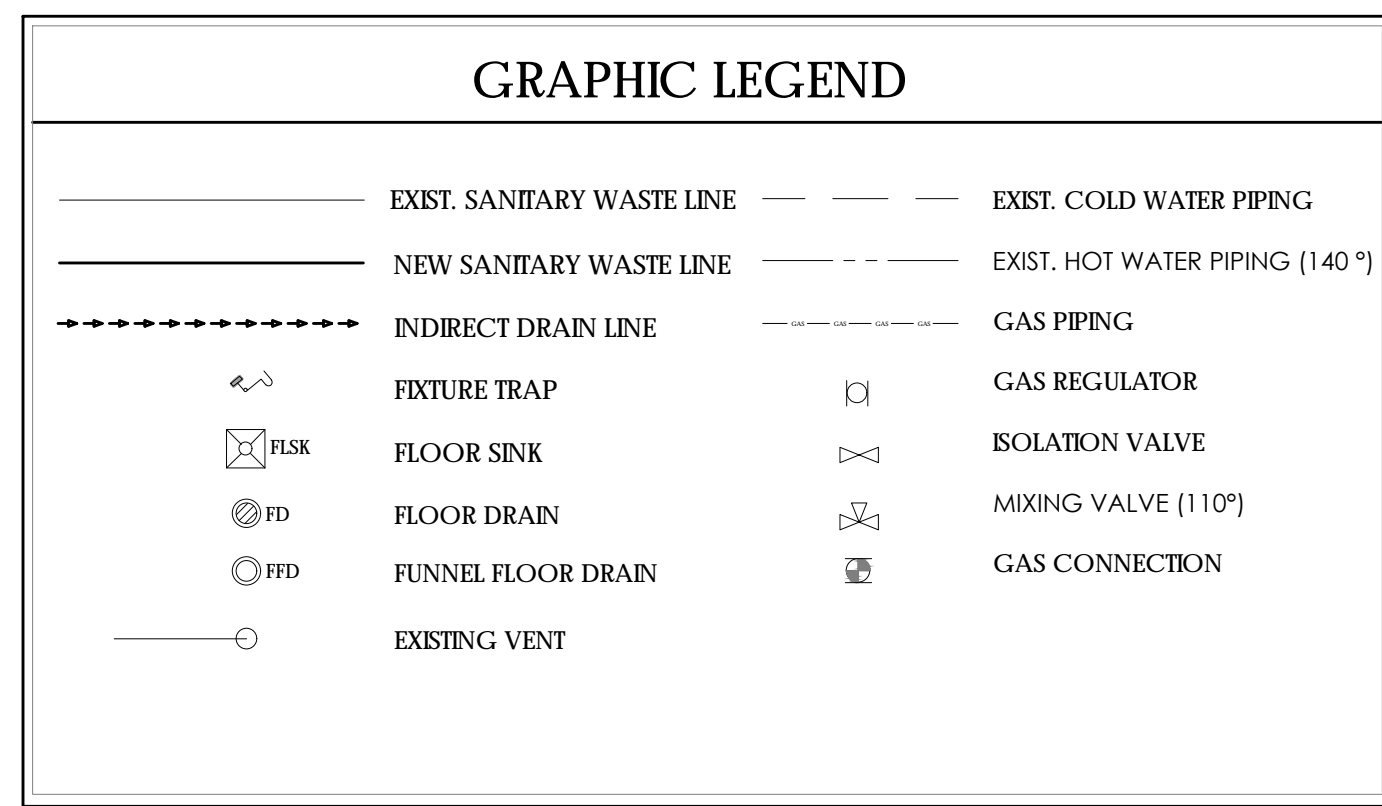

- ### PLUMBING SPECIFICATIONS-DIVISION 15
- LOCAL AND STATE CODES/ORDINANCES AND GENERAL CONDITIONS OF CONTRACT SHALL BE FOLLOWED. PAY ALL FEES AND ATTAIN ALL PERMITS. SUBMIT PLANS TO BUILDING DEPARTMENT FOR PLAN REVIEW. FOLLOW CORRECTION REQUIREMENTS.
 - ADOPTED ENERGY CODE SHALL BE FOLLOWED. ALL EQUIPMENT, INSULATION, AND CONTROLS SHALL CONFORM.
 - VISIT SITE AND ASCERTAIN EXISTING CONDITIONS PRIOR TO PROVIDING EQUIPMENT OR FABRICATING DUCT AND PIPING.
 - PLUMBING DRAWINGS ARE SCHEMATIC AND NOT TO BE SCALED. REFER TO ARCHITECTURAL OR CERTIFIED DRAWINGS FOR DIMENSIONS.
 - AS-BUILT SCALE DRAWINGS SHALL BE PROVIDED BY CONTRACTOR AND SUBMITTED TO DIVISION 15 ENGINEER AT COMPLETION SHOWING ALL PIPING, DUCT, AND EQUIPMENT CHANGES.
 - SHOP DRAWINGS: CONTRACTOR IS ENTIRELY RESPONSIBLE FOR CHECKING SHOP DRAWINGS FOR 100% COMPLIANCE WITH CONTRACT DOCUMENTS.
 - BASE BID ON BRAND NAMES SHOWN ON PLANS (IF NOT NAMED ON PLANS, THE FIRST NAMED IN SPECIFICATIONS). SUBSTITUTIONS HANDLED AS CHANGE ORDERS AFTER BIDDING WITH ALL ELECTRICAL AND BUILDING ALTERATIONS INCLUDED WITH DOLLAR AMOUNT PRIOR TO ORDERING.
 - EXTRA COSTS OR CHANGES ALLOWED ONLY IF APPROVED IN WRITING BY PROJECT MGR. WITH DOLLAR AMOUNT PRIOR TO ORDERING. NO EXTENSIONS OF COMPLETION TIME.
 - EQUIPMENT SHOWN ON DRAWINGS AND SPECIFICATIONS: CONTRACTOR SHALL PURCHASE, RECEIVE, UNCRATE, ASSEMBLE, INSURE, AND INSTALL IN CONFORMANCE TO MANUFACTURER'S RECOMMENDATIONS. ADDITIONALLY CONTRACTOR SHALL INSTALL AND FINAL CONNECT OWNER FURNISHED EQUIPMENT AS INDICATED.
 - OPERATING MANUAL SHALL BE PROVIDED OWNER AND ENGINEER FOR ALL SYSTEMS AND EQUIPMENT INCLUDING MANUFACTURER'S MAINTENANCE MANUALS, INCLUDE LUBRICATION, FILTER TYPES AND SIZES, STARTING AND STOPPING PROCEDURES, LIST HVAC, PLUMBING, AND CONTROL CONTRACTOR'S TELEPHONE NUMBERS.
 - CURBS, SUPPORTS, AND ANCHORS SHALL BE PROVIDED FOR MECHANICAL WORK. NO CHAIN, TAPE, OR WIRE.
 - SLEEVES AND COLLARS SHALL BE PROVIDED FOR ALL DUCTWORK AND PIPES THRU WALLS, FLOORS, AND CEILINGS. PROVIDE CHROME PLATED ESCUTCHEONS FOR PIPING PENETRATIONS THRU CEILINGS, FLOORS, AND WALLS IN FINISHED AREAS. ALL WATER, SOIL, WASTE, VENT AND TRIM INCLUDING FITTINGS TO BE CHROME PLATED WHERE EXPOSED.
 - CAULK ALL PIPING JOINTS WATER TIGHT WITH PERMANENT TOP-OF-LINE TYPE PER MANUFACTURER'S RECOMMENDATIONS.
 - CONCEAL ALL WORK IN FINISHED AREAS.
 - BEFORE STARTING OF ANY WORK, PLUMBING CONTRACTOR SHALL VERIFY AVAILABILITY, LOCATIONS, SIZES AND INVERT ELEVATION OF SEWER, WATER, GAS AND STORM DRAIN MAINS. NOTIFY THE ARCHITECT IMMEDIATELY OF ANY DISCREPANCIES.
 - INSTALL ALL PIPING TO AVOID INTERFERENCE WITH MECHANICAL AND ELECTRICAL EQUIPMENT AND STRUCTURAL FRAMING. NO WATER OR DRAIN LINES PERMITTED OVER THE
 - EXCAVATE FOR ALL MECHANICAL WORK. COMPACT TO 95% AASHO OR PROCTOR ELECTRICAL PANEL. DENSITY IN 6" MAXIMUM LAYERS AT OPTIMUM MOISTURE CONTENT. REWORK IF ANY SETTLEMENT WITHIN FIRST YEARS GUARANTEE.
 - VALVES SHALL BE PROVIDED TO ISOLATE EACH PIECE OF EQUIPMENT AND FOR ALLOUGH-INS EXCLUDING WASTE AND VENT. WATER: APOLLO BALL VALVE LINE SIZE RATED FOR 200 PSIG WOG. GAS: LINE SIZE LUBRICATED.
 - SOIL AND WASTE PIPING SHALL BE CODE APPROVED PLASTIC. PVC SHALL BE USED. PROVIDE CLEANOUTS 50'-0" MIN CC OF APPROPRIATE TYPE INSIDE BUILDINGS. PIPE EACH EVAP PAN DRAIN WITH P-TRAP 3/4" MINIMUM TO WASTE. SLOPE 1/4" PER FOOT.
 - VENT PIPING SHALL BE APPROVED PLASTIC PIPE WITH VENT THRU ROOF TOTAL CROSS SECTIONAL AREA TO BE EQUAL TO OR GREATER THAN BUILDING SEWER MAIN.
 - WATER PIPING SHALL BE 15% SILVER SIL-PHOS BRAZED JOINT TYPE K COPPER IF BURIED OR WITHIN 6' OF GRADE. USE NO LEAD 95/5 SOLDERED JOINT TYPE L COPPER ABOVE GRADE. INSULATE ALL WATER LINES WITH 1/2" THICK PERFORMED FIBERGLASS WITH UL-181 CLASS-1 PLENUM RATED COVER. CPVC IS APPROVED AT CONTRACTOR'S OPTION. FREEZE PROTECTION: ROUTE ALL PIPING INBOARD OF BUILDING INSULATION TO AVOID FREEZING. ELECTRIC HEAT TRACE ALL PIPING LOCATED IN UNHEATED AREAS WITH CHROMALOX 7.0 WATS/FT MI CABLE AND 1" THICK FIBERGLASS PIPING INSULATION WITH COVER.
 - GAS PIPING SHALL BE STANDARD WEIGHT BLACK STEEL WITH MALLEABLE SCREWED FITTINGS INSIDE BUILDING AND FROM METER TO BUILDING WHERE NOT BURIED. NO BURIED PIPING. VERIFY GAS LINE ROUTING WITH ARCHITECT AND BUILDING DEPARTMENT PRIOR TO INSTALLATION. COSTS INVOLVED IN GAS SERVICE SHALL BE INCLUDED IN BID. PROVIDE LINE SIZE VALVE JUST PRIOR TO ENTERING BUILDING. PROVIDE EQUIPMENT REGULATORS TO SUIT PRESSURE SUPPLIED. GAS PIPING ON ROOF SHALL RUN ON SUPPORTS PER CODE.
 - CLEANING AND TESTING SHALL BE DONE BY FLUSHING ENTIRE SYSTEM WITH WATER. AND TO BE WITNESSED BY FOOD SERVICE CONCEPTS.
 - PUMPS SHALL BE BRONZE FITTED FOR DOMESTIC WATER.
 - FLASH ALL ROOF DRAINS AND FLOOR DRAINS NOT SLAB-ON-GRADE WITH 3 PC IN LEAD EXTENDING 8" OUT FROM OUTER EDGE OF DRAIN IN ALL DIRECTIONS. CLAMP INTO DRAIN FLASHING CLAMP. ALL FLOOR DRAINS TO HAVE 4" DEEP SEAL TRAPS.
 - AIR CHAMBERS SHALL BE 12" MINIMUM HIGH PROVIDED AT THE ENDS OF EACH HW AND CW MAIN OR ROUGH-IN WITH PD RATED JOSAM 1485 SHOCK ABSORBER WITH BALL VALVE AND FIRE RATED MILCORE ACCESS PANEL FOR ALL FLUSH VALVES, CLOTHES WASHERS, AND QUICK CLOSING VALVES. DURING THE PROGRESS OF WORK, THE PLUMBING CONTRACTOR SHALL MAINTAIN AN ACCURATE RECORD OF ALL CHANGES MADE TO THE PLUMBING SYSTEM. THE RECORD AS-BUILT DRAWINGS SHALL SHOW CHANGES, DIMENSIONS, LOCATIONS AND DEPTH OF ALL BURIED WASTE, VENT, WATER AND GAS PIPING.
 - UPON COMPLETION OF THE PROJECT, THE PLUMBING CONTRACTOR SHALL INSPECT ALL EXPOSED PLUMBING AND REMOVE ANY SOIL, MARKINGS OR FOREIGN MATERIAL EXCEPT PRODUCT LABELS REQUIRED BY CODE.
 - PRESSURE TEST ALL PIPING PER CODE BUT TO AT LEAST 150% MAX WP.
 - GUARANTEE ALL LABOR AND EQUIPMENT FOR ONE YEAR FROM THE DATE OF ACCEPTANCE BY OWNER.

PLUMBING EQUIPMENT SCHEDULE

ITEM NO.	QTY.	DESCRIPTION	MANUFACTURER / MODEL	H.W.	C.W.	F.W.	L.D. WST	WASTE	GAS	MBTU	A.F.F.	REMARKS
100	1	10-BURNER W/ DBL CONVECTION OVEN	SOUTHBEND S60AA						3/4"	350	30.25"	
101	1	40 LB FRYER	PTCO 40D						3/4"	115	6"	
102	1	TILING SKILLET BRAISING PAN	SOUTHBEND BGLM-40	3/8"	3/8"				3/4"	125	12"	
103	1	KETTLE	SOUTHBEND KGCT-12						3/4"	100	18"	
106	1	EXISTING 3-COMP. SINK	BK INDUSTRIES	1/2"	1/2"	3"			-	-	-	DRAINS TO EXIST F.S.
107	1	EXISTING PRE-RINSE W/ ADD ON FAUCET	T & S BRASS	1/2"	1/2"				-	-	-	AT 3-COMP. SINK
108	1	EXISTING SINK FAUCET	T & S BRASS	1/2"	1/2"				-	-	-	AT 3-COMP. SINK
109	2	EXISTING HANDSINK		1/2"	1/2"			1-1/2"	-	-	-	
115	4	EXISTING 18" STOCK POT RANGE							3/4"	110	12.5"	
116	1	EXISTING 1-COMP PREP SINK		1/2"	1/2"	3"			-	-	-	DRAINS TO EXIST F.S.
117	1	EXISTING 6-BURNER RANGE							3/4"	205	30.25"	EXISTING
G.I.	1	GREASE INTERCEPTOR	DORMONT WD-75-A						-	-	-	
K.D.	1	KETTLE DRAIN	ZURN Z1762					3"	-	-	-	

PLUMBING GENERAL NOTES

- PLUMBER TO MAKE ALL FINAL CONNECTIONS.
- DRAIN LINES SHALL BE AT LEAST 8" OFF FINISH FLOOR & 1/2" FROM WALLS. PLUMBER TO PROVIDE ALL SHUT-OFF VALVES AND REGULATORS AS PER LOCAL CODES AND MANUFACTURER'S SPECIFICATIONS.
- ALL WASTE AND FAUCETS TO BE SUPPLIED BY KITCHEN EQUIPMENT CONTRACTOR. PLUMBER TO SUPPLY ALL OTHERS. PLUMBER TO INSTALL AUTOMATIC SHUT-OFF VALVE SUPPLIED BY FIRE CONTROL CONTRACTOR.
- ALL FLOOR SINKS TO BE FINISHED FLUSH W/ FLOOR.
- PLUMBER TO SUPPLY FLOOR GRATES ON FLOOR SINKS AS REQUIRED.
- PLUMBING CONTRACTOR TO PROVIDE HARD ACR OR TYPE 'L' COPPER.
- FIXTURE DRAINS, WHEN REQUIRED INSTALLATION OF DRAIN LINE IN WALL SHOULD BE DONE BEFORE IT IS PLASTERED.
- ALL TEMPERED WATER LINES SHALL BE RAN THROUGH AN APPROVED WATER TEMPERATURE LIMITING DEVICE THAT CONFORMS TO ASSE 1070.
- EXISTING CONDITIONS BASED ON OWNER SUPPLIED DRAWINGS. CONTRACTOR SHALL DETERMINE ACTUAL PIPING LAYOUT BEFORE COMMENCING ANY CUTTING ACTIVITIES. COST OF SUCH DETERMINATION TO BE INCLUDED IN THE BASE BID.
- REFER TO SPECIFICATIONS FOR MATERIALS AND EQUIPMENT REQUIREMENTS.
- COORDINATE WORK WITH ALL OTHER TRADES BEFORE INSTALLATION TO ELIMINATE CONFLICTS.
- ALL TESTABLE BACKFLOW DEVICES SHALL BE TESTED AND REGISTERED WITH THE BUILDING SAFETY DIVISION. A COPY OF THE REGISTRATION AND APPROPRIATE FEES, SHALL BE SUBMITTED PRIOR TO ISSUANCE OF A CERTIFICATE OF OCCUPANCY.

Notes
Submitted for Permitting
Date By
1 2.2.18 DBB
No.
1
Drawn By: DBB
Checked: SB
Scale: AS NOTED
Date: 1.30.18

ALL RIGHTS RESERVED. NO PART OF THESE DRAWINGS OR SPECIFICATIONS MAY BE COPIED, REPRODUCED OR USED IN CONNECTION WITH ANY WORK OTHER THAN THE SPECIFIC PROJECT FOR WHICH THEY HAVE BEEN PREPARED, WITHOUT PRIOR WRITTEN AUTHORIZATION FROM THE ARCHITECT.

ISKCON TEMPLE
36600 GRAND RIVER AVE.
FARMINGTON HILLS, MI 48335

TECHNICAL GROUP, INC.
37716 Hill Tech Drive
Farmington Hills, MI 48331
(248) 996-8000
FAX (248) 428-7004

PROJECT
ISKCON TEMPLE
36600 GRAND RIVER AVE.
FARMINGTON HILLS, MI 48335

SHEET TITLE
PLUMBING/SANITARY PLANS

DO NOT SCALE THIS PRINT. USE FIGURED DIMENSIONS ONLY.

JOB #
TG-18502

SHEET
P-1