

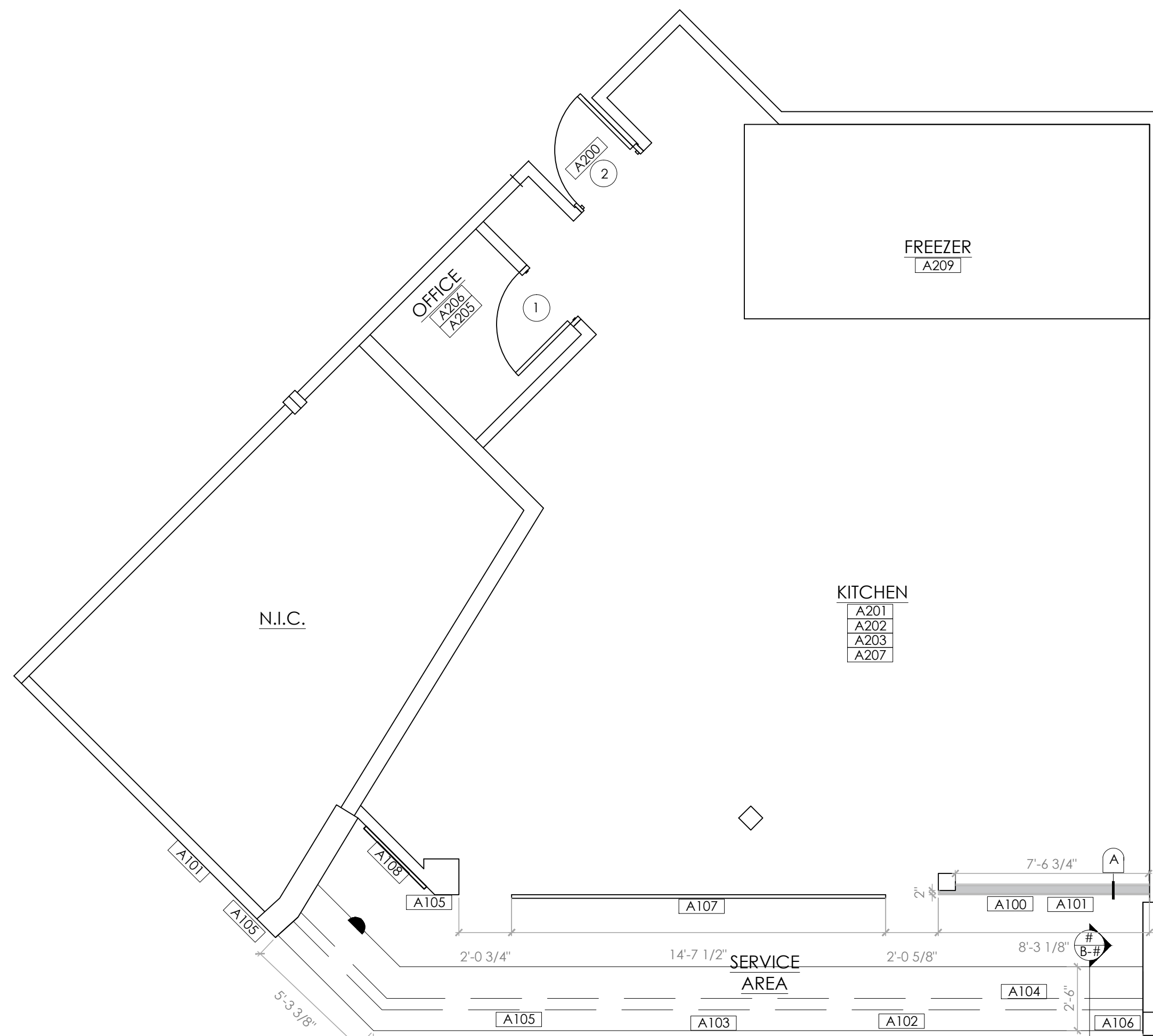

1 DEMO PLAN
SCALE: 1/4" = 1'-0"



2 PROPOSED FLOOR PLAN
SCALE: 1/4" = 1'-0"



3 REFLECTED CEILING PLAN
SCALE: 1/4" = 1'-0"

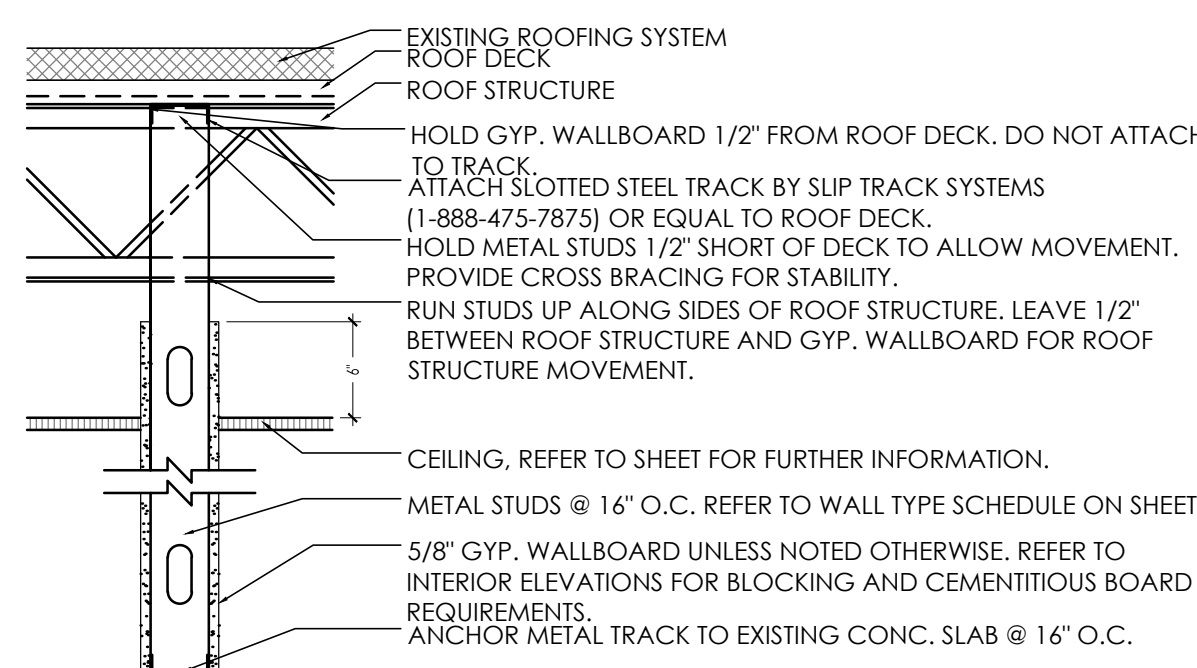

A WALL TYPE
N.T.S.

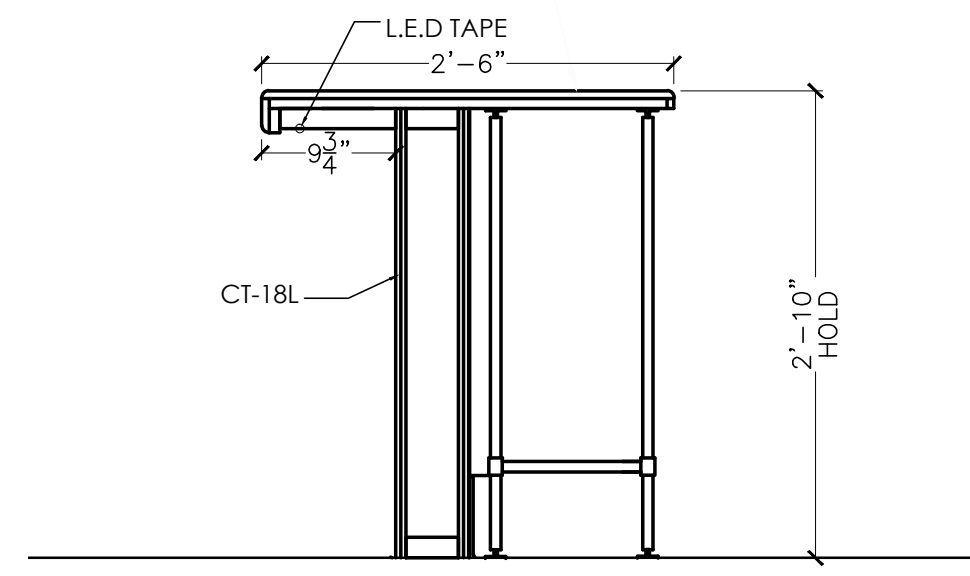

B SERVICE COUNTER
N.T.S.

SYMBOLS LEGEND					
SYMBOL	MANUFACTURER	CATALOG NO.	WATTAGE	COLOR TEMP	REMARKS
					SUPPLY AIR DIFFUSERS (ALUMINUM TO MATCH CEILING COLOR)
					RETURN AIR GRILLES (ALUMINUM TO MATCH CEILING COLOR)
D O	SECURITY CREEE(RUUD)-HERIMITAGE	PDL6K-LED-HO-WW-120 SLSD8XCL-LB6LEDA30K-WH LRS-10L-30K-120-A-DR W/ RC6-12W-GU24	13 14 11	3000K 3000K 3000K	6" OR 7" DIAMETER RECESSED DOWN LIGHT
D2					6" ADJUSTABLE RECESSED WALL WASHER
G	LSI SECURITY CREEE(RUUD)-HERIMITAGE	GA24-LED-HO-NW-UE-P12 LJT24-40MLG-FSA12-EU-C388 CR24-40L-40K-S	57 40.8 40	4000K 4000K 4000K	1. TO BE USED IN KITCHEN 2. 2X4 RECESSED LED
EM	LSI SECURITY CREEE(RUUD)-HERIMITAGE	LTEM-WH 2M22RWH	(2) 11	1 LED	EMERGENCY LIGHT
EMX	LSI SECURITY CREEE(RUUD)-HERIMITAGE	1PRX-R-U-WH-LD11-R CCRRC EXDMBRWH	(2) 11	1.1 LED	EXIT/MERGENCY LIGHT

PROPOSED SCOPE OF WORK

- SERVICE AREA
 - A100] INSTALL NEW FULL HEIGHT WALL AS PER LAYOUT.
 - A101] PREP WALLS TO BE PAINTED AS PER ELEVATION.
 - A102] INSTALL NEW SERVICE COUNTER TOP. REFER TO PLAN FOR LAYOUT.
 - A103] INSTALL NEW LED TAPE LIGHT UNDER "WATERFALL" COUNTER EDGE. CONNECT TO EXISTING ELECTRICAL.
 - A104] LOWER FRONT COUNTER KNEE WALL TO ADA HEIGHT (MAX 34").
 - A105] RE-TILE COUNTER KNEE WALL AS PER LAYOUT AND SPECIFICATION.
 - A106] INSTALL NEW ETCHED LOGO ON KNEE WALL.
 - A107] PAINT SOFFIT BEHIND MENU BOARD P-14L.
 - A108] RELOCATE EXISTING LOGO, E.C. TO PROVIDE JUNCTION BOX.
 - A109] INSTALL NEW STAINLESS STEEL SIGN ON ADJACENT WALL.
 - A110] REPLACE SERVICE AREA LIGHT FIXTURES WITH LED.
 - A111] INSTALL NEW SPOT LIGHT ON BURGER KING LOGO.
 - A112] REPLACE HVAC GRILLES/DIFFUSERS.
 - A113] RELOCATE MENU BOARDS AS PER REFLECTED CEILING PLAN, E.C. TO RELOCATE ELECTRICAL AS NEEDED.
 - A114] INSTALL/VERIFY WIFI.
 - KITCHEN AREA / BOH
 - A200] RELAMINATE DOOR TO MATCH 2020 PAINT, FRAME P-9L.
 - A201] REPAIR FLOOR TILE & BASE THROUGHOUT BOH; REPLACE MISSING, BROKEN, LOOSE & MISMATCHED TILES AS NECESSARY. REGROUT W/EPOXY GROUT AS NEEDED.
 - A202] REPLACE ALL DISCOLORED FRP.
 - A203] INSTALL NEW CEILING TILE, GRID AND DIFFUSERS THROUGH BOH.
 - A204] REMOVE ALL EXPOSED WOOD IN BOH, REPLACE WITH CLEAN/WIPEABLE SURFACE.
 - A205] REFINISH THE OFFICE DOOR/PAINT FRAME AND INSTALL NEW HARDWARE.
 - A206] INSTALL NEW TABLETOP OF DESK/COUNTER IN OFFICE.
 - A207] INSTALL/REPLACE STAINLESS STEEL CORNER GUARDS.
 - A208] INSTALL NEW BULB/COVER IN WALK-IN COOLER/FREEZER.
 - A209] REPAIR WALK-IN COOLER/FREEZER.
- * ALL FINISH SPECIFICATIONS TO BE 2020 IMAGE.

DEMO SCOPE OF WORK

- DINING ROOM
 - D100] DEMO TILE ON COUNTER KNEE WALL.
 - D101] DEMO COUNTER TOP.
 - D102] REMOVE EXISTING LOGO AND RETAIN.
 - D103] DEMO CEILING TILE/ GRID.
 - D104] DEMO A/C GRILLES & VENTS.
 - D105] DEMO LIGHTING TO BE REPLACED WITH LED.
 - D106] REMOVE MENU BOARD AND RETAIN.
 - D107] DEMO OFFICE TABLE TOP.

LEGEND

- EXISTING WALL TO REMAIN
- EXISTING ITEM, CONSTRUCTION, SYSTEM TO BE REMOVED
- NEW WALL

CEILING SPECIFICATIONS

- ACT-2L #BP670 ENVIROWALL
LOCATION: BACK OF HOUSE
MANUFACTURER: ARMSTRONG
COLOR: WHITE
GRID: PRELUDE 15/16" EXPOSED TEE GRID
DIMENSION: 2'X2'X1/2"
CONTACT: ARMSTRONG STRATEGIC ACCOUNTS (800.442.4212)
- P-14L 25-250
LOCATION: INTERIOR BULKHEAD & SOFFIT ACCENT-RED
MANUFACTURER: PPG
PRIMER: 17-921 (PRIMER COLOR GREY)
PAINT: SPEED HIDE INTERIOR EGGSHELL
COLOR: FLAMING RED PPG 6-411.
CONTACT:

TAG KEY	ELEVATION TAG	SECTION TAG	SCOPE TAGS	WALL TAG	DOOR TAG	FINISH TAG
	SEE SHEET A-2				SEE SHEET A-1	SEE SHEET A-1

No.	Date	By	Notes

Drawn By: PM
Checked: SB
Scale: AS NOTED
Date: 04.19.16



TECHNICAL GROUP, INC.
37716 Hills Tech Drive
Farmington Hills, MI 48331
(248) 426-8000
FAX (248) 426-7004

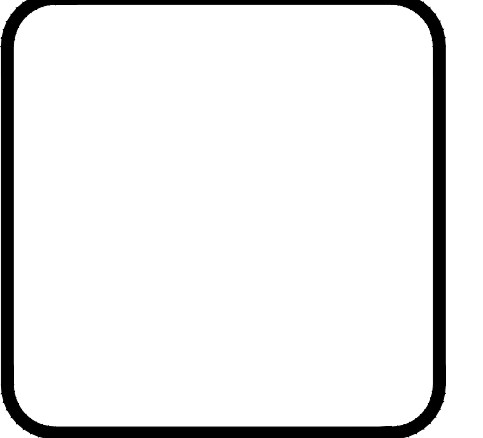
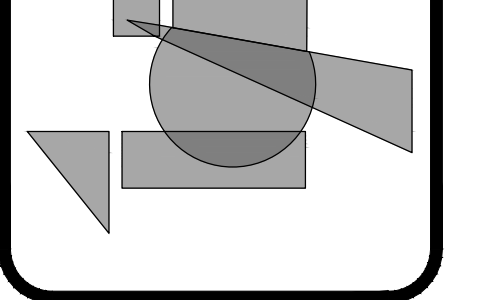

PROJECT BURGER KING #7017 4350 24TH AVE. FORT GRATIOT TOWNSHIP, MI 48059	SHEET TITLE PROPOSED FLOOR PLAN REFLECTED CEILING PLAN
DO NOT SCALE THIS PRINT. USE FIGURED DIMENSIONS ONLY.	
JOB # TG-16351	SHEET A-1