

WALL LEGEND	
	EXISTING WALL TO REMAIN
	EXISTING ITEM, CONSTRUCTION SYSTEM TO BE REMOVED

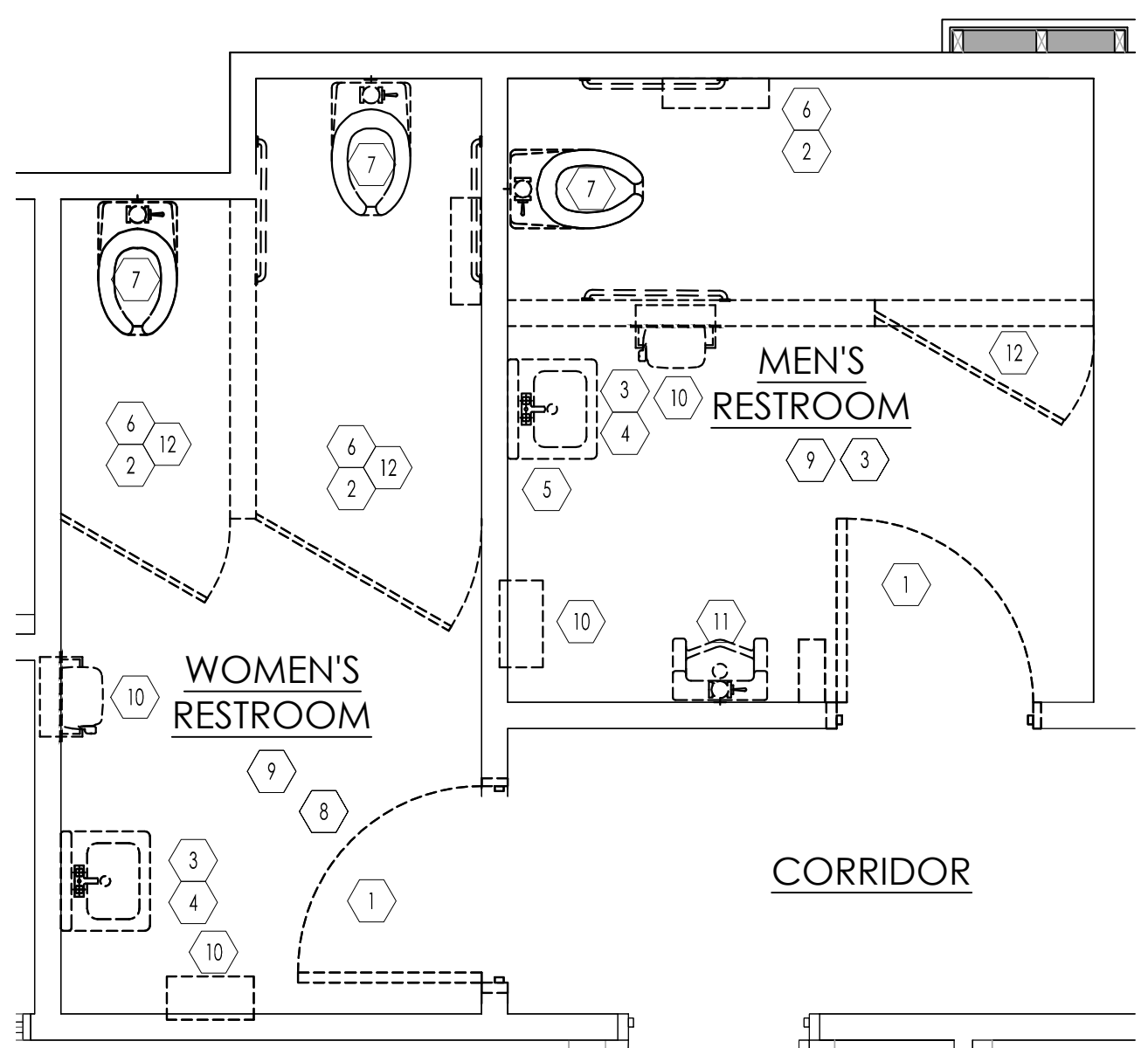

1 DEMOLITION PLAN
SCALE: 1/2" = 1'-0"

DEMO KEY NOTES	
1 DEMO RESTROOM DOORS	7 DEMO WATER CLOSET
2 DEMO GRAB BARS	8 DEMO FLOOR TILE CERAMIC WALL TILE & BASE
3 DEMO LAV, CAP OFF WATER AS NECESSARY	9 DEMO BROKEN OR CRACKED FLOOR TILE
4 DEMO MIRROR	10 DEMO EXCIING HAND DRYER & TRASH CAN
5 DEMO DISPENSERS AT LAVATORY	11 DEMO URINAL: CAP PLUMBING AS NECESSARY
6 DEMO TOILET PAPER DISPENSER	12 DEMO PARTITION & DOOR

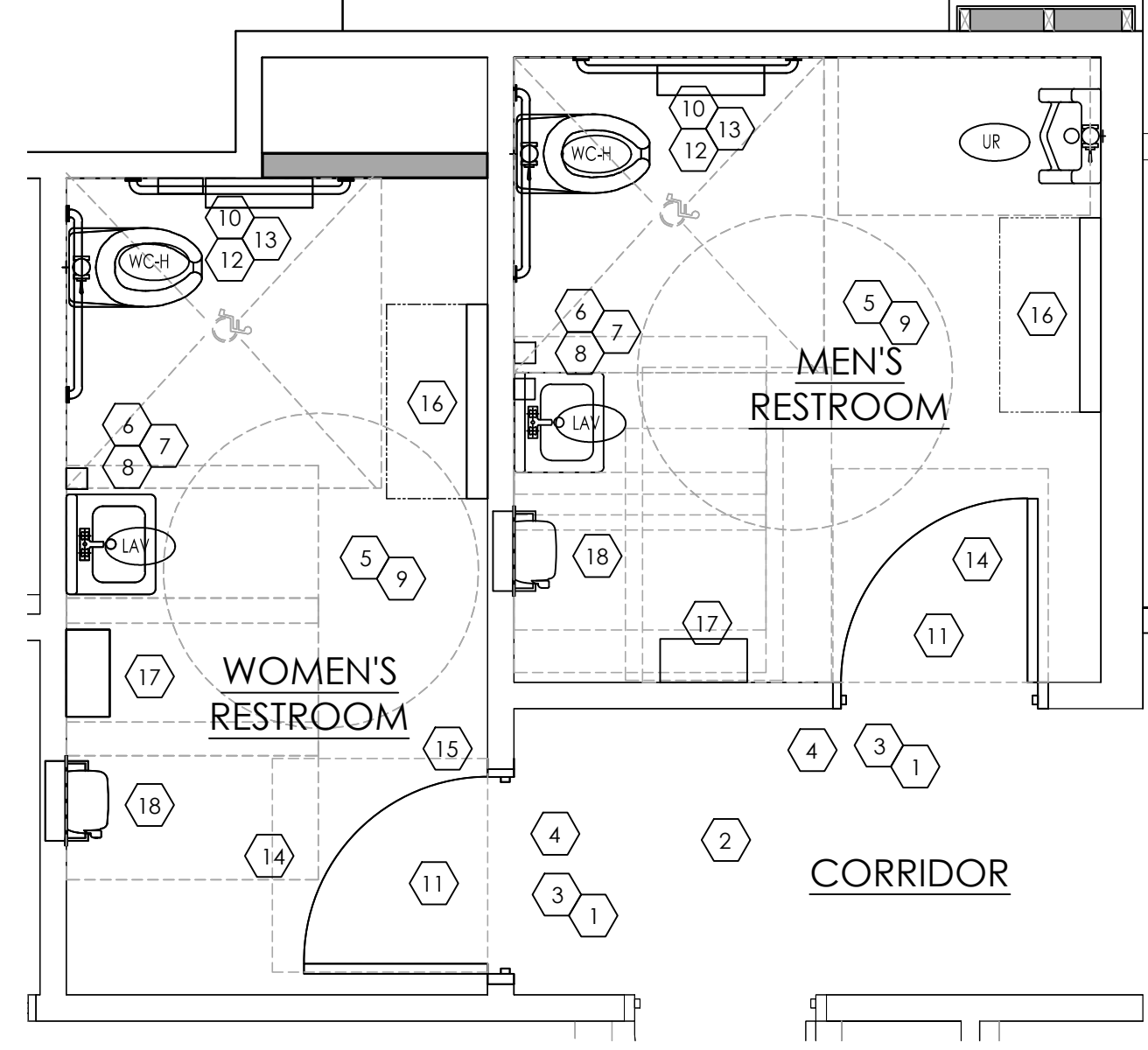

2 PROPOSED RESTROOM LAYOUT
SCALE: 1/2" = 1'-0"

NOTE
REFER TO TOILET KEY ROOM NOTES THIS PAGE

- RESTROOM GENERAL NOTES**
- CHANGES SHOWN ARE BASED ON FIELD MEASUREMENTS. CONTRACTOR SHALL DETERMINE ACTUAL PIPING LAYOUT BEFORE COMMENCING ANY CUTTING ACTIVITIES. COST OF SUCH DETERMINATION TO BE INCLUDED IN THE BASE BID.
 - REFER TO SPECIFICATIONS FOR MATERIALS AND EQUIPMENT REQUIREMENTS.
 - COORDINATE WORK WITH ALL OTHER TRADES BEFORE INSTALLATION TO ELIMINATE CONFLICTS.
 - THIS SPACE/BUILDING SHALL BE SURVEYED BY A CERTIFIED CROSS CONNECTION CONTROL DEVICE INSPECTOR. A COPY OF THIS SURVEY SHALL BE SUBMITTED TO BUILDING SAFETY WITH THE APPROPRIATE FEES, PRIOR TO ISSUANCE OF CERTIFICATE OF OCCUPANCY.
 - ALL TESTABLE BACKFLOW DEVICES SHALL BE TESTED AND REGISTERED WITH THE BUILDING SAFETY DIVISION. A COPY OF THE REGISTRATION AND APPROPRIATE FEES, SHALL BE SUBMITTED PRIOR TO ISSUANCE OF A CERTIFICATE OF OCCUPANCY.
 - REFER TO ELEVATIONS, SHEET A-4 FOR FINISH DETAILS.

- TOILET ROOM KEY NOTES**
- INSTALL HIGH CONTRAST, RAISED LETTER AND BRAILLE SIGNAGE AT A CENTERLINE HEIGHT OF 5' AND IMMEDIATELY BESIDE THE DOOR IDENTIFYING ALL NAMED AREAS IN COMPLIANCE W/ANSI 703. (5.e.34, 5.d.35)
 - MAINTAIN AN ACCESSIBLE ROUTE OF 36" WIDE TO ALL PUBLIC AREAS OF RESTAURANT. REMOVE PROTRUDING OBJECTS FROM THE PATH OF CIRCULATION (IBC 1104 & ANSI 403.5)
 - PRESSURE REQUIRED TO OPEN ALL DOORS NOT TO EXCEED 5 LBS. MAXIMUM. BOTTOM 10" OF DOOR MUST BE SMOOTH ON PUSH SIDE. ADJUST EXISTING DOOR PRESSURE IF NECESSARY. (ANSI 404.2.9 & 404.2.10)
 - DOOR CLOSURE SHOULD TAKE 5 SECONDS MINIMUM TO CLOSE. REPAIR AND OR REPLACE EXISTING DOOR CLOSER IF NECESSARY. (ANSI 404.2.8.1)
 - ALL CONTROLS SUCH AS STALL LATCHES, DISPENSERS, ETC., MUST BE OPERABLE BY A CLOSED FIST. TOILET PARTITION DOORS TO BE SELF CLOSING TYPE (ANSI 308 & 309.)
 - INSTALL NEW LAVATORIES w/CARRIER WALL MOUNTS INSTALL AT LEAST ONE NEW LAVATORY ON ACCESSIBLE PATH OF TRAVEL w/TOP OF BASIN 34" MAX. ABOVE FINISHED FLOOR, AND CLEAR HEIGHT BELOW FRONT OF LAVATORY 27" MIN. ABOVE FINISHED FLOOR. THE CLEAR WIDTH BELOW FRONT OF LAVATORY TO BE 30" MINIMUM. WRAP HOT WATER AND DRAIN TO PROTECT LEGS OF PERSONS IN WHEELCHAIR. (IBC 1008.3 & ANSI 606.)
 - INSTALL NEW DISPENSERS UPON COMPLETION OF REMODEL INSTALL LAVATORY ACCESSORIES (TOWEL DISP., SOAP DISP.) ON ACCESSIBLE PATH OF TRAVEL WITH HIGHEST CONTROL FEATURE AT 46" MAX ABOVE FINISHED FLOOR, 24" MAXIMUM HORIZONTALLY FROM A 30"x48" CLEAR FLOOR AREA. (ANSI 309) (5.e.13, 5.d.13)
 - INSTALL NEW MIRROR w/THE BOTTOM REFLECTING EDGE AT 40" MAXIMUM ABOVE FINISHED FLOOR (ANSI 603.3) (5.e.12, 5.d.12)
 - INSTALL NEW WALL TILE AND FLOOR TILE AS PER SPEC. AND LAYOUT.
 - ADA ACCESSIBLE WATER CLOSET IS TO BE INSTALLED w/SEAT @ 17" TO 19" A.F.F. w/FLUSH VALVE LOCATED ON OPEN SIDE OF STALL (ANSI 604). NON ACCESSIBLE WATER CLOSET TO BE INSTALLED AS INDICATED. (KEEP EXISTING)
 - INSTALL COAT HOOK ON INSIDE OF DOORS; TO BE AT 48" MAX.
 - INSTALL NEW GRAB BARS. INSTALL WITH CENTERLINE AT 33" TO 36" ABOVE FINISHED FLOOR SECURED TO WITHSTAND 250LB LOAD (ANSI 604.8.4.1)
 - INSTALL TOILET FIXTURES (TISSUE DISP., SAN. NAPKIN DISP.) ACCESSIBLE TOILET PAPER DISPENSERS SHALL COMPLY W/ANSI 309.4 AND SHALL BE 7" MINIMUM AND 9" MAXIMUM IN FRONT OF THE WATER CLOSET. THE OUTLET OF THE DISPENSER SHALL BE 15" MINIMUM AND 48" MAXIMUM ABOVE THE FLOOR OR GROUND. THERE SHALL BE A CLEARANCE OF 1 1/2" MINIMUM BELOW AND 12" MINIMUM ABOVE THE GRAB BAR. DISPENSERS SHALL NOT BE OF A TYPE THAT CONTROL DELIVERY, OR THAT DO NOT ALLOW CONTINUOUS PAPER FLOW (ANSI 604.7)
 - VERIFY DOORS IN RESTROOMS INCLUDE PUSH/PULL/KICKPLATES & CLOSURES IN COMPLIANCE W/ (ANSI 404)
 - MAINTAIN CLEAR FLOOR SPACE BEYOND STRIKE JAMB AND ON FULL SIDE OF DOOR AS PER ADA REQUIREMENTS.
 - CHANGING STATION: KOALA KARE #KB100-ST (HORIZONTAL)
 - INSTALL NEW ELEC. HAND DRYER & TRASH CAN - G.C. TO PROVIDE ELECTRIC.
 - INSTALL PAPER TOWEL WITH TRASH.

TAG KEY	ELEVATION TAG	KEY NOTE TAG	DOOR TAG	FIXTURE TAG	FINISH TAG
	SEE SHEET A-4		SEE SHEET A-1.1		

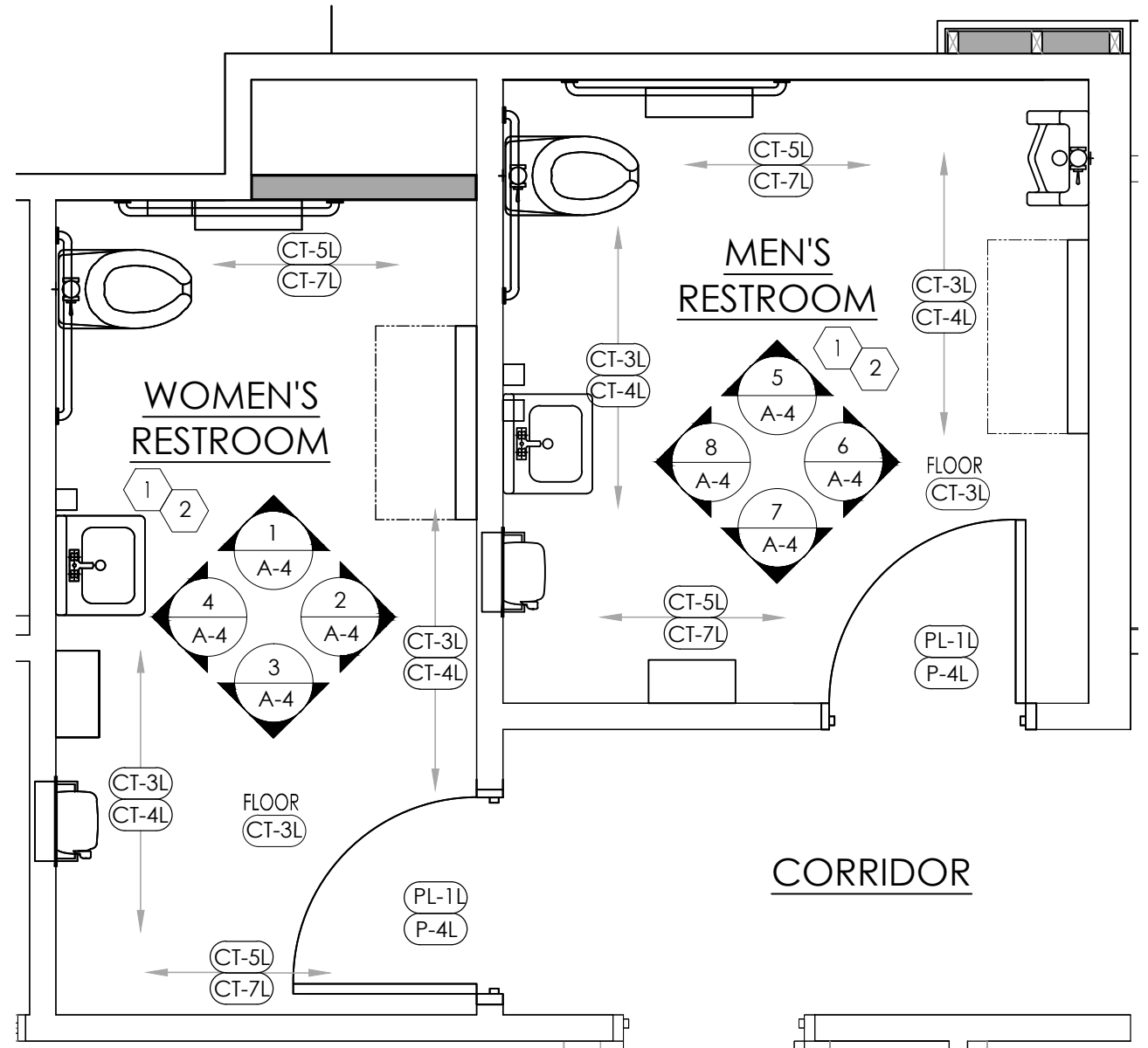

3 FINISH PLAN
SCALE: 1/2" = 1'-0"

FINISH KEY NOTES
1 PATCH WALLS FROM WHERE WALLS WERE REMOVED

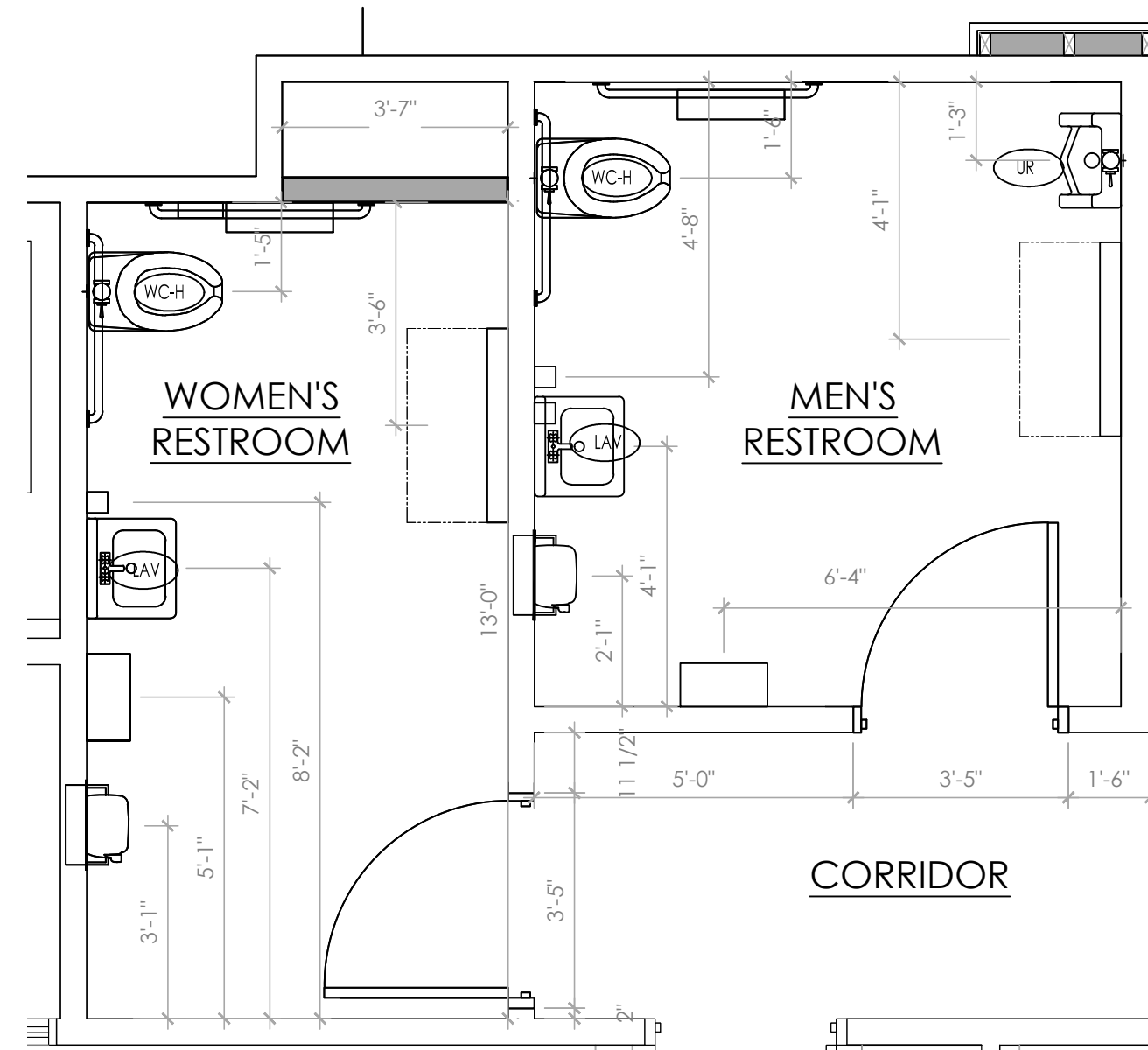

4 PROPOSED DIMENSION PLAN
SCALE: 1/2" = 1'-0"

FINISH SCHEDULE					
MARK	MATERIAL	LOCATION	MANUFACTURER	SPECIFICATION	INFORMATION
CT-3L	CERAMIC TILE	BATHROOMS	DALTILE	TORREON, TN99 COAL 12"x12"	USE W/ GR-3L
CT-4L	CERAMIC TILE	COVE BASE RESTROOMS	DALTILE	TORREON, TN99 COAL 6"x12"	USE W/ GR-3L
CT-5L	CERAMIC TILE	RESTROOMS	DALTILE	SAN MICHELLE, S130 CERMA (CROSS-CUT) 12"x12"	USE W/ GR-4L
CT-7L	CERAMIC TILE	COVE BASE RESTROOMS	DALTILE	SAN MICHELLE, S130 CERMA (CROSS-CUT) 6"x12"	USE W/ GR-4L
CT-8L	CERAMIC TILE	BULLNOSE RESTROOMS	DALTILE	TORREON, TN99 P-36C9T 6"x12"	
GR-3L	GROUT	BATHROOM WALL TILE	CUSTOM BUILDING PRODUCTS	#19 PEWTER POLYBLEND SANDED	
GR-4L	GROUT	BATHROOM WALL TILE	CUSTOM BUILDING PRODUCTS	#101 QUARTZ POLYBLEND SANDED	
P-4L	PAINT	DOOR FRAMES	GUIDDEN	PRIMER: DEVFLEX #4020 PFMMASTER PALETTE #10 YY 48/071 DIRECT TO METAL PRIMER & FLAT FINISH DUSTY TRAIL PAINT; LIFEMASTER OILINTERIOR/EXTERIOR SEMI-GLOSS#1506-0110 APPEARS LIKEATRE WPT15 SUPERMATTE #0TEBK FINISH IS SUPERMATTE. NO FINISH SUBSTITUTION	MASTER PALETTE #10 YY 30/106 WRIGHT STONE
PL-1L	LAMINATE	INTERIOR DOORS	POINITE		
SS-1	SOLID SURFACE	BATHROOMS	WILSONART	15725L ANTIQUE WHITE 2'x4'	

PLUMBING FIXTURE SCHEDULE								
MARK	FIXTURE	MANUFACTURER	MODEL NUMBER	MODEL NAME	VALVE	SUPPLY PIPING	WASTE PIPING	NOTES
WC-H	WATER CLOSET - ADA	AMERICAN STANDARD	3043.001	MADERA	SLOAN ROYAL #110 ZURN #Z6000AV-HET 1.25GPF	1" CW	4"	2
WC	WATER CLOSET	AMERICAN STANDARD	2234.015	MADERA	SLOAN ROYAL #110 ZURN #Z6000AV-HET 1.25GPF	1" CW	4"	2
UR	URINAL - ADA	AMERICAN STANDARD	6501.010	WASHBROOK	SLOAN ROYAL #186 ZURN #Z6003AV-EWS .50 GPF	1/2" CW	2"	
LAV	LAVATORIES	ZURN	25314.550.1.12.27.5	SOHO	KOHLER K-15598 FAUCET-OR-ZURN #7440-XL FAUCET	1/2" CW	2"	1

NOTES:
1. COMPARABLE FIXTURES BY AMERICAN STANDARD, ELJER AND KOHLER ARE ACCEPTABLE TOILET SEATS TO BE 2. CHURCH 95055C, KOHLER K-4671-C, OLSONITE #10C OR EQUAL.
3. ALL RESTROOMS FIXTURE MUST BE ADA COMPLIANT.

Notes	Submitted to City	Revision 1
By	JW	CG
Date	6/8/16	6/22/16
No.	1	2
Drawn By: PM		
Checked: SB		
Scale: AS NOTED		
Date: 04.01.16		

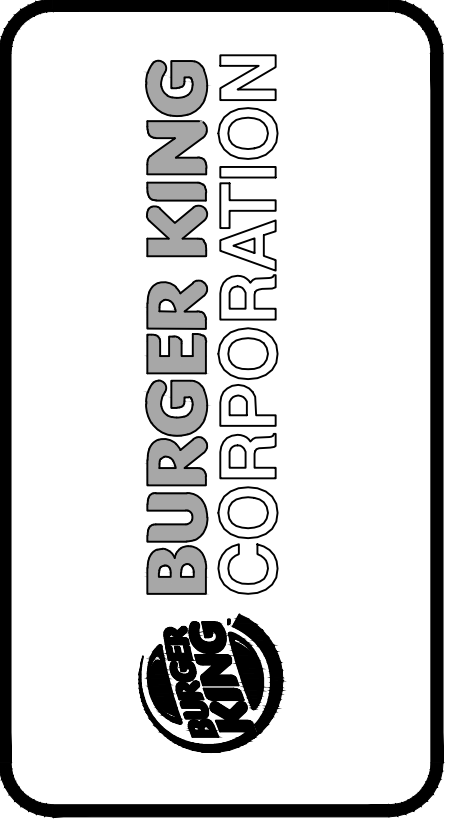

TECHNICAL GROUP, INC.
37716 Hills Tech Drive
Farmington Hills, MI 48331
(248) 426-8000
FAX (248) 426-7004

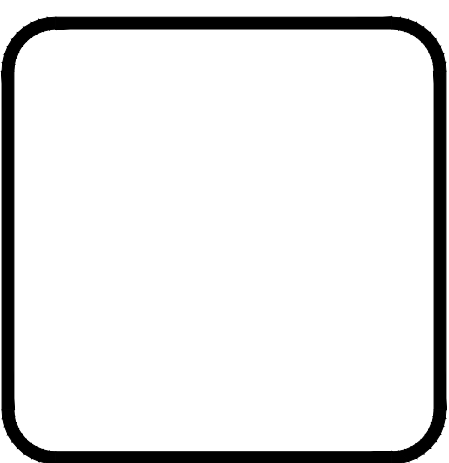

PROJECT
BURGER KING #5743
3100 GRATIOT AVE.
MARYSVILLE, MI

SHEET TITLE
DEMO/PROPOSED
RESTROOM LAYOUTS

DO NOT SCALE THIS PRINT. USE FIGURED DIMENSIONS ONLY.

JOB #
TG-16353

SHEET
A-3