



BURGER KING

BKC # 5763
3100 GRATIOT AVE.
MARYSVILLE, MI 48040

ADAAG/ANSI REQUIREMENTS

PICTURE MENUS

1. SIGNAGE MUST BE PROVIDED AT THE DRIVE UP MENU/ORDER INTERCOM INDICATING PICTURE MENUS AVAILABLE UPON REQUEST AT THE PICK-UP WINDOW.
2. PROVIDE PICTURE MENUS AT THE WINDOW AND ORDER COUNTER.

EXTERIOR ACCESSIBLE ROUTES

1. ACCESSIBLE ROUTES ARE REQUIRED TO BE FREE OF ABRUPT CHANGES IN LEVEL GREATER THAN 1/4" IN HEIGHT. ADAAG 206.2.1, 206.2.2, 403.4, 303. ANSI 302.1
2. ACCESSIBLE ROUTES ARE REQUIRED TO BE FREE OF GAPS GREATER THAN 1/2" WIDE. ADAAG 206.2.1, 206.2.2, 403.2, 302.3. ANSI 303.2
3. ALL PEDESTRIAN PATHS ARE REQUIRED TO BE FREE OF OBJECTS PROTRUDING MORE THAN 4" (12" IF POST MOUNTED SUCH AS SIGNAGE) HORIZONTALLY, BETWEEN 17" AND 80" HIGH. ADAAG 307.2, ANSI 307.2, 307.3
4. 80" HIGH MINIMUM HEAD CLEARANCE IS REQUIRED ALONG ALL PEDESTRIAN PATHS. ADAAG 307.4 ANSI 307.4
5. ALL ACCESSIBLE PATHS TO BE AN AVERAGE SLOPE OF 2% OR LESS IN ANY DIRECTION.

ACCESSIBLE CURB RAMPS

1. SMOOTH TRANSITION BETWEEN THE ROAD AND EVERY CURB RAMP IS REQUIRED. ADAAG 406.2, ANSI 405.9.2
2. DETECTABLE WARNINGS ON CURB RAMPS MUST CONTRAST VISUALLY WITH THE ADJOINING SURFACES. ADAAG 705.1 ANSI 406.14

ENTRY DOORS

1. ENTRY DOOR IS REQUIRED TO HAVE ISA DECAL. ADAAG 216.6, 703.5 ANSI 703.2.9
2. ALL OPENING HARDWARE IS TO BE OPERATED WITH A CLOSED FIST. ADAAG 404.2.7 ANSI 404.2.6
3. DOOR CLOSING SPEED IS TO BE 5 SECONDS OR MORE FROM 90 DEGREES TO 12 DEGREES FROM THE LATCH FOR ALL LEAVES OF THIS DOORWAY. ADAAG 404.2.8.1 ANSI 404.2.7.1
4. THRESHOLD HEIGHT HEIGHT MAY NOT EXCEED 1/2" MAXIMUM. ADAAG 404.2.5 ANSI 404.2.4
5. ENTRY THRESHOLDS MUST NOT HAVE ABRUPT PORTIONS THAT ARE 1/4" HIGH MAXIMUM. ADAAG 404.2.5 ANSI 404.2.4
6. THE ENTRY THRESHOLD MUST HAVE A 1/2" MAXIMUM BEVEL FOR ANY PORTION THAT IS MORE THAN 1/4" HIGH. ADAAG 404.2.5 ANSI 303.3
7. REQUIRED MANEUVERING SPACE IS REQUIRED ON EACH SIDE OF THE DOOR SLOPED 2% OR LESS IN ALL DIRECTIONS. ADAAG 404.2.4 ANSI 404.2.3.5

SERVICE COUNTER

1. THE HEIGHT OF THE ACCESSIBLE ORDER COUNTER SHALL NOT EXCEED 34" MAXIMUM. ADAAG 902.3, (PREFERRED 33 1/2") ANSI 904.4.2
2. THE WIDTH OF THE ACCESSIBLE ORDER COUNTER SHALL NOT BE LESS THAN 36" MINIMUM. ADAAG 902.3 ANSI 904.3
3. THE HEIGHT OF THE ACCESSIBLE PICK-UP COUNTER SHALL NOT EXCEED 34" MAXIMUM. ADAAG 902.3 ANSI 904.4.2
4. THE WIDTH OF THE ACCESSIBLE PICK-UP COUNTER SHALL NOT BE LESS THAN 36" MINIMUM. ADAAG 902.3 ANSI 904.3
5. THE CREDIT CARD READER SHALL BE IN REACH OR ON A CORD LONG ENOUGH TO REACH THE LAP OF A CUSTOMER WHO USES A WHEELCHAIR. ADAAG 308 ANSI 902.3
6. THE SIGNATURE PAD WRITING SURFACE IS REQUIRED TO BE 34" AFF MAXIMUM OR ON A CORD LONG ENOUGH TO REACH THE LAP OF A CUSTOMER WHOSE USES A WHEELCHAIR. ADAAG 902.4 ANSI 902.3

SELF SERVICE CONDIMENTS AND DRINKS COUNTER

1. IT IS REQUIRED TO HAVE AT LEAST ONE OF EACH CONTAINER, UTENSIL OR CONDIMENT LOCATED WITHIN 48" MAXIMUM AFF OR 46" MAXIMUM AFF FOR DEPTHS FROM 10" TO 24". ADAAG 308 ANSI 308
2. IT IS REQUIRED TO HAVE AT LEAST ONE OF EACH TYPE OF DRINK DISPENSER LOCATED WITHIN 48" MAXIMUM AFF OR 46" MAXIMUM AFF FOR DEPTHS FROM 10" TO 24". ADAAG 308 ANSI 308
3. THE TOP OF EACH SELF SERVICE COUNTER OR TRAY SLIDE IS NOT TO EXCEED 34" MAXIMUM AFF. ADAAG 902.3. (PREFERRED 33 1/2") ANSI 904.5.2
4. THE CONTROL OF EVERY DISPENSER IS REQUIRED TO BE OPERABLE WITH A CLOSED FIST OR FLAIL HAND. ADAAG 309.4 ANSI 309.4

INTERIOR ACCESSIBLE SEATING AND TABLES

1. IT IS REQUIRED TO HAVE A 36" WIDE MINIMUM ACCESSIBLE ROUTE SERVING EVERY ACCESSIBLE SEATING LOCATION. ADAAG 403 ANSI 403
2. THE HEIGHT OF THE TABLE TOP IS REQUIRED TO BE BETWEEN 28" AND 34" MAXIMUM AT EVERY ACCESSIBLE SEATING POSITION. ADAAG 902.3 ANSI 902.3
3. KNEE CLEARANCE OF 27" HIGH BY 30" WIDE BY 17" DEEP IS TO BE PROVIDED AT EVERY ACCESSIBLE SEATING POSITION. ADAAG 902.2 ANSI 902.2

ADAAG/ANSI REQUIREMENTS

INTERIOR ACCESSIBLE ROUTES AND ELEMENTS

1. ALL ACCESSIBLE ROUTES ARE REQUIRED TO BE STABLE, FIRM AND SLIP RESISTANT. ADAAG 206.2.4, 302.1, ANSI 302.1
2. ACCESSIBLE ROUTES ARE REQUIRED TO BE FREE OF ABRUPT CHANGES IN LEVEL GREATER THAN 1/4" IN HEIGHT. ADAAG 206.2.4, 403.4, 303. ANSI 303.2
3. ACCESSIBLE ROUTES ARE REQUIRED TO BE FREE OF GAPS GREATER THAN 1/2" WIDE. ADAAG 206.2.4, 403.2, 302.3. ANSI 302.3
4. ACCESSIBLE ROUTES ARE TO HAVE RUNNING SLOPES 5% OR LESS. ADAAG 206.2.4, 403.3. ANSI 405.2
5. ACCESSIBLE ROUTES ARE TO HAVE CROSS SLOPES 2% OR LESS. ADAAG 206.2.4, 403.3 ANSI 405.3

PROTRUDING OBJECTS

1. ALL PEDESTRIAN PATHS ARE TO BE FREE OF OBJECTS PROTRUDING MORE THAN 4" (12" IF POST MOUNTED SUCH AS SIGNAGE) HORIZONTALLY, BETWEEN 27" AND 80" HIGH. ADAAG 307.2 ANSI 307.3
2. IT IS REQUIRED TO HAVE 80" MINIMUM HEAD CLEARANCE ALONG ALL PEDESTRIAN PATHS. ADAAG 307.4 ANSI 307.4

RESTROOMS

1. A SIGN MUST BE LOCATED OUT OF THE SWING OF ANY DOOR AT THE LATCH SIDE OF THE RESTROOM DOOR. ADAAG 703.4.2 ANSI 703.3.1.1
2. THE RESTROOM SIGN MUST HAVE TACTILE CHARACTERS THAT ARE RAISED AT LEAST 1/8". ADAAG 703.2.1 ANSI 703.2.4, 703.2.9
3. THE RESTROOM SIGN MUST HAVE TACTILE CHARACTERS WITH HEIGHT BETWEEN 5/8" AND 2" ADAAG 703.2.5 ANSI 703.2.4 TABLE 703.2.4
4. THE RESTROOM SIGN WILL HAVE THE LOWEST TACTILE CHARACTER 48" MIN. AND THE BASELINE OF THE HIGHEST TACTILE CHARACTER 60" MAX. ADAAG 703.4.1 ANSI 703.3.1.0
5. THE RESTROOM SIGN MUST HAVE BRAILLE. ADAAG 703.3 ANSI 703.3, 703.4
6. THE RESTROOM SIGN MUST BE NON GLARE AND THE CHARACTERS MUST CONTRAST WITH THE BACKGROUND. ADAAG 703.5.1 ANSI 703.5.3
7. THE FLOOR SURFACES IN THE RESTROOM CANNOT BE SLOPED GREATER THAN 2% IN ALL DIRECTIONS WITH NO ABRUPT CHANGE IN LEVEL GREATER THAN 1/2" HIGH AND NO GAPS GREATER THAN 1/2" WIDE. ADAAG 206.2.4, 302.3, 303, 403.2, 403.3, 403.4. ANSI 302.2, 303.3, 403.3
8. ALL OPENING HARDWARE CAN BE OPERATED WITH A CLOSED FIST OR A FLAIL HAND. ADAAG 404.2.7 ANSI 404.2.6
9. OPENING FORCE FOR ALL ACCESSIBLE INTERIOR AND EXTERIOR DOORS WILL NOT EXCEED 5 LBF. ADAAG 404.2.9 ANSI 404.2.8
10. DOOR CLOSING SPEED WILL BE 5 SECONDS OR MORE FROM 90 DEGREES TO 12 DEGREES FROM THE LATCH FOR ALL LEAVES OF THIS DOORWAY. ADAAG 404.2.8.1 ANSI 404.2.7.1
11. THRESHOLDS FOR DOORS WILL NOT HAVE AN OVERALL HEIGHT GREATER THAN 1/2" MAX. OR HAVE ABRUPT PORTIONS THAT ARE 1/2" HIGH MAX. THE THRESHOLD MAY HAVE A 1:2 MAX BEVEL FOR ANY PORTION THAT IS GREATER THAN 1/2" HIGH. ADAAG 404.2.5 ANSI 404.2.4
12. THE REQUIRED MANEUVERING SPACES ON EACH SIDE OF THE DOOR MAY BE SLOPED 2% OR LESS IN ALL DIRECTIONS. ADAAG 404.2.4 ANSI 303.2
13. ALL ACCESSIBLE LAVATORY PIPES MUST BE INSULATED OR OTHERWISE PROTECTED FROM CONTACT. ADAAG 213.3.4, 606.5 ANSI 606.6
14. THE FAUCET HARDWARE AT THE ACCESSIBLE LAVATORY MUST BE AUTOMATIC OR OPERABLE WITH A CLOSED FIST OR FLAIL HAND. ADAAG 213.3.4, 606.4 ANSI 606.4
15. THE DIAPER CHANGING STATION MUST BE ON AN ACCESSIBLE ROUTE WITH AN ACCESSIBLE CLEAR FLOOR SPACE. ADAAG 305, 902.1, 902.2 ANSI 308
16. ACCESSIBLE DISPENSERS MUST BE OPERABLE WITHOUT PINCHING, GRASPING OR TWISTING OF THE WRIST AND REQUIRE 5 LBF OR LESS TO OPERATE. ADAAG 205, 309.4 ANSI 309.4
17. A HORIZONTAL REAR WALL GRAB BAR MUST BE PROVIDED THAT IS 1 1/2" TO 1/2" IN DIAMETER, 36" LONG MIN. EXTENDING 12" MIN FROM THE TOILET CENTERLINE TOWARDS THE NEAR SIDE WALL, CENTERED 33" TO 36" ABOVE THE FLOOR TO THE TOP OF THE GRIPPING SURFACE AND WITH NO OBSTRUCTIONS WITHIN 12" ABOVE OR 1 1/2" BELOW THE BAR. ADAAG 604.5.2, 609 ANSI 604.1, 604.5.2, 609
18. THE URINALS FLUSH CONTROL MUST BE AUTOMATIC OR 48" HIGH MAX AND BE OPERABLE WITH NO MORE THAN 5 LBF OF PRESSURE. ADAAG 605.4 ANSI 604.6
20. GRAB BARS AT THE SIDE SHALL BE AT LEAST 42" LONG POSITIONED NO MORE THAN 12" FROM THE REAR WALL. GRAB BARS AT THE BACK SHALL BE NOT LESS THAN 36" LONG. VERTICAL GRAB BARS TO BE 18" IN LENGTH AND 39-41" AFF AND 39-41" FROM REAR WALL (IBC 1607.7 & ANSI 604.8.4.1) (ICC/ANSI A117.1-2003 FIG. 604.5.1) ANSI 604.5.1, 609.4

NOTICE TO BIDDERS

THE "GENERAL CONTRACTOR," ITS "SUBCONTRACTORS," AND "VENDORS" SHALL REVIEW THE PROPOSED SITE FOR BIDDING PURPOSES AND TO FAMILIARIZE THEMSELVES WITH THE EXISTING CONDITIONS OF THE SITE AND PROPOSED SPACE. ANY DISCREPANCIES BETWEEN THE CONSTRUCTION DOCUMENTS (DRAWINGS AND PROJECT MANUAL) AND EXISTING CONDITIONS SHALL BE SUBMITTED IN WRITING TO THE "ARCHITECT" AND OWNER BY THE "GENERAL CONTRACTOR" FOR CLARIFICATION. BY FAILURE TO CLARIFY DISCREPANCIES, GC SHALL BEAR RISK AND COST, AT NO CHARGE TO OWNER TO RECTIFY.

GC AND VENDOR TO CHECK WEBSITE AND CALL/EMAIL ARCHITECT IN REGARDS TO MOST RECENT DRAWINGS BEFORE ORDERING, MANUFACTURING, AND GOING TO SITE.

CODE INFORMATION

PROJECT SCOPE: REMODEL OF EXISTING BURGER KING RESTAURANT

APPLICABLE CODES: 2012 MICHIGAN BUILDING CODE
2012 MICHIGAN PLUMBING CODE
2011 NEC PART B
ICC ANSI 117.1-2009
2009 MICHIGAN UNIFORM ENERGY

OCCUPANCY TYPE: A-2: ASSEMBLY (UNSPRINKLED)

CONSTRUCTION TYPE: V-8; WOOD FRAME

PROPOSED OCCUPANCY LOAD CALCULATIONS:

TOTAL AREA OF BUILDING: 3250 SF

EXISTING SEAT COUNT: 86

PROPOSED SEAT COUNT: 86

NUMBER OF EMPLOYEES (INCLUDING OWNERS AND MANAGERS): 6

TOTAL: 92

RESTROOM PLUMBING FIXTURES

FROM 2012 MBC, TABLE 2902.1

BUILDING OCCUPANCY CALCULATION (FROM TABLE 1004.1.1):
MAXIMUM OCCUPANTS (GREATEST OF OCCUP. CALCULATION OR SEAT COUNT NUMBERS) = 92
50% MALE AND 50% FEMALE = 92/2 = 46 EACH
46/75 = .61
51 WC EACH RESTROOM. (TABLE 2902.1)
46/200 = .230 = 1 LAV EACH RESTROOM. (TABLE 2902.1)

REQUIRED	MEN		WOMEN		PROVIDED
W.C. (1:75)	1	1	W.C.	1	1
URINAL*	-	-	URINAL	1	-
LAVATORY (1:200)	1	1	LAVATORY	1	1

PROJECT DATA

PROJECT LOCATION:	OWNER & CONTACT:	ARCHITECT/ ENGINEER:
BURGER KING #5763 3100 GRATIOT AVE. MARYSVILLE, MI 48040	TIMOTHY CLAYTON E: TMTHYCLYTN@YAHOO.COM	TECHNICAL GROUP, INC. 37716 HILLS TECH DR FARMINGTON HILLS, MI 48331
		P:(248)426-8000

LOCAL AUTHORITIES

MACOMB COUNTY
BUILDING DEPARTMENT
1111 DELAWARE AVE.
MARYSVILLE, MI 48040
P: 810.364.6613 EXT. 1381
F: 810.364.2824

VICINITY MAP (N.T.S.)

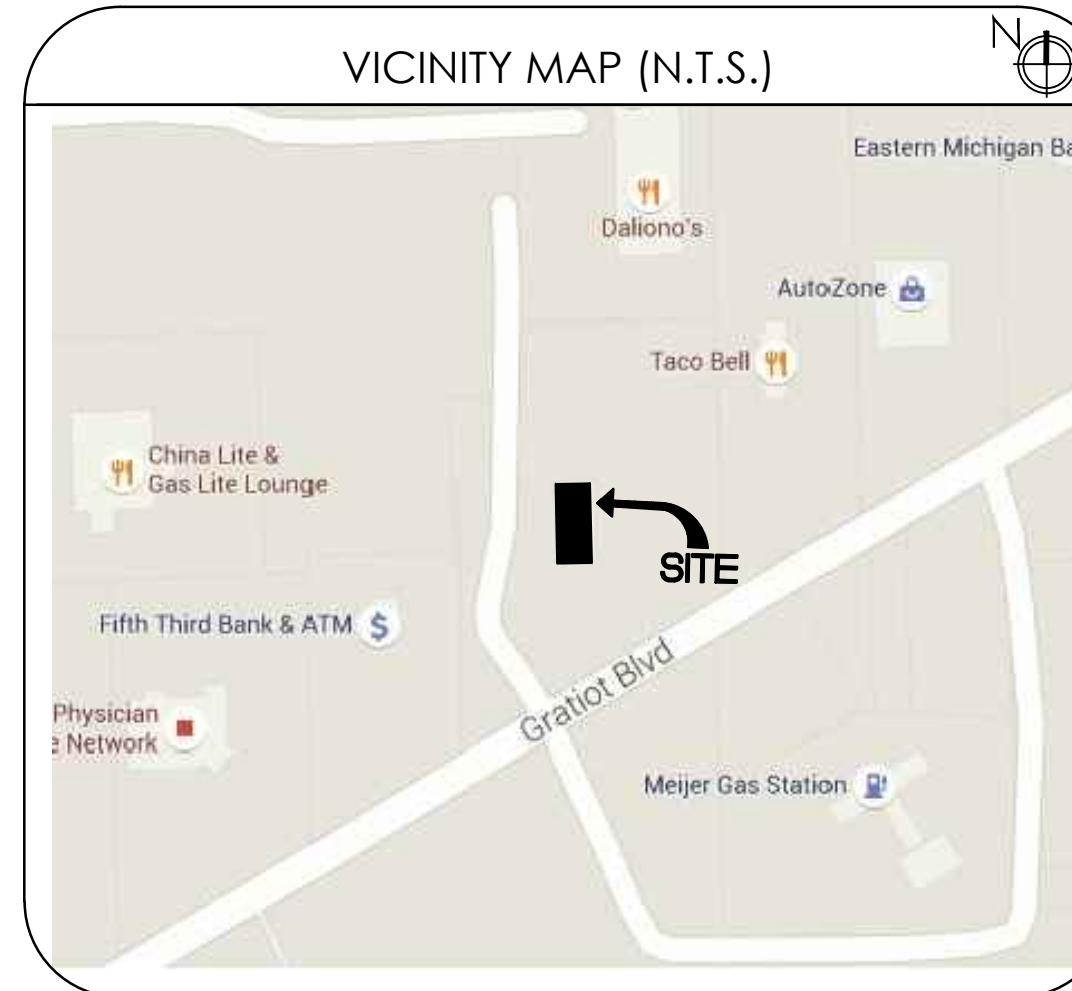

SHEET INDEX

SHEET #	SHEET TITLE
T-1	TITLE SHEET
CIVIL	
C-1	DEMO SITE PLAN
C-2	PROPOSED SITE PLAN
C-3	SITE DETAILS
ARCHITECTURAL	
D-1	DEMOLITION PLAN
D-2	DEMO EXTERIOR ELEVATIONS
A-1	PROPOSED FLOOR PLAN & DOOR SCHEDULE
A-1.1	DOOR, WINDOW SCHEDULE
A-2	PROPOSED EXTERIOR ELEVATIONS
A-3	DEMO & PROPOSED RESTROOM LAYOUTS
A-4	PROPOSED RESTROOM ELEVATIONS & DETAILS
A-5	REFLECTED CEILING PLAN
A-6	WALL SECTIONS & DETAILS
A-7	MANUFACTURERS & SUPPLIERS

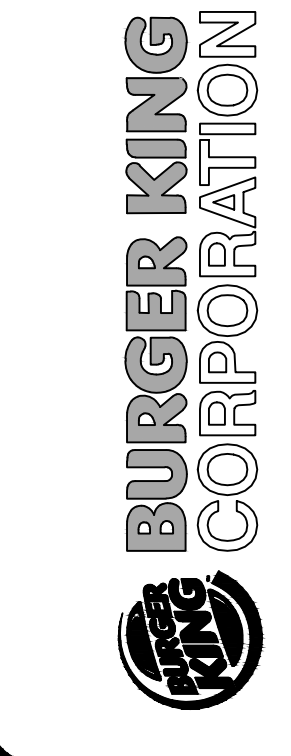

TECHNICAL GROUP, INC.
37716 Hills Tech Drive
Farmington Hills, MI 48331
(248) 426-8000
FAX (248) 426-7004

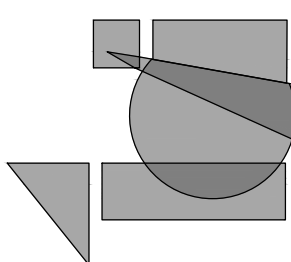

PROJECT
BURGER KING #5763
3100 GRATIOT AVE.
MARYSVILLE, MI

SHEET TITLE
TITLE SHEET

DO NOT SCALE THIS PRINT. USE FIGURED DIMENSIONS ONLY.

JOB #

TG-16353

SHEET

T-1

No.	Date	By	Notes
1	6.8.16	JW	SUBMITTED TO CITY
2	6.22.16	CG	REVISION 1

Drawn By: PM
Checked: SB
Scale: AS NOTED
Date: 04.01.16

ALL RIGHTS RESERVED. NO PART OF THESE DRAWINGS OR SPECIFICATIONS MAY BE COPIED, REPRODUCED OR USED IN CONNECTION WITH ANY WORK OTHER THAN THE SPECIFIC PROJECT FOR WHICH THEY HAVE BEEN PREPARED, WITHOUT PRIOR WRITTEN AUTHORIZATION FROM THE ARCHITECT.